

TYPICAL STREET SECTION

NOTE:
 B618 CONCRETE CURB AND GUTTER SHALL BE PLACED AROUND AND AT STORM SEWER STRUCTURES.

RECORD DRAWING - JANUARY 2004

DATE: 3/21/05 LICENSE NO. 115146

HEREBY CERTIFY THAT THIS PLAN, SPECIFICATIONS, AND CONDITIONS PREPARED BY ME OR UNDER MY DIRECT SUPERVISION AND THAT I AM A DULY LICENSED PROFESSIONAL ENGINEER UNDER THE LAWS OF THE STATE OF MINNESOTA.

John C. Johnson
 JOHN C. JOHNSON
 DATE: 3/21/05 LICENSE NO. 115146

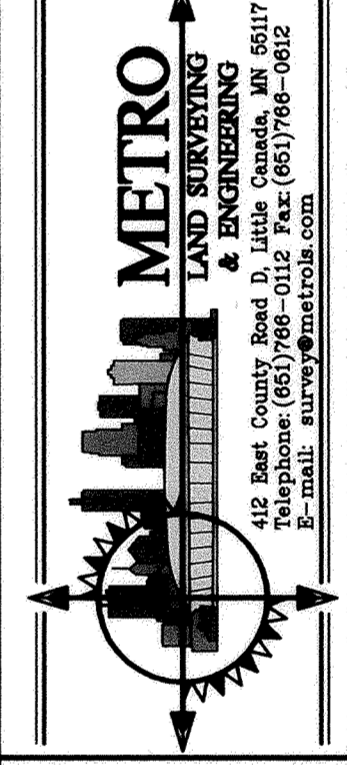

OWNER / DEVELOPER
RIVERSIDE COMPANIES
 19230 EVANS STREET, SUITE 115
 ELK RIVER, MINNESOTA
 PHONE: 763-241-1801

STORM SEWER AND STREET CONSTRUCTION
HILLSIDE ESTATES 9TH ADDITION
 196TH LANE NW
 STA. 0+00 TO 5+00
 CITY OF ELK RIVER, MINNESOTA

DRAWN: GSO
 DATE: 5/12/03
 SCALE: 1"=80'
 PROJECT: R0101.001
 CHECKED: APPROVED:

1