

SDCO PRODUCTS • NEW HOPKINS, MINNESOTA
REVISION BY PART NUMBER 0532

SDCO PRODUCTS • NEW HOPKINS, MINNESOTA
REVISION BY PART NUMBER 0532

SDCO PRODUCTS • NEW HOPKINS, MINNESOTA
REVISION BY PART NUMBER 0532

SDCO PRODUCTS • NEW HOPKINS, MINNESOTA
REVISION BY PART NUMBER 0532

HILLSIDE 8TH FIRST ADDITION BALDWIN CT

SANITARY SEWER, WATERMAIN, STORM SEWER AND STREET CONSTRUCTION

NOTE:
THESE PLANS HAVE BEEN REDUCED TO
APPROXIMATELY 1/2 THEIR ORIGINAL SIZE.
THESE 1/2 SIZE PLANS ARE TO BE USED
FOR BIDDING PURPOSES ONLY.

INDEX

SHEET NO. 1	TITLE SHEET
SHEET NO. 2	LOCATION MAP AND TYPICAL SECTIONS
SHEET NO. 3	REMOVAL PLAN
SHEET NO. 4	PLAN AND PROFILE
SHEET NO. D1-D4	DETAILS

THIS PLAN CONTAINS 8 SHEETS

I HEREBY CERTIFY THAT THIS PLAN, SPECIFICATION,
OR REPORT WAS PREPARED BY ME OR UNDER MY DIRECT
SUPERVISION AND THAT I AM A DULY LICENSED
PROFESSIONAL ENGINEER UNDER THE LAWS OF THE
STATE OF MINNESOTA.

TERRY J. MAURER

DATE _____ LIC.NO. 15316

1326 ENERGY PARK DRIVE
ST. PAUL, MINNESOTA 55108
(651) 644-4389

Howard R Green Company
CONSULTING ENGINEERS

PREPARED FOR:

RIVERSIDE DEVELOPMENT

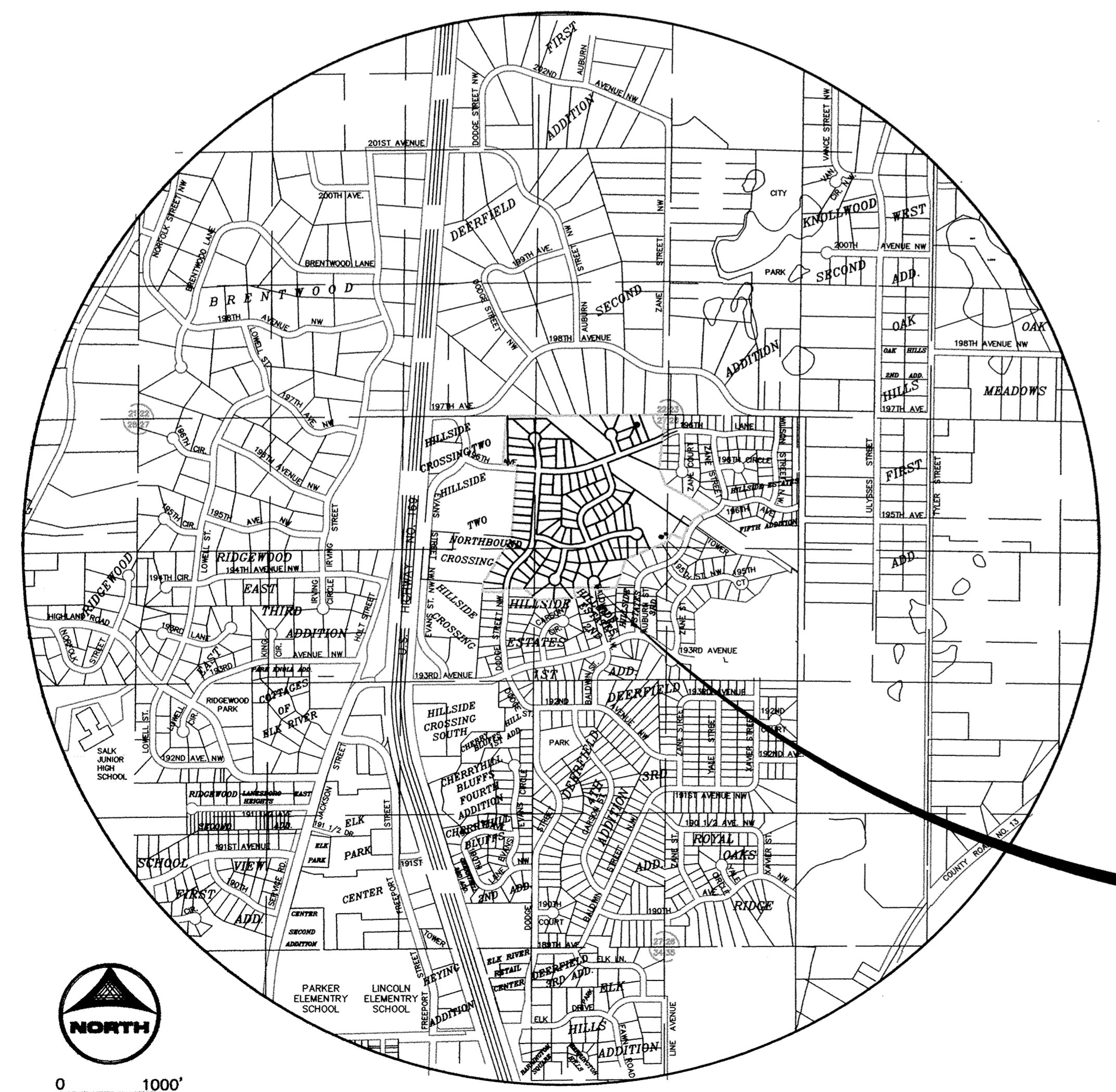
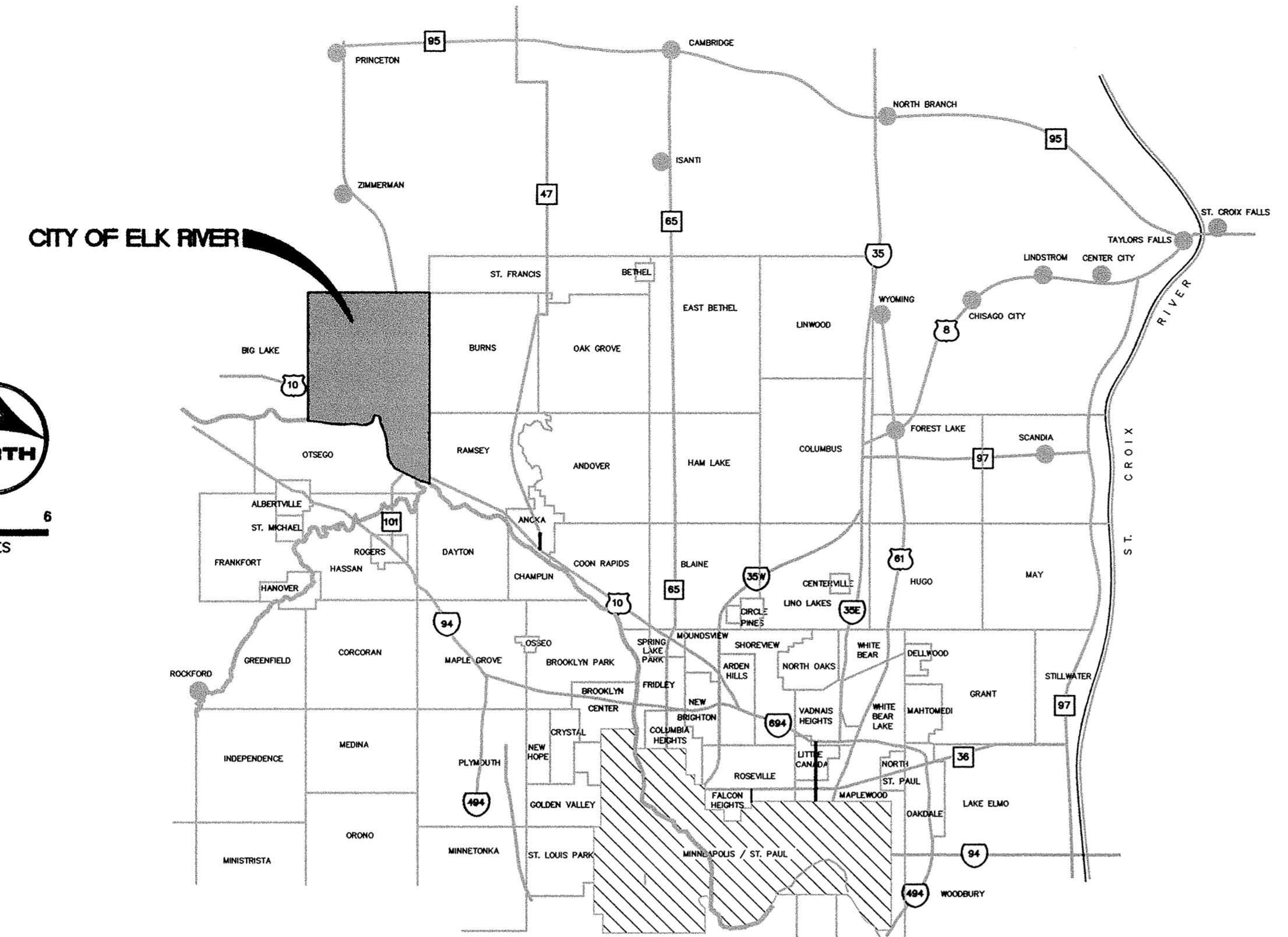

LOCATION MAP

PROJECT LOCATION

**RECORD PLAN
DECEMBER 2002**