

HIGHLAND ROAD

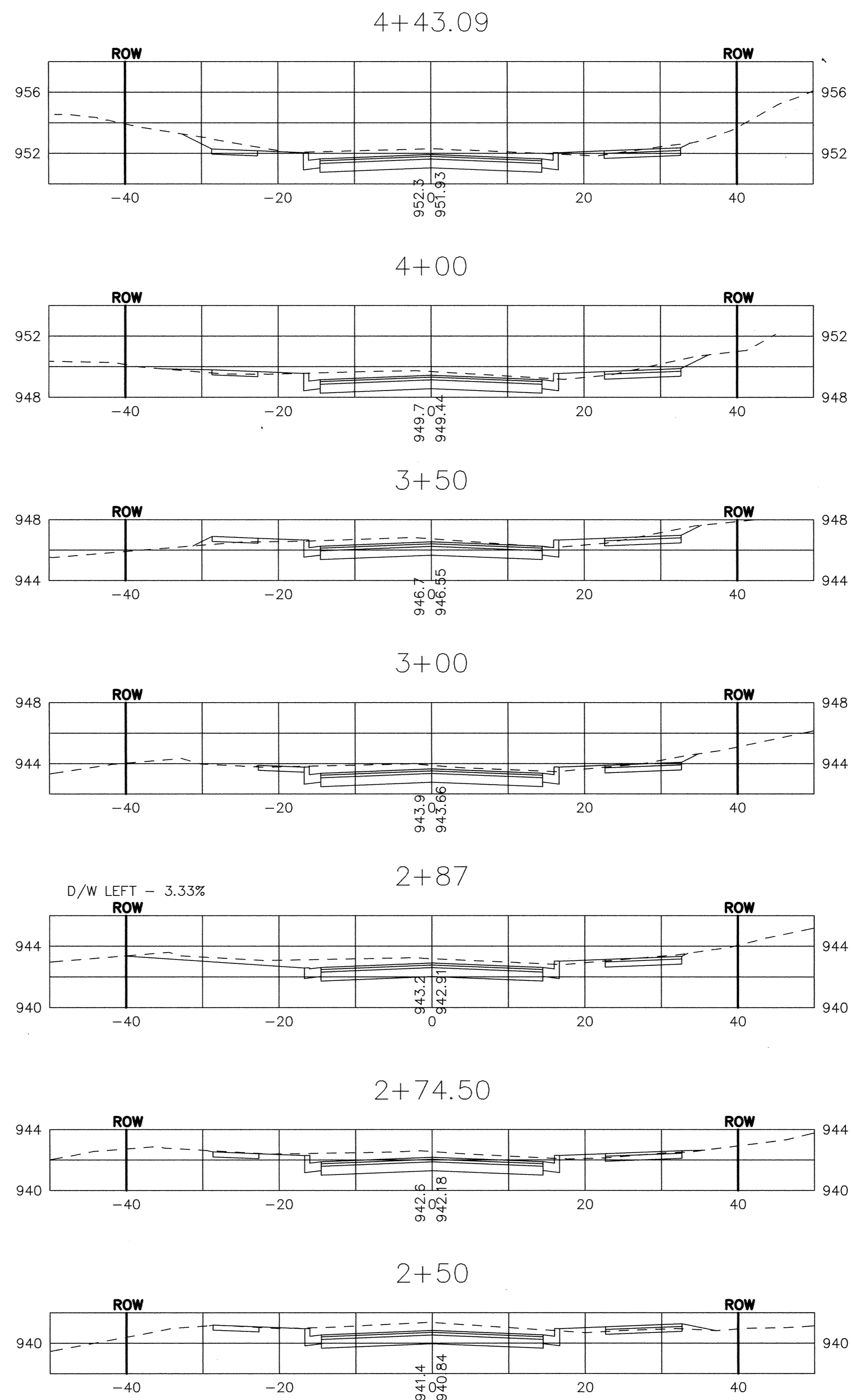
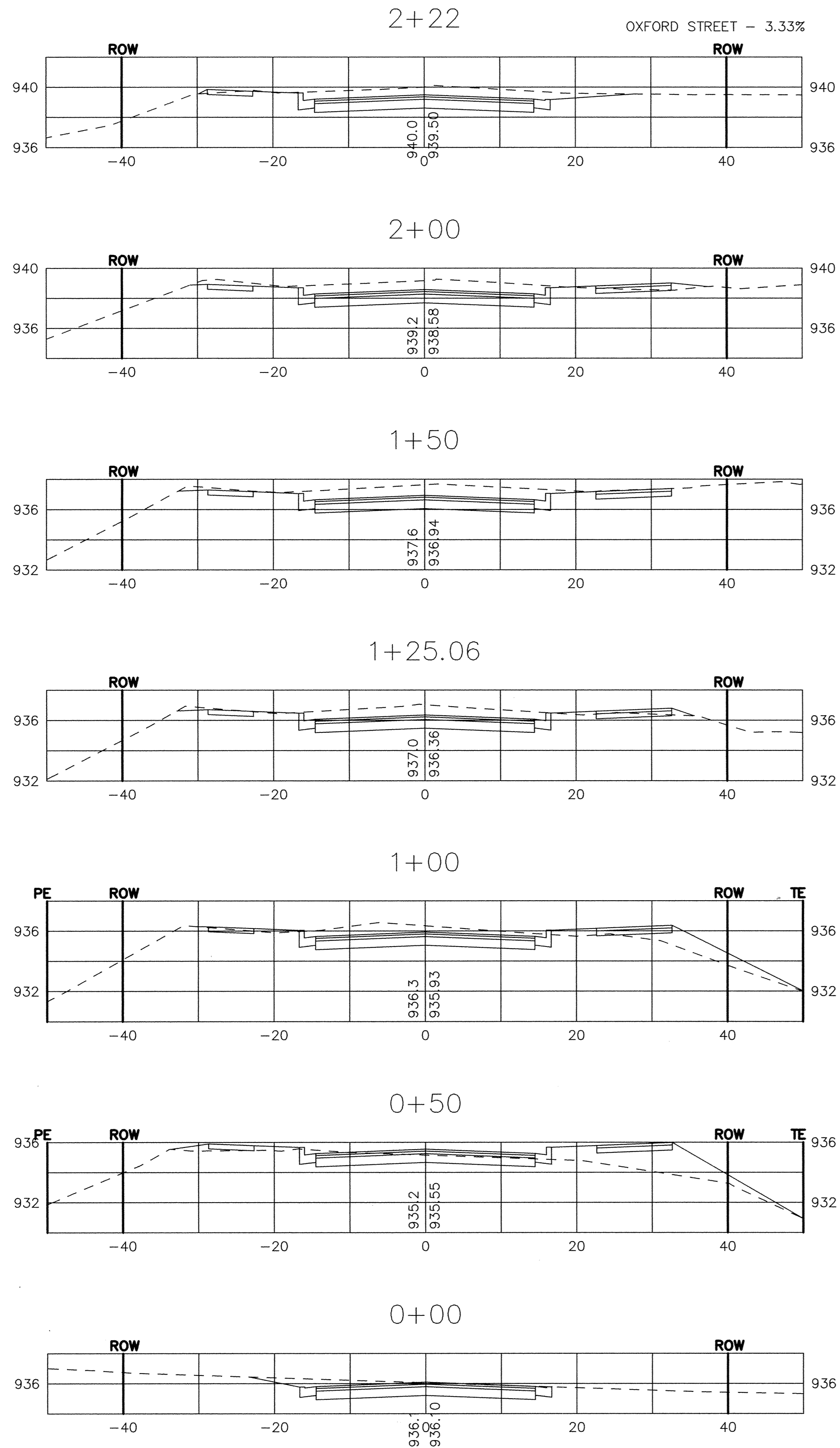

NO.	DATE	BY	DESCRIPTION

I HEREBY CERTIFY THAT THIS PLAN, SPECIFICATION OR REPORT WAS PREPARED BY ME OR UNDER MY DIRECT SUPERVISION AND THAT I AM A DULY LICENSED PROFESSIONAL ENGINEER UNDER THE LAWS OF THE STATE OF MINNESOTA.

DATE 05-02-2006 LIC. NO. 15316

SAP 204-137-001

RECORD PLAN HIGHLAND ROAD IMPROVEMENTS

0+00 TO 4+43

CROSS SECTIONS

BDM
CONSULTING ENGINEERS, PLC
Engineers and Surveyors
4175 Lovell Road, Suite 112
Lexington, MN 55014
Phone: (763) 786-4570
Fax: (763) 786-4574
bdmce.com

DRAWN BY: NAB
CHECKED BY: KJT
DESIGNED BY: KJT
JOB NO. 226068D

SHEET **38** SHEETS **55**

DRAWING NUMBER

DRAWING NUMBER

DRAWING NUMBER

DRAWING NUMBER
HIGHLAND 06
38

SAPCO PRODUCTS • NEW HAVEN, MINNESOTA
REGISTERED BY PART NUMBER 8552