

- NOTES:
- EXISTING LANDSCAPING FEATURES SHALL BE PROTECTED IF NECESSARY, SALVAGING AND REINSTALLING SHALL BE CONSIDERED INCIDENTAL.
  - ALL DRIVEWAYS SHALL BE FULL DEPTH STRAIGHT LINE SAW CUT IMMEDIATELY PROCEEDING PAVING.

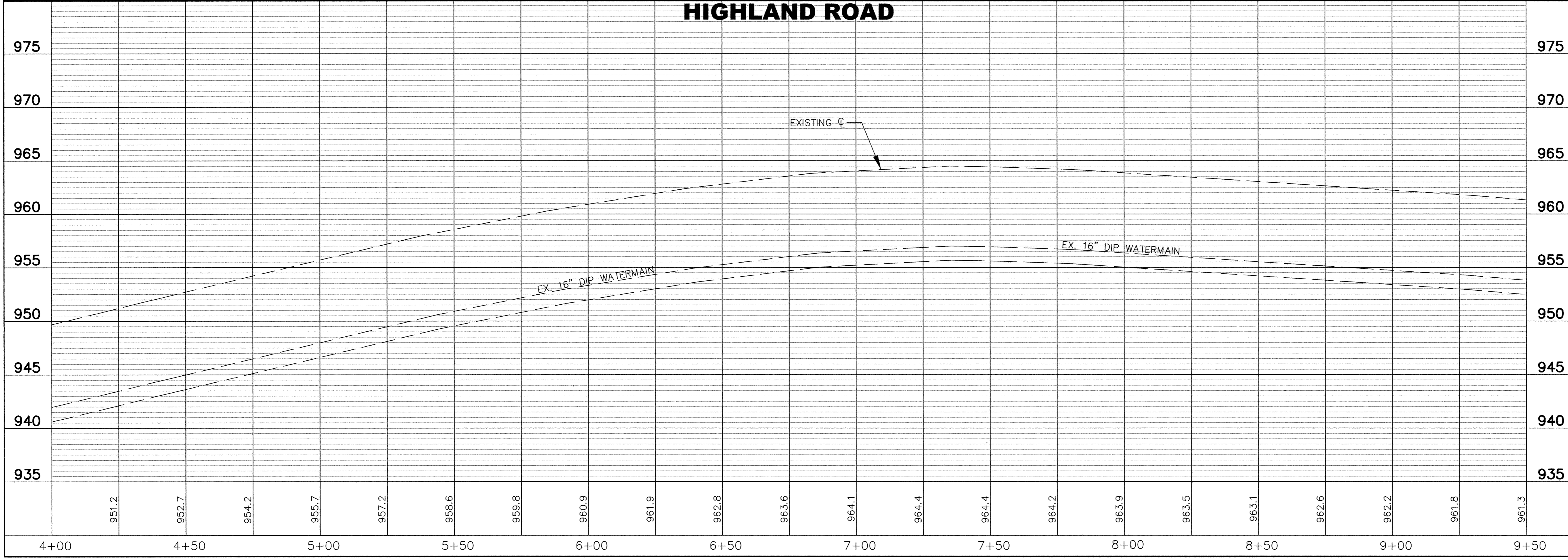
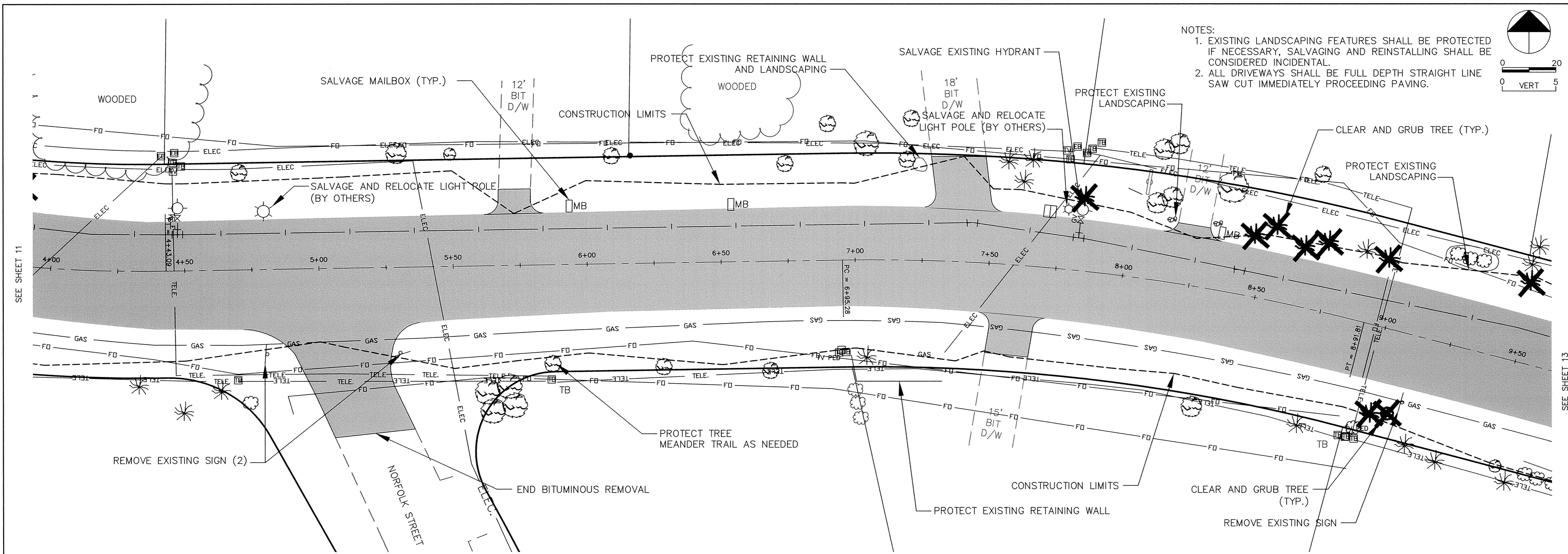

NO.	DATE	BY	DESCRIPTION

I HEREBY CERTIFY THAT THIS PLAN, SPECIFICATION, OR REPORT WAS PREPARED BY ME OR UNDER MY DIRECT SUPERVISION AND THAT I AM A DULY LICENSED PROFESSIONAL ENGINEER UNDER THE LAWS OF THE STATE OF MINNESOTA.

DATE: 05-02-2006  
LIC. NO.: 15316

SAP 204-137-001  
4+50 to 9+00

**RECORD PLAN**  
**HIGHLAND ROAD IMPROVEMENTS**

**REMOVAL PLAN**  
**HIGHLAND ROAD**

**BDM**  
CONSULTING ENGINEERS, PLC  
Engineers and Surveyors  
4175 Lovell Road, Suite 112  
Lexington, MN 55014  
Phone: (763) 786-4570  
Fax: (763) 786-4574  
bdmce.com

DRAWN BY: NAB  
CHECKED BY: KJT  
DESIGNED BY: KJT  
JOB NO. 226068D

SHEET **12** SHEETS **55**