

- NOTES:
- EXISTING LANDSCAPING FEATURES SHALL BE PROTECTED IF NECESSARY, SALVAGING AND REINSTALLING SHALL BE CONSIDERED INCIDENTAL.
 - ALL DRIVEWAYS SHALL BE FULL DEPTH STRAIGHT LINE SAW CUT IMMEDIATELY PRECEEDING PAVING.

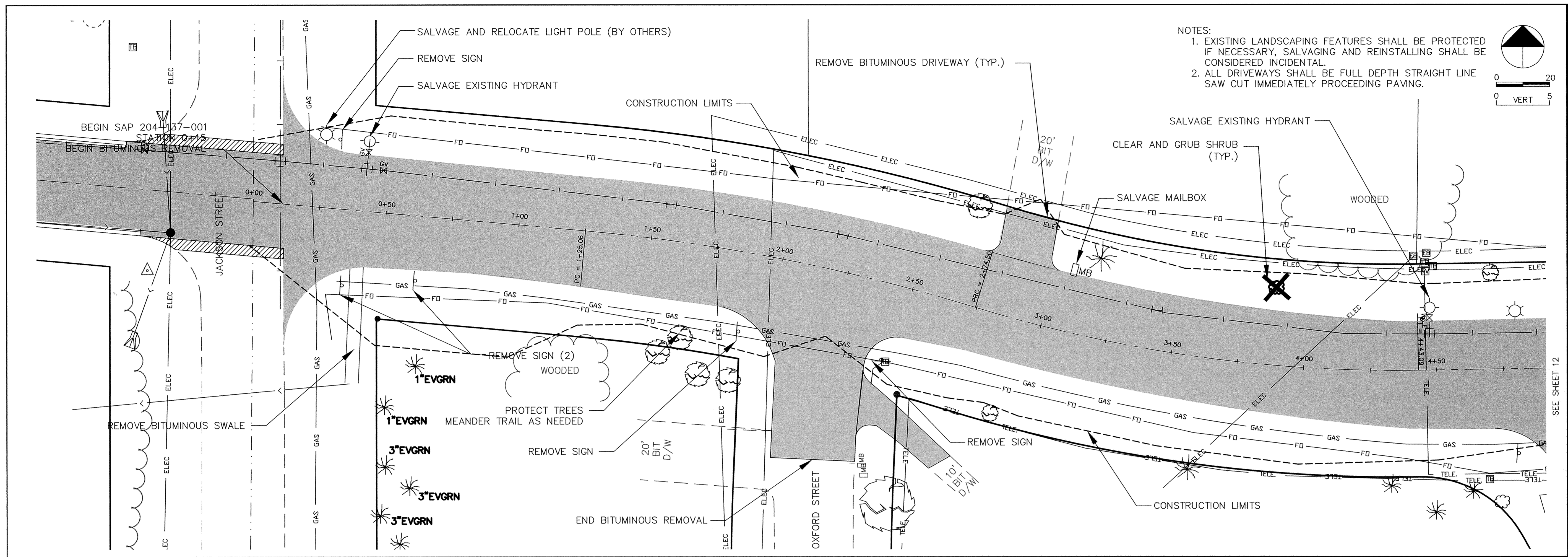

| NO. | DATE | BY | DESCRIPTION |
|-----|------|----|-------------|
| | | | |
| | | | |
| | | | |
| | | | |
| | | | |
| | | | |
| | | | |
| | | | |
| | | | |
| | | | |

I HEREBY CERTIFY THAT THIS PLAN, SPECIFICATION, OR REPORT WAS PREPARED BY ME OR UNDER MY DIRECT SUPERVISION AND THAT I AM A DULY LICENSED PROFESSIONAL ENGINEER UNDER THE LAWS OF THE STATE OF MINNESOTA.

DATE: 05-02-2006 LIC. NO. 15316

SAP 204-137-001

**RECORD PLAN
HIGHLAND ROAD IMPROVEMENTS
REMOVAL PLAN
HIGHLAND ROAD**

DRAWN BY: NAB
CHECKED BY: KJT
DESIGNED BY: KJT
JOB NO. 226068D

SHEET **11** SHEETS **55**

