

PROCTOR ROAD

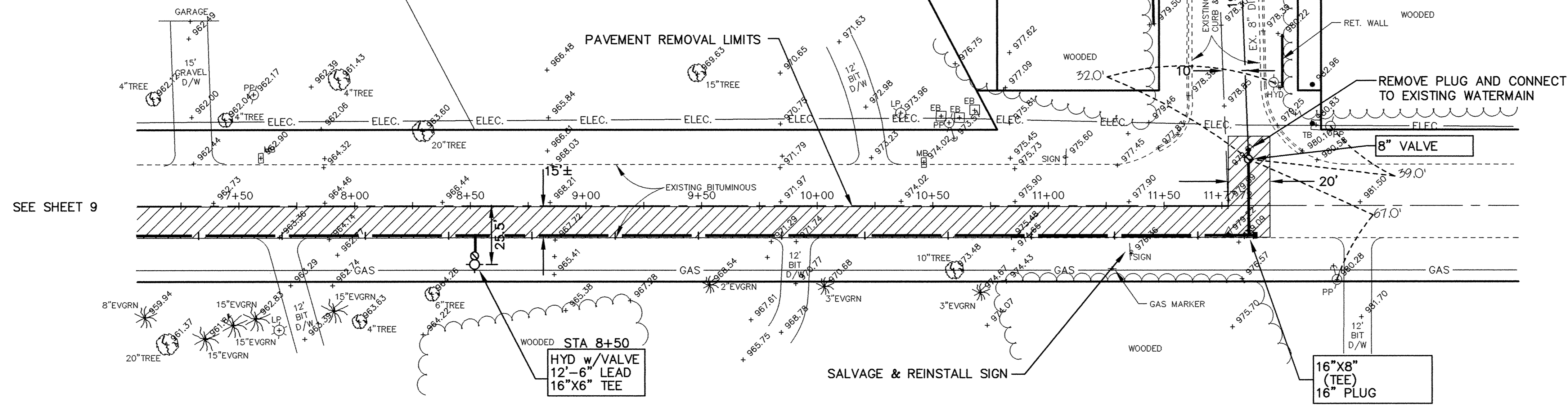

- NOTES:**
- TREES SHALL NOT BE CLEARED AND GRUBBED UNLESS MARKED FOR REMOVAL BY THE ENGINEER.
 - MAIL BOXES SHALL BE TEMPORARILY AND PERMANENTLY RELOCATED AS DIRECTED BY THE ENGINEER.
 - ALL STATIONING REFERS TO R/W CENTERLINE.

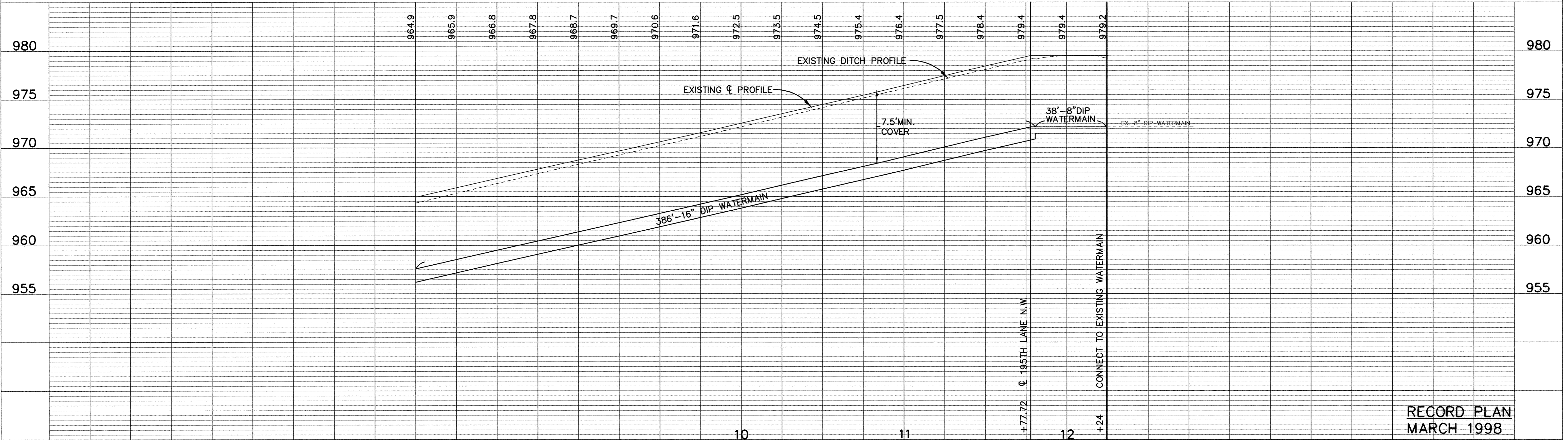
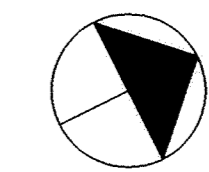

RECORD PLAN
MARCH 1998

I HEREBY CERTIFY THAT THIS PLAN, SPECIFICATION, OR REPORT WAS PREPARED BY ME OR UNDER MY DIRECT SUPERVISION AND THAT I AM A DULY REGISTERED PROFESSIONAL ENGINEER UNDER THE LAWS OF THE STATE OF MINNESOTA. <i>Henry J. Maurer</i> DATE 4/9/97 REG. NO. 15316		1326 ENERGY PARK DRIVE ST. PAUL, MINNESOTA 55108 (612) 644-4389		DATE _____	DESCRIPTION _____	DESIGNED <u>AJB</u> CHECKED _____ DRAWN <u>RKM</u>	ELK RIVER MUNICIPAL UTILITIES HIGHLAND ROAD TRUNK WATERMAIN PROCTOR ROAD 8+00 TO 12+26	DATE APR. 1997	SHEET 10 OF 16 SHEETS	PROJECT NO. 235-013
		REVISIONS _____	GRAPHIC SCALE 0 30 0 VERT. 5	12 90						
		ERU13-11								