

# JOPLIN STREET N.W.

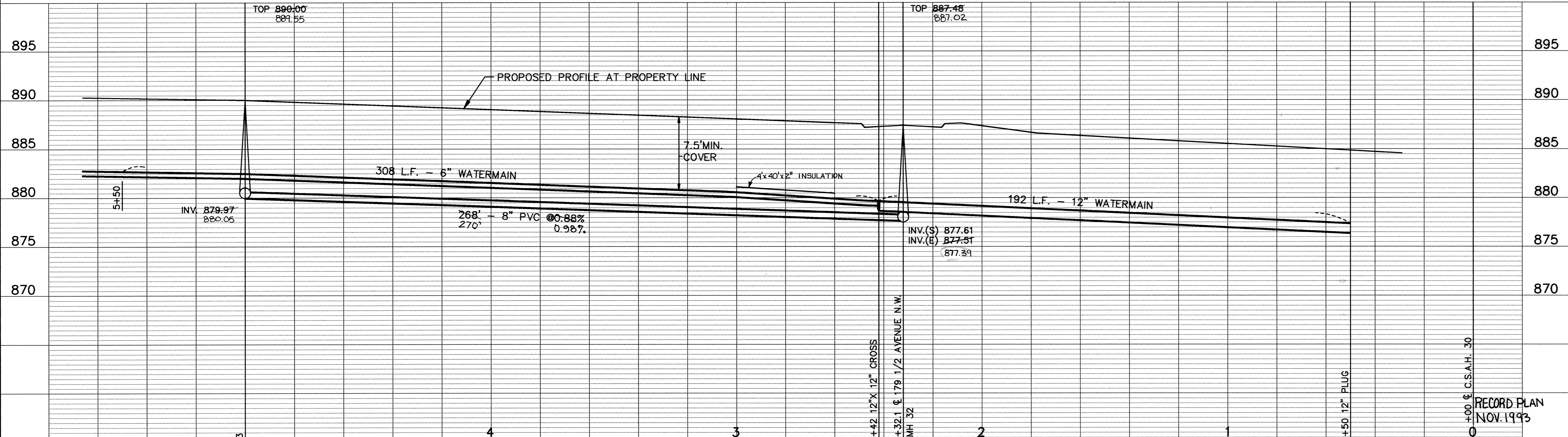
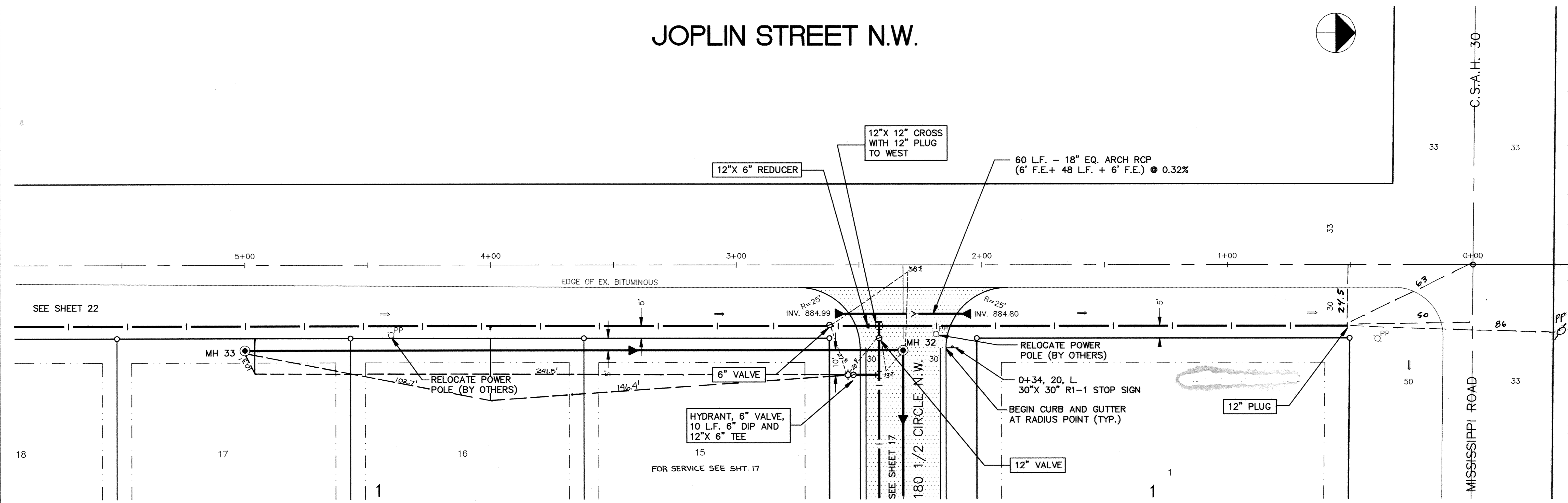
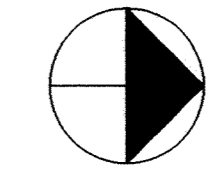

| NO. | DATE | DESCRIPTION |
|-----|------|-------------|
|     |      |             |
|     |      |             |
|     |      |             |

I HEREBY CERTIFY THAT THIS PLAN, SPECIFICATION, OR REPORT WAS PREPARED BY ME OR UNDER MY DIRECT SUPERVISION AND THAT I AM A DULY REGISTERED PROFESSIONAL ENGINEER UNDER THE LAWS OF THE STATE OF MINNESOTA.

*Joseph J. Maier*  
 DATE 4/28/93 REG. NO. 15316

**MS&A** CONSULTING ENGINEERS  
 Maier Stewart & Associates Inc.

1959 SLOAN PLACE (612) 774-6021 ST. PAUL, MINNESOTA 55117  
 9800 SHELARD PARKWAY (612) 546-0432 MINNEAPOLIS, MINNESOTA 55441

| DESIGNED      | GC        |
|---------------|-----------|
| CHECKED       | TJM       |
| DRAWN         | CLS       |
| GRAPHIC SCALE |           |
| 0             | HORIZ. 20 |
| 0             | VERT. 5   |

CITY OF ELK RIVER  
 SANITARY SEWER & WATERMAIN  
 JOPLIN STREET N.W.

DATE APRIL 1993 SHEET 21 OF 28 SHEETS PROJECT NO. 230-159

DRAWING NUMBER  
 HERIT 93  
 21  
 CITY OF ELK RIVER  
 SANITARY SEWER & WATERMAIN  
 JOPLIN STREET N.W.  
 PROJECT NO. 230-159  
 DATE APRIL 1993 SHEET 21 OF 28 SHEETS PROJECT NO. 230-159