

TYPICAL STREET SECTION

NOTE:

B618 CONCRETE CURB AND GUTTER SHALL BE PLACED AROUND ENTRANCE RADII, AT STORM SEWER STRUCTURES, AND AROUND ENTRANCE MEDIAN.

NOTE:

ACCESS MUST BE MAINTAINED TO EXISTING HOUSE IN THE DEVELOPMENT.

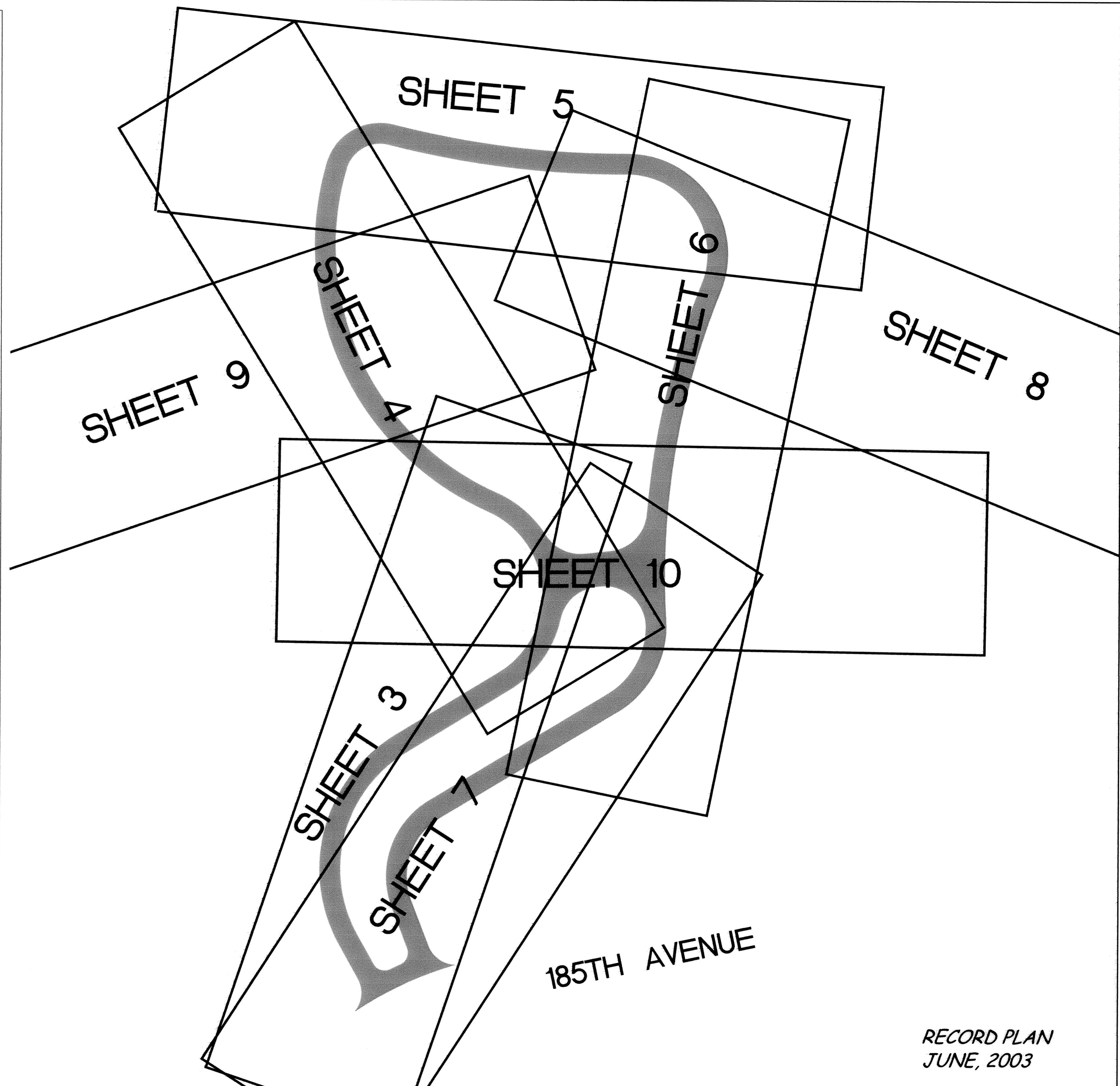

RECORD PLAN
JUNE, 2003

DESIGNED BY: _____ DRAWN BY: LK
 APPROVED BY: _____ JOB NUMBER 810641J
 CAD DATE: January 24, 2005 10:28:32 a.m.
 CAD FILE: 810641J\asbuilts\810641-TYPA.DWG (JCUNNIN)

I HEREBY CERTIFY THAT THIS PLAN, SPECIFICATION, OR REPORT WAS PREPARED BY ME OR UNDER MY DIRECT SUPERVISION AND THAT I AM A DULY LICENSED PROFESSIONAL ENGINEER UNDER THE LAWS OF THE STATE OF MINNESOTA.
 SIGNATURE _____ DATE _____
 PRINTED NAME JOHN M. ANDERSON LIC. NO. 25889

NO.	DATE	BY	REVISION DESCRIPTION

1326 ENERGY PARK DRIVE
 ST. PAUL, MINNESOTA 55108
 (612) 644-4389

 Howard R. Green Company
 CONSULTING ENGINEERS

FOX HAVEN
 CITY OF ELK RIVER

LOCATION MAP AND TYPICAL SECTIONS

SHEET NO.
2