

CITY OF ELK RIVER

M.S.A.S. S.A.P. 204-III-03

FILLMORE STREET IMPROVEMENTS

SECTION I, T32N, R26W
SHERBURNE COUNTY, MINNESOTA

BETWEEN 181ST AVE. (C.R. 12) AND 175TH AVE.
GROSS LENGTH 3964 FEET 0.75 MILES
BRIDGES LENGTH 0 FEET 0 MILES
EXCEPTION LENGTH 0 FEET 0 MILES
NET LENGTH 3964 FEET 0.75 MILES

PLAN 1" = 50'

SCALES: PROFILE HOR. 1" = 50'
VERT. 1" = 5'

CROSS SECTIONS HOR. 1" = 10'
VERT. 1" = 5'

INDEX OF SHEETS

- 1 TITLE SHEET & LAYOUT MAP
- 2 EST. QUANTITY, STREET SECTIONS & NOTES
- 3-6 PLAN & PROFILE
- 7-10 CROSS SECTION
- 11 SIGNING & STRIPING PLAN
- 12 RIGHT-OF-WAY PLAN
- 13 DETAILS

I HEREBY CERTIFY THAT THIS PLAN, SPECIFICATION, OR REPORT WAS PREPARED BY ME OR UNDER MY DIRECT SUPERVISION AND THAT I AM A DULY REGISTERED PROFESSIONAL ENGINEER UNDER THE LAWS OF THE STATE OF MINNESOTA.

Mark V. Graham
DATE 3/29/91 REG. NO. 19130

APPROVED *Terry Mauser* 4/19/91
CITY ENGINEER DATE

RECOMMENDED FOR APPROVAL *David O'Neal* 4-9-91
DISTRICT STATE AID ENGINEER DATE

RECOMMENDED FOR APPROVAL *Julie Stallman* 4/19/91
STATE PLANS & SPEC. ENGINEER DATE

APPROVED *Dennis C. Carlson* 4-19-91
STATE AID DIRECTOR DATE

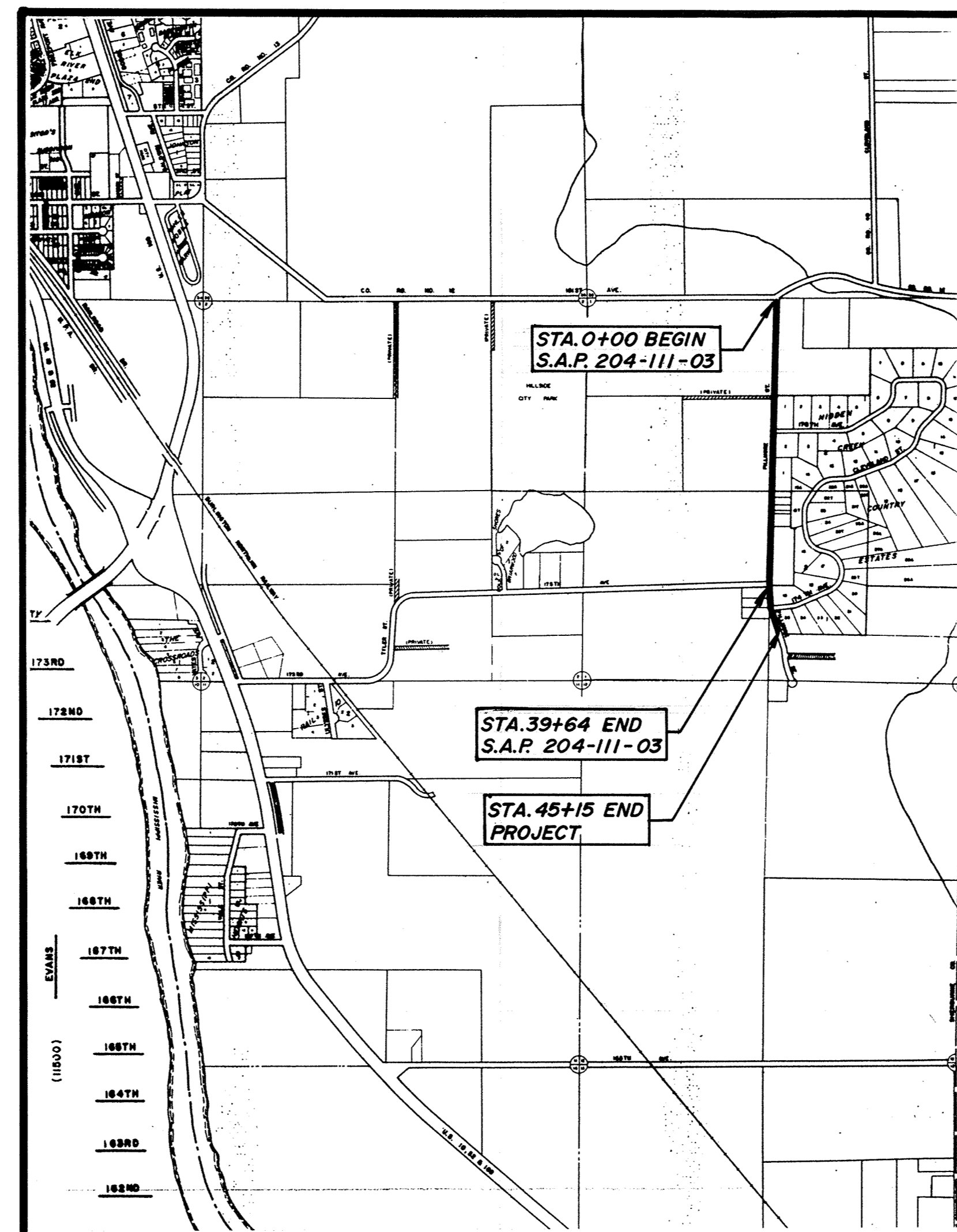

PLAN SYMBOLS

SECTION LINE	-----
QUARTER LINE	-----
SIXTEENTH LINE	-----
RIGHT OF WAY LINE	-----
PROPERTY LINE	-----
CENTER LINE	-----
FENCE LINE	-x-x-
RIVER OR CREEK	~~~~~
LAKE OR POND	~~~~~
CULVERT	-----
BRIDGE	-----
RETAINING WALL	-----

TREES	
BRUSH OR SHRUBS	
HEDGE	
CONIFERS	
SWAMP	
MAILBOX	□
SIGN	+

UTILITIES SYMBOLS

SANITARY SEWER	
STORM SEWER	
WATERMAIN	
GAS LINE	
POWER LINE	
MANHOLE	●
CATCH BASIN	⊕
VALVE	○

HYDRANT	⊙
POWER, TELEPHONE, OR LIGHT POLE	⊕
ANCHOR	⊔
SOIL BORING LOCATION	⊕

FUNCTIONAL CLASSIFICATION LOCAL COLLECTOR

PRESENT ADT (YEAR) 480 (1987) PROJ. ADT (YEAR) 720 (2007)

SHOULDER WIDTH 7 FT.

7 TON - ULT. 9 TON TON DESIGN

SOIL FACTOR 75 PROJ. HCA DT (YEAR) <150 (2007)

R-VALUE NA N OR 18 FACTOR NA

DESIGN SPEED 45 MPH
DESIGN SPEED NOT ACHIEVED AT:
STA. 0+00 TO STA. 1+00 35 MPH - STOP CONDITION

STOPPING SITE DISTANCE BASED ON:
3.5' HEIGHT OF EYE
0.5' HEIGHT OF OBJECT

PREPARED BY:

MSA CONSULTING ENGINEERS
Maier Stewart & Associates Inc.

THE 1988 EDITION OF THE MINNESOTA DEPARTMENT OF TRANSPORTATION "STANDARD SPECIFICATIONS FOR CONSTRUCTION" SHALL GOVERN.

SHEET 1 OF 18

SAP 204-III-03

DRAWING NUMBER

DRAWING NUMBER

DRAWING NUMBER

DRAWING NUMBER
FILM 91