

# 193RD AVENUE

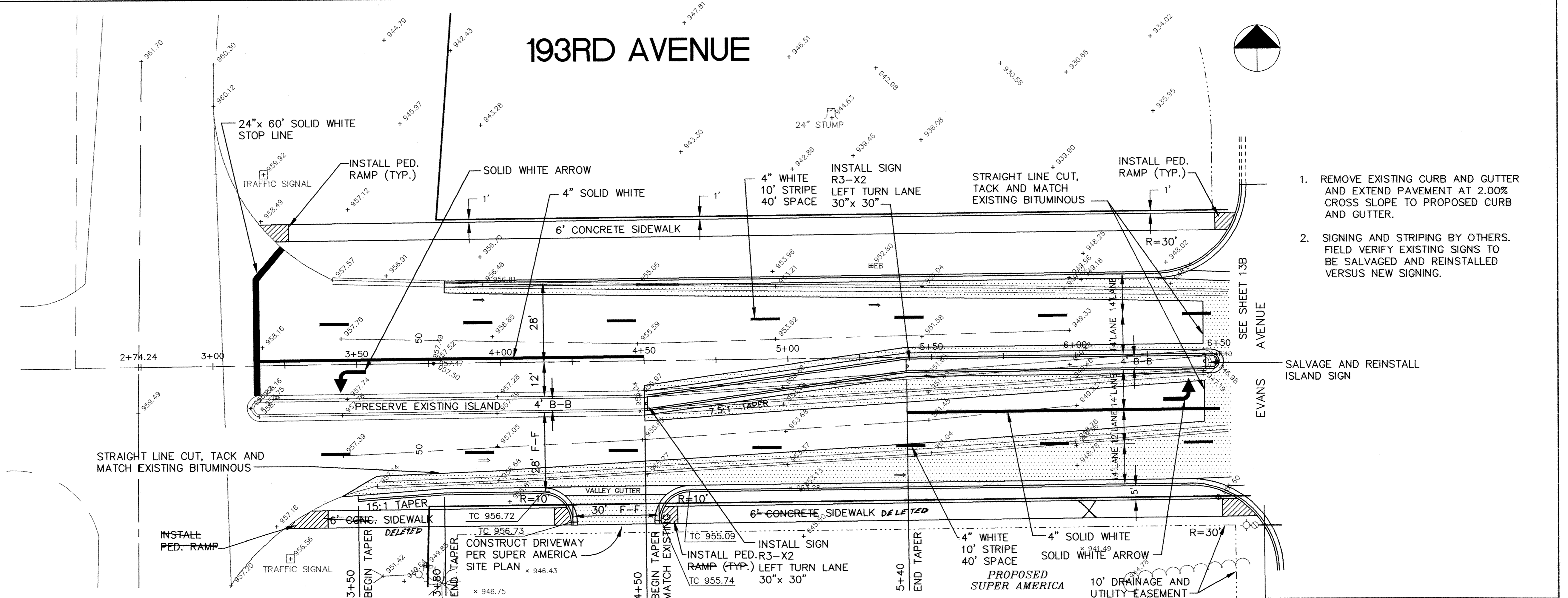

1. REMOVE EXISTING CURB AND GUTTER AND EXTEND PAVEMENT AT 2.00% CROSS SLOPE TO PROPOSED CURB AND GUTTER.
2. SIGNING AND STRIPING BY OTHERS. FIELD VERIFY EXISTING SIGNS TO BE SALVAGED AND REINSTALLED VERSUS NEW SIGNING.

SALVAGE AND REINSTALL ISLAND SIGN

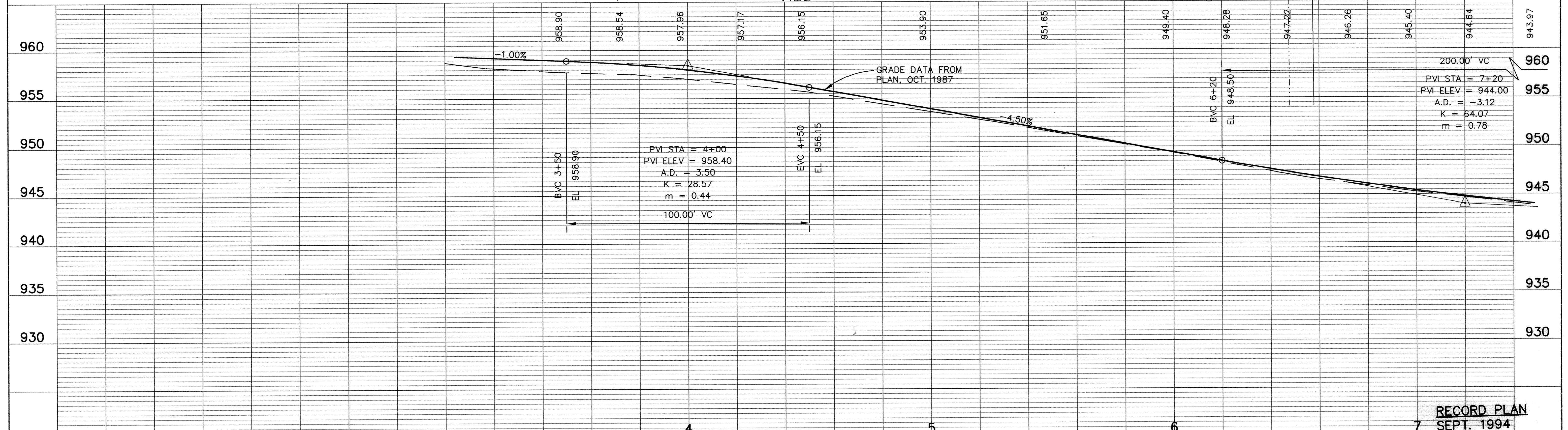

**RECORD PLAN**  
SEPT. 1994

I HEREBY CERTIFY THAT THIS PLAN, SPECIFICATION, OR REPORT WAS PREPARED BY ME OR UNDER MY DIRECT SUPERVISION AND THAT I AM A DULY REGISTERED PROFESSIONAL ENGINEER UNDER THE LAWS OF THE STATE OF MINNESOTA. <i>Samuel J. ...</i> DATE 8-1-94 REG. NO. 13929		1326 ENERGY PARK DRIVE ST. PAUL, MINNESOTA 55108 (612) 644-4389		DATE 7/5/94	DESCRIPTION REVISE 193RD AVENUE GEOMETRICS	DESIGNED PER CHECKED DRAWN	CITY OF ELK RIVER TURN LANES 193RD AVENUE	STA. 3+00 TO 6+50
		9800 SHELARD PARKWAY MINNEAPOLIS, MINNESOTA 55441 (612) 546-0432		REVISIONS	GRAPHIC SCALE 0' HORIZ. 20' 0' VERT. 5'	DATE JUNE 1994	SHEET 13A OF 17 SHEETS	PROJECT NO. 230-215