

SAICO PRODUCTS • NEW HOPE, MINNESOTA  
 REFER BY PART NUMBER 0592

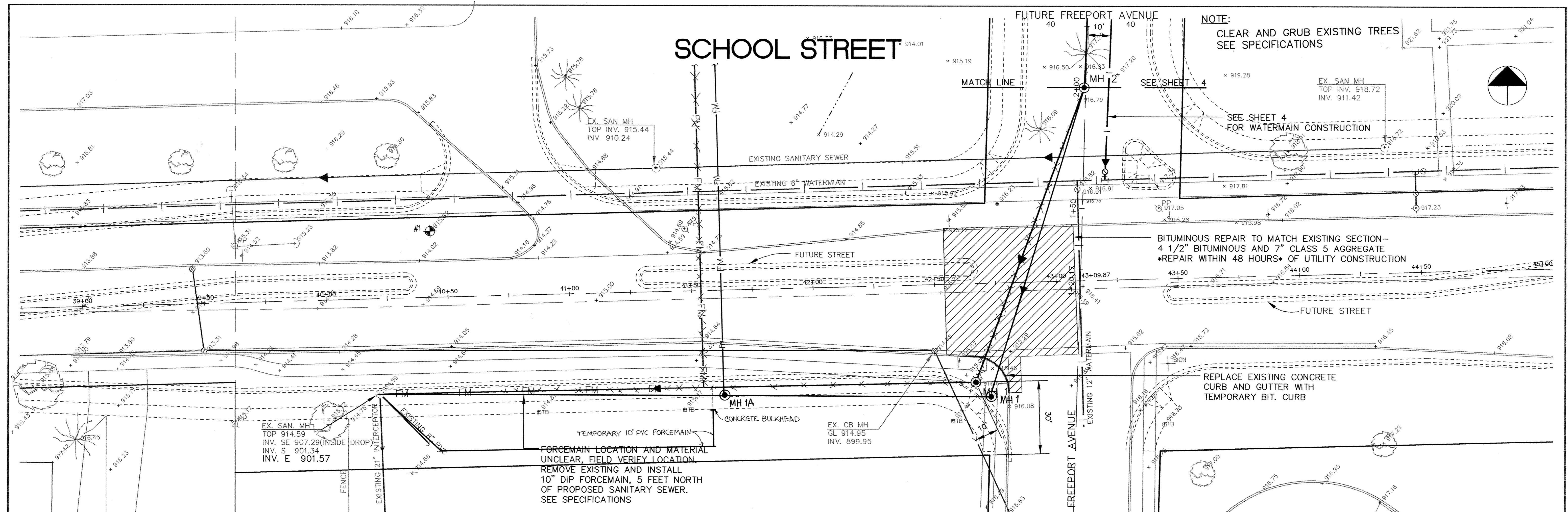

NOTE:  
 CLEAR AND GRUB EXISTING TREES  
 SEE SPECIFICATIONS

EX. SAN MH  
 TOP INV. 918.72  
 INV. 911.42

SEE SHEET 4  
 FOR WATERMAIN CONSTRUCTION

BITUMINOUS REPAIR TO MATCH EXISTING SECTION—  
 4 1/2" BITUMINOUS AND 7" CLASS 5 AGGREGATE  
 \*REPAIR WITHIN 48 HOURS\* OF UTILITY CONSTRUCTION

REPLACE EXISTING CONCRETE  
 CURB AND GUTTER WITH  
 TEMPORARY BIT. CURB

FORCEMAIN LOCATION AND MATERIAL  
 UNCLEAR, FIELD VERIFY LOCATION  
 REMOVE EXISTING AND INSTALL  
 10" DIP FORCEMAIN, 5 FEET NORTH  
 OF PROPOSED SANITARY SEWER.  
 SEE SPECIFICATIONS

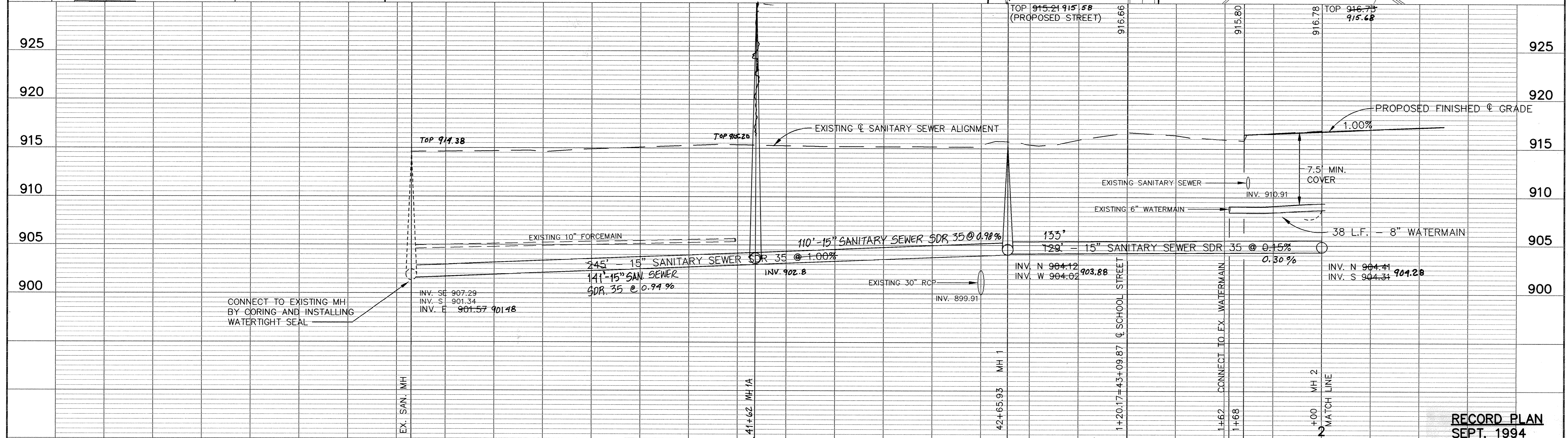

**RECORD PLAN**  
 SEPT. 1994

CITY OF ELK RIVER  
 TRUNK SANITARY AND WATERMAIN-ELK PARK CENTER STA.  
 SCHOOL STREET 40+21 TO 2+00

DATE MARCH 1994 SHEET 3 OF 17 SHEETS PROJECT NO. 230-215

I HEREBY CERTIFY THAT THIS PLAN, SPECIFICATION,  
 OR REPORT WAS PREPARED BY ME OR UNDER MY DIRECT  
 SUPERVISION AND THAT I AM A DULY REGISTERED  
 PROFESSIONAL ENGINEER UNDER THE LAWS OF THE  
 STATE OF MINNESOTA.  
*Paul Boehl*  
 DATE 3-28-94 REG. NO. 13929

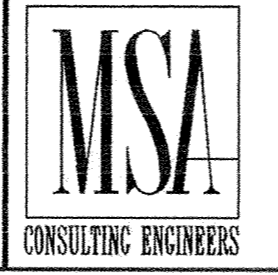

1326 ENERGY PARK DRIVE  
 ST. PAUL, MINNESOTA 55108  
 (612) 644-4389

9800 SHELARD PARKWAY  
 MINNEAPOLIS, MINNESOTA 55441  
 (612) 546-0432

DATE	DESCRIPTION

DESIGNED	PEB
CHECKED	SDG
DRAWN	CLS
GRAPHIC SCALE	
0 HORIZ.	20
0 VERT.	5