

# U.S. HIGHWAY NO. 169

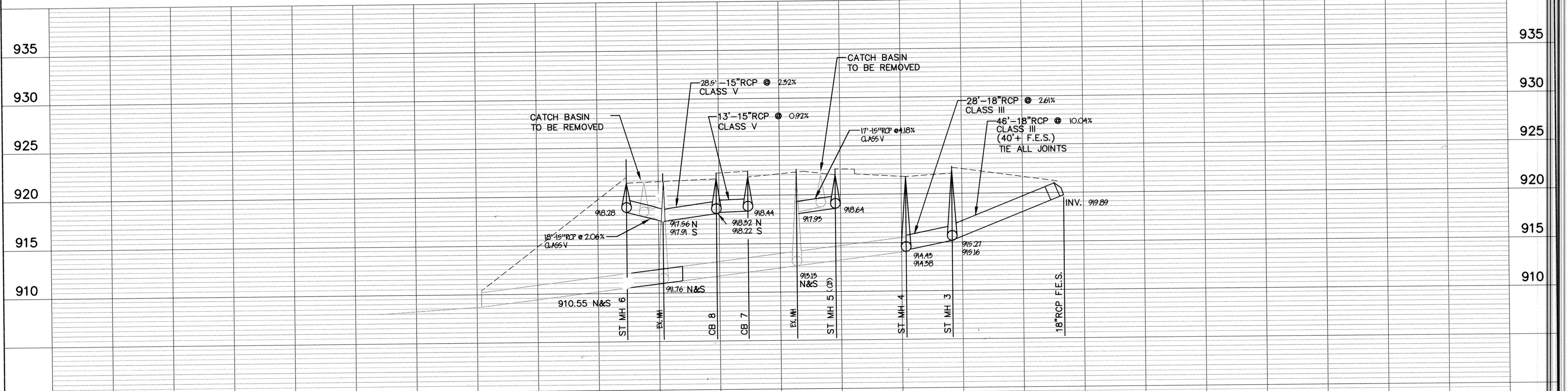
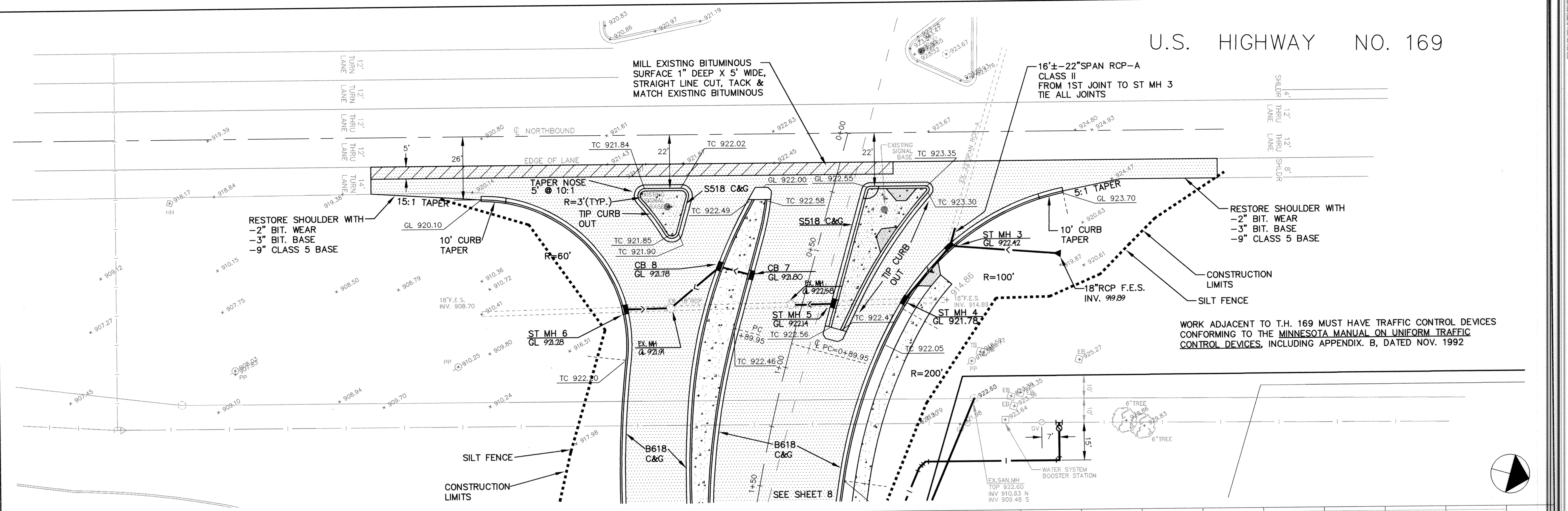

**RECORD PLAN  
JANUARY 1996**

<p>I HEREBY CERTIFY THAT THIS PLAN, SPECIFICATION, OR REPORT WAS PREPARED BY ME OR UNDER MY DIRECT SUPERVISION AND THAT I AM A DULY REGISTERED PROFESSIONAL ENGINEER UNDER THE LAWS OF THE STATE OF MINNESOTA.</p> <p style="text-align: center;"><i>Amelia Blomquist</i> DATE 7/31/95 REG. NO. 24082</p>	<p><b>MSA</b> CONSULTING ENGINEERS</p>	<p>1326 ENERGY PARK DRIVE ST. PAUL, MINNESOTA 55108 (612) 644-4389</p> <p>9800 SHELARD PARKWAY MINNEAPOLIS, MINNESOTA 55441 (612) 546-0432</p>	<p>DESIGNED <u>JL</u></p> <p>CHECKED <u>JL</u></p> <p>DRAWN <u>JL</u></p> <p>GRAPHIC SCALE 0 20 0 VERT. 5</p>	<p>CITY OF ELK RIVER ELK HILLS DRIVE/DODGE STREET IMPROVEMENTS ELK HILLS DRIVE AT T.H. 169 STORM SEWER AND INTERSECTION CONSTRUCTION</p> <p>DATE JULY 1995 SHEET 7 OF 22 SHEETS PROJECT NO. 230-246</p>
---	--	--	---	---