

# TYLER STREET

PERMANENT SIGNS				
KEY	SYMBOL	WORDING/SYMBOL PLATE CODE	SIZE (IN) SIZE (mm)	QUANTITY THIS SHEET
A		STOP R1-1	30 X 30 760 X 760	-
B		LEFT TURN ONLY R3-8F	36 X 30 910 X 760	-
C		KEEP RIGHT R4-7	24 X 30 610 X 760	1
D		DIVIDED HIGHWAY CROSSING R6-3	24 X 18 610 X 450	-
E		DIVIDED HIGHWAY CROSSING R6-3a	24 X 18 610 X 450	-
F		SPEED LIMIT R2-1	18 X 24 450 X 600	1
G		STOP AHEAD W3-1a	36 X 36 910 X 910	-
H		HAZARD MARKER X4-2	18 X 18 450 X 450	1
I		LEFT TURN LANE R3-X2	30 X 30 760 X 760	-
J		DIVIDED HIGHWAY W6-1	36 X 36 910 X 910	1
K		DIVIDED HIGHWAY ENDS W6-2	36 X 36 910 X 910	1
L		TRUCK STOPPING LANE R4-X4	36 X 36 910 X 910	2
M		RAILROAD ADVANCE WARNING W10-1	36 X 36 910 X 910	2
N		RIGHT TURN LANE R3-X1	30 X 30 760 X 760	1
P	-	LEAVE OPENING IN CONCRETE FOR FUTURE POST	-	-

PERMANENT STRIPING				
KEY	DESCRIPTION	WIDTH	COLOR	REMARKS
①	LANE LINE	100 mm	WHITE	SOLID
②	LANE LINE	100 mm	WHITE	SKIP - 2 m STRIPE, 8 m SPACE
③	CENTER STRIPE	100 mm	YELLOW	SOLID DOUBLE
④	STOP BAR	600 mm	WHITE	SOLID
⑤	LEFT TURN ARROW	250 mm X 2.5 m	WHITE	SOLID
⑥	RIGHT TURN ARROW	250 mm X 2.5 m	WHITE	SOLID
⑦	CENTER STRIPE	100 mm	YELLOW	SKIP - 2 m STRIPE, 8 m SPACE
⑧	TAPER STRIPING	600 mm	YELLOW	SOLID
⑨	CENTER STRIPING	100 mm	YELLOW	SOLID
⑩	CROSSWALK	900 mm	WHITE	SEE CROSSWALK TABLE
⑪	RR XING	-	-	SEE MMUTCD

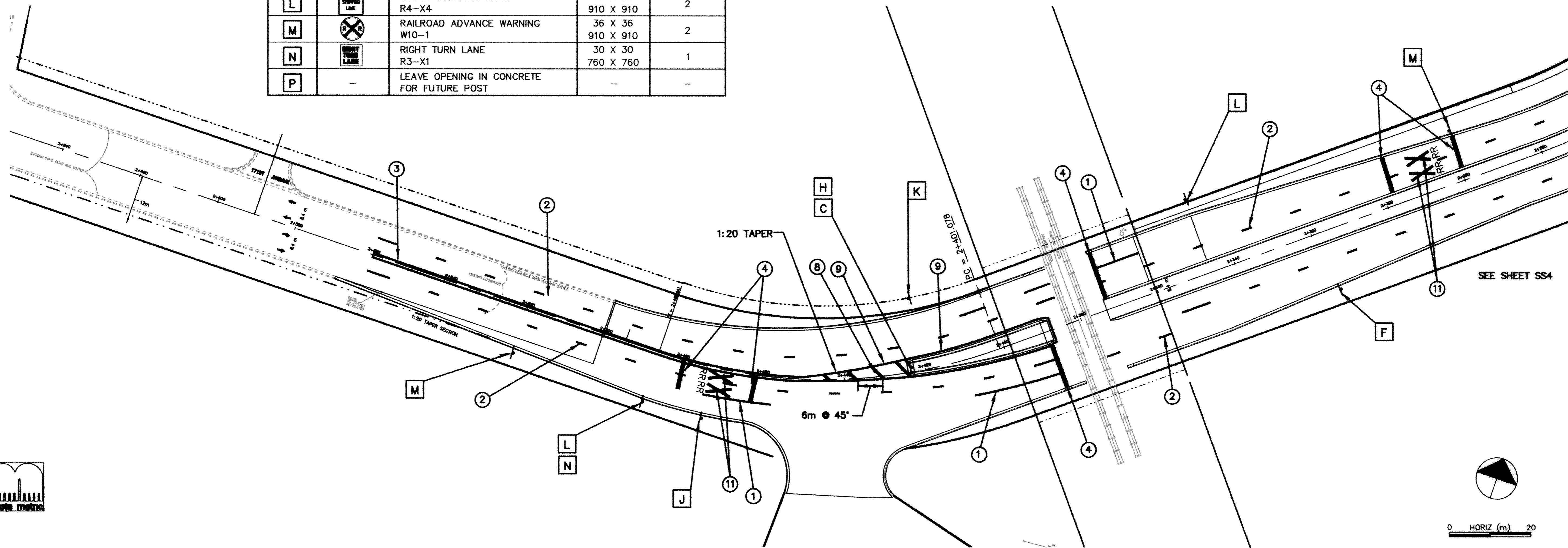

DESIGNED BY: AB JOB DATE: DECEMBER 1998  
 DRAWN BY: *ajg* JOB NUMBER: 800110J  
 APPROVED: \_\_\_\_\_ CAD DATE: \_\_\_\_\_  
 CAD FILE: January 06, 2003 9:31:26 a.m.  
 800110J\800110J\DWGS\TYLER\_SIGN\SS4A.DWG (JALLEN)

I HEREBY CERTIFY THAT THIS PLAN, SPECIFICATION,  
 OR REPORT WAS PREPARED BY ME OR UNDER MY DIRECT  
 SUPERVISION AND THAT I AM A DULY REGISTERED  
 PROFESSIONAL ENGINEER UNDER THE LAWS OF THE  
 STATE OF MINNESOTA.  
 DATE: \_\_\_\_\_ REG. NO. \_\_\_\_\_

NO.	DATE	BY	REVISION DESCRIPTION

**Howard R. Green Company**  
 CONSULTING ENGINEERS

1326 ENERGY PARK DRIVE  
 ST. PAUL, MINNESOTA 55108  
 (612) 644-4389

**CITY OF ELK RIVER**  
**EASTERN AREA**  
**TYLER STREET IMPROVEMENTS**

**SIGNING AND STRIPING PLAN**  
 2+260 TO 2+640  
 SP 71-613-08, SP 204-020-03, SP 204-133-01, SP 204-132-03

SHEET NO.  
**SS4A**