

NOTE:
 REMOVE EXISTING CONCRETE CURB AND GUTTER
 STA. 2+428 TO 2+500 NORTH SIDE
 STA. 2+428 TO 2+558 SOUTH SIDE

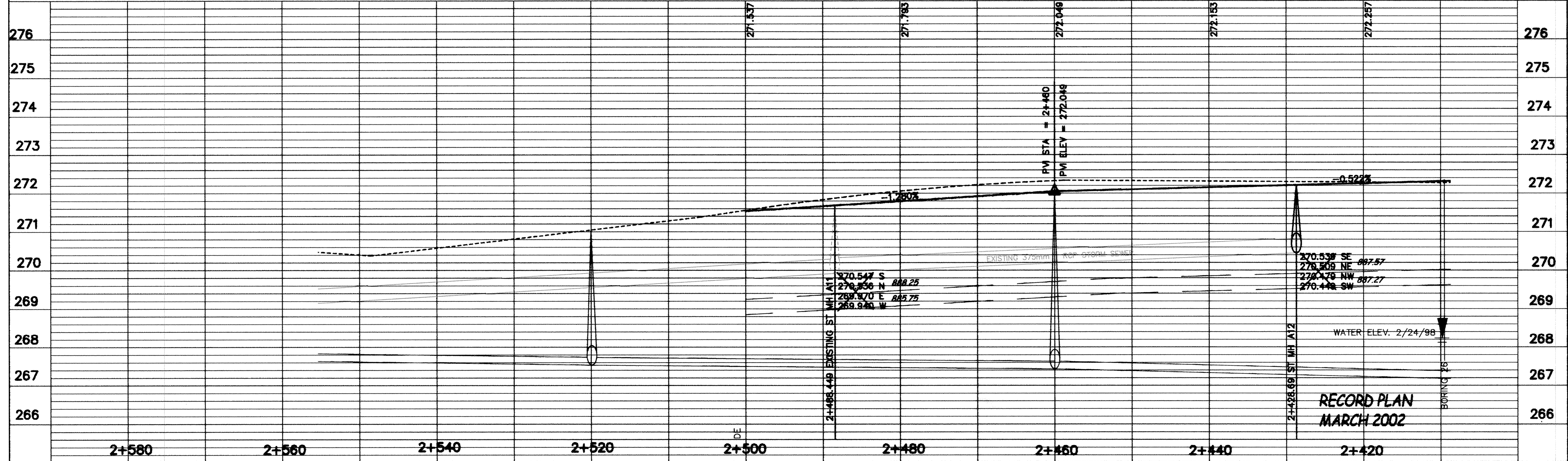
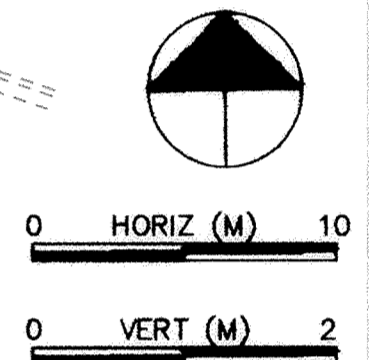

DESIGNED BY: --- DRAWN BY: *[Signature]*
 APPROVED: --- JOB NUMBER 800110J
 CAD DATE: April 17, 2002 3:19:03 p.m.
 CAD FILE: 800110T\Asbults\S SEGMENT\16.DWG

I HEREBY CERTIFY THAT THIS PLAN, SPECIFICATION, OR REPORT WAS PREPARED BY ME OR UNDER MY DIRECT SUPERVISION AND THAT I AM A DULY REGISTERED PROFESSIONAL ENGINEER UNDER THE LAWS OF THE STATE OF MINNESOTA.
 DATE _____ REG. NO. _____

NO.	DATE	BY	REVISION DESCRIPTION
1.	11-8-99	RM	REVISE STORM SEWER

Howard R. Green Company
 CONSULTING ENGINEERS
 1326 ENERGY PARK DRIVE
 ST. PAUL, MINNESOTA 55108
 (612) 644-4388

CITY OF ELK RIVER
 EASTERN AREA
 TYLER STREET IMPROVEMENTS

PLAN + PROFILE S. OF C.S.A.H. 12
 SP 71-613-08, SP 204-020-03, SP 204-133-01, SP 204-132-03
 2+420 TO 2+580

SHEET NO.
CI-17

DRAWING NUMBER EASTE 01 34 DRAWING NUMBER