

171ST AVENUE

NOTE:
 AUGER OR PUSH CONDUIT UNDER
 EXISTING ENTRANCES AND ROAD
 ALONG 171ST AVENUE. (INCIDENTAL)

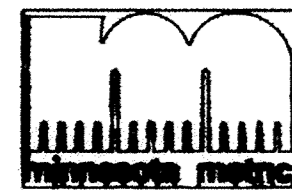
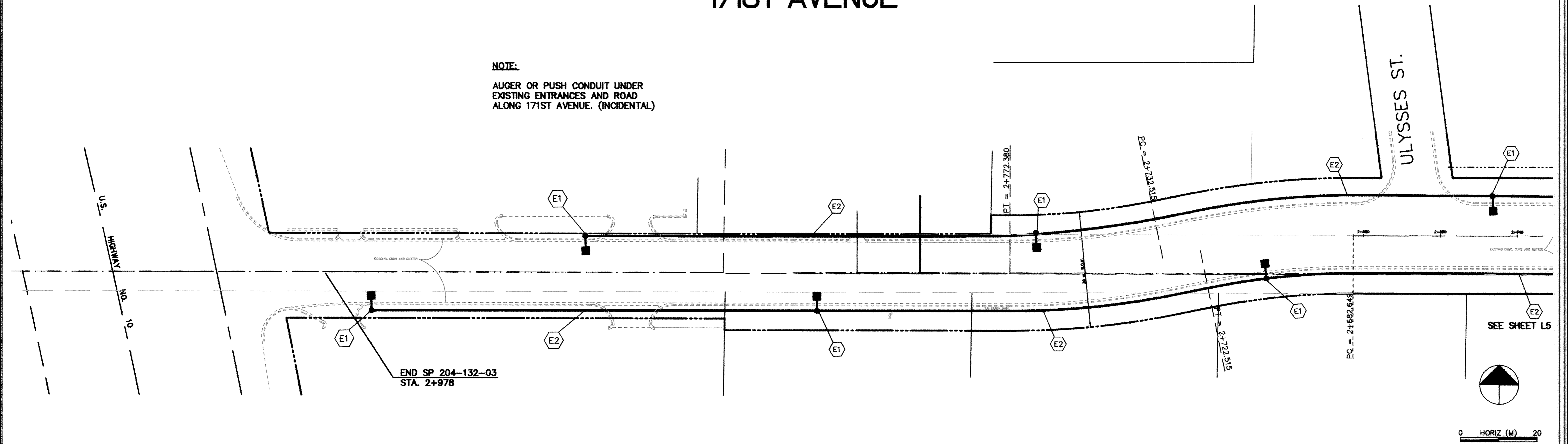

DESIGNED BY: AB JOB DATE: MARCH 1998
 DRAWN BY: [Signature] JOB NUMBER: 800110J
 APPROVED: CAD DATE:
 CAD FILE: January 06, 2003 10:02:10 a.m.
 800110T\800110J\DWGS\TYLER_LIGHTING\TYLER-LITES.DWG

I HEREBY CERTIFY THAT THIS PLAN, SPECIFICATION,
 OR REPORT WAS PREPARED BY ME OR UNDER MY DIRECT
 SUPERVISION AND THAT I AM A DULY REGISTERED
 PROFESSIONAL ENGINEER UNDER THE LAWS OF THE
 STATE OF MINNESOTA.

DATE: _____ REG. NO. _____

NO.	DATE	BY	REVISION DESCRIPTION

Howard R. Green Company
 CONSULTING ENGINEERS
 1328 ENERGY PARK DRIVE
 ST. PAUL, MINNESOTA 55108
 (612) 644-4389

CITY OF ELK RIVER
EASTERN AREA
TYLER STREET IMPROVEMENTS

LIGHTING PLAN
171ST AVENUE
 S.P. 204-132-03 2+640 TO TH 10

SHEET NO.
L6

DRAWING NUMBER EASTE.01 106