

C.S.A.H. NO.12

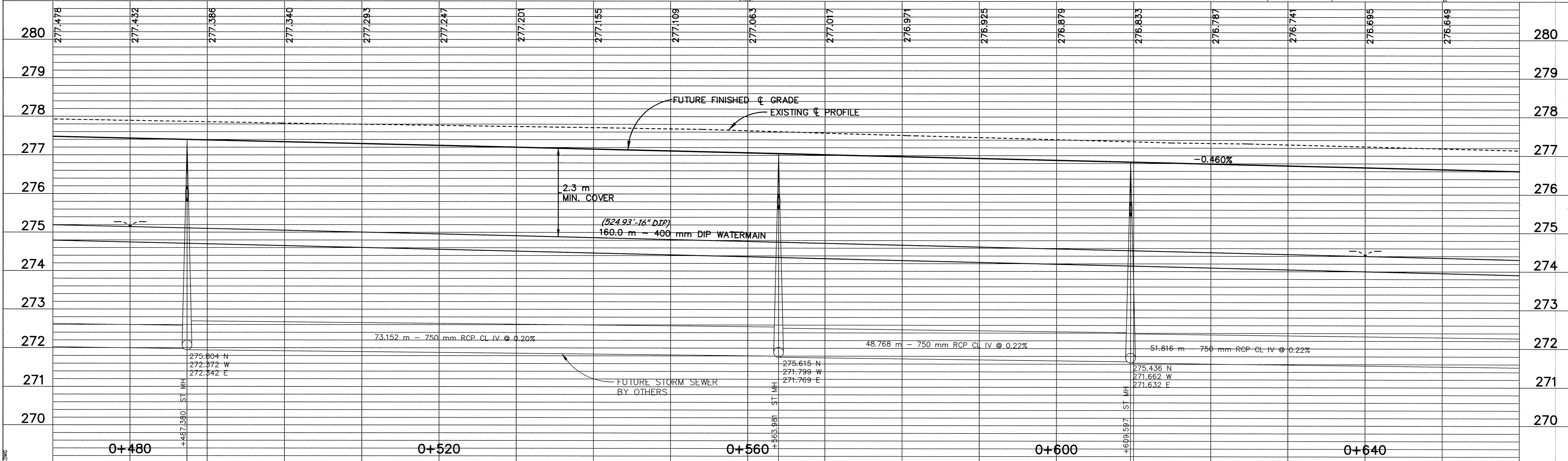
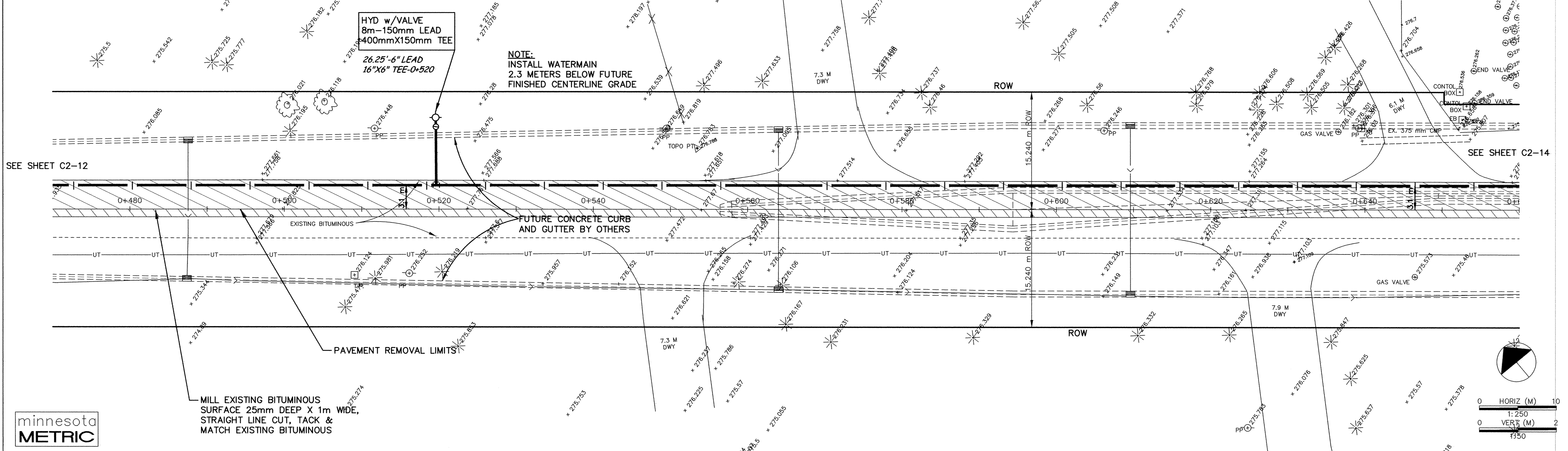

DESIGNED BY: _____ JOB DATE: JULY 1998
 DRAWN BY: *afg* JOB NUMBER: 800110J
 APPROVED: _____ CAD DATE: JULY 1998
 CAD FILE: March 29, 2001 9:42:53 a.m.
 800110\AS-BUILTS\AS_BALDWIN-5TH\AS09.DWG

I HEREBY CERTIFY THAT THIS PLAN, SPECIFICATION, OR REPORT WAS PREPARED BY ME OR UNDER MY DIRECT SUPERVISION AND THAT I AM A DULY REGISTERED PROFESSIONAL ENGINEER UNDER THE LAWS OF THE STATE OF MINNESOTA.

DATE: 10/15/98 REG. NO.: 15316

NO.	DATE	BY	REVISION DESCRIPTION

1326 ENERGY PARK DRIVE
 ST. PAUL, MINNESOTA 55108
 (612) 644-4389

Howard R. Green Company
 CONSULTING ENGINEERS

CITY OF ELK RIVER
EASTERN AREA
PHASE I IMPROVEMENTS

WATERMAIN IMPROVEMENTS
C.S.A.H. NO.12
0+480 TO 0+640

SHEET NO.
C2-13