

C.S.A.H. NO.13

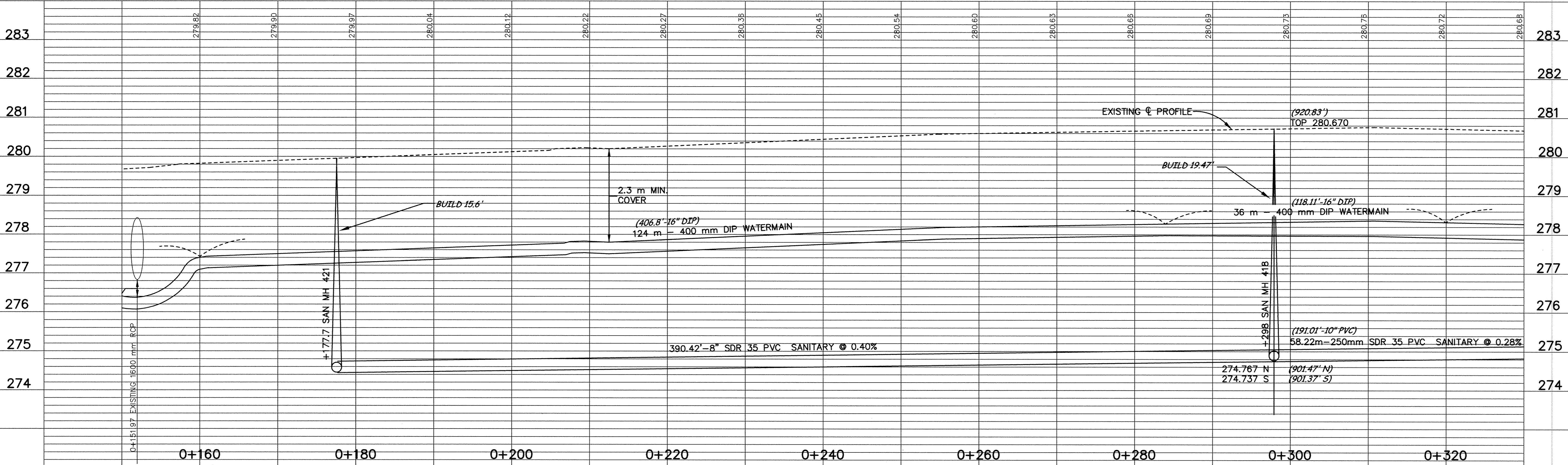
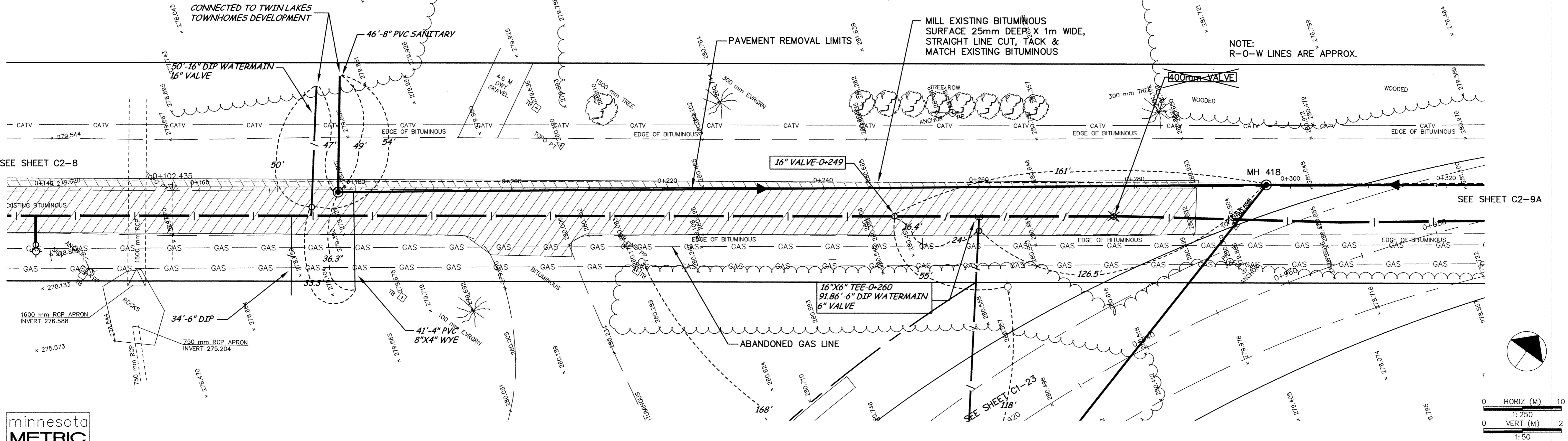

DESIGNED BY: _____ JOB DATE: MARCH 1998
 DRAWN BY: *ajg* JOB NUMBER: 800110J
 APPROVED: _____ CAD DATE: AUGUST 1998
 CAD FILE: March 28, 2001 4:14:08 p.m.
 800110J\AS-BUILTS\AS_BALDWIN-5TH\AS13.DWG

I HEREBY CERTIFY THAT THIS PLAN, SPECIFICATION, OR REPORT WAS PREPARED BY ME OR UNDER MY DIRECT SUPERVISION AND THAT I AM A DULY REGISTERED PROFESSIONAL ENGINEER UNDER THE LAWS OF THE STATE OF MINNESOTA.
 DATE: _____ REG. NO.: 15316

NO.	DATE	BY	REVISION DESCRIPTION
1	1-20-99	PH	REVISED WM SIZE C.O. NO. 1
2	9-16-99	RM	REVISE SANITARY ALIGNMENT

Howard R. Green Company
 CONSULTING ENGINEERS
 1326 ENERGY PARK DRIVE
 ST. PAUL, MINNESOTA 55108
 (612) 644-4389

CITY OF ELK RIVER
 EASTERN AREA
 PHASE I IMPROVEMENTS

WATERMAIN IMPROVEMENTS
 CSAH 13 BETWEEN 5TH AND TYLER
 0+160 TO 0+320

SHEET NO.
C2-9

DRAWING NUMBER
 EAST 1:90
 92
 DRAWING NUMBER
 EAST 1:90
 92
 DRAWING NUMBER
 EAST 1:90
 92