

# C.S.A.H. NO.13

NOTE:  
R-O-W LINES ARE APPROX.

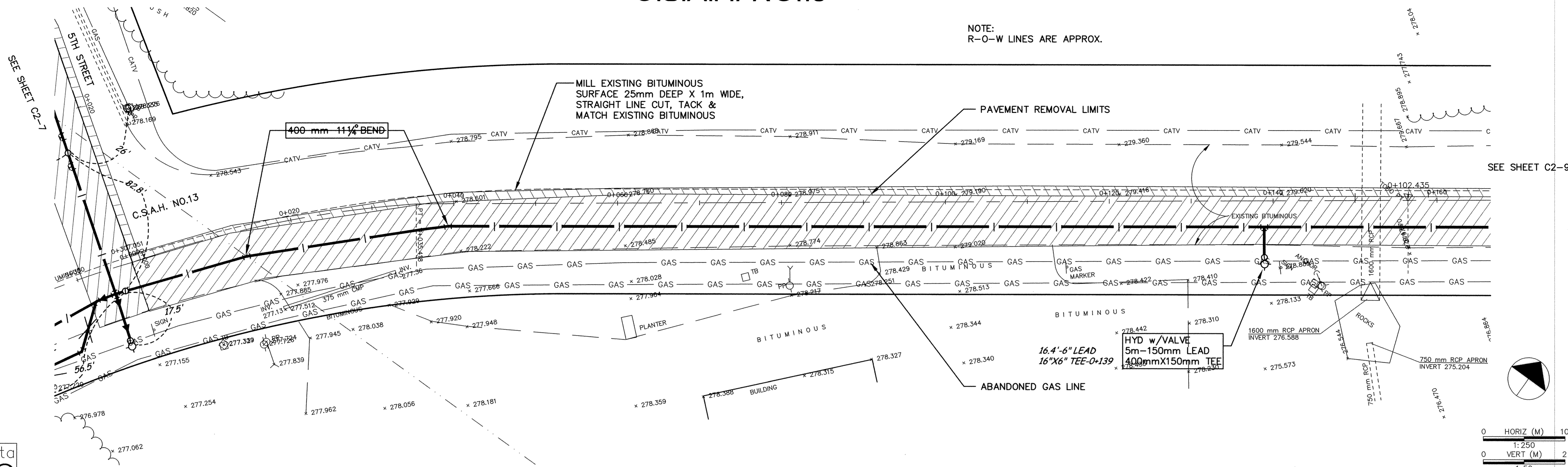

minnesota METRIC

0 HORIZ (M) 10  
1:250  
0 VERT (M) 2  
1:50

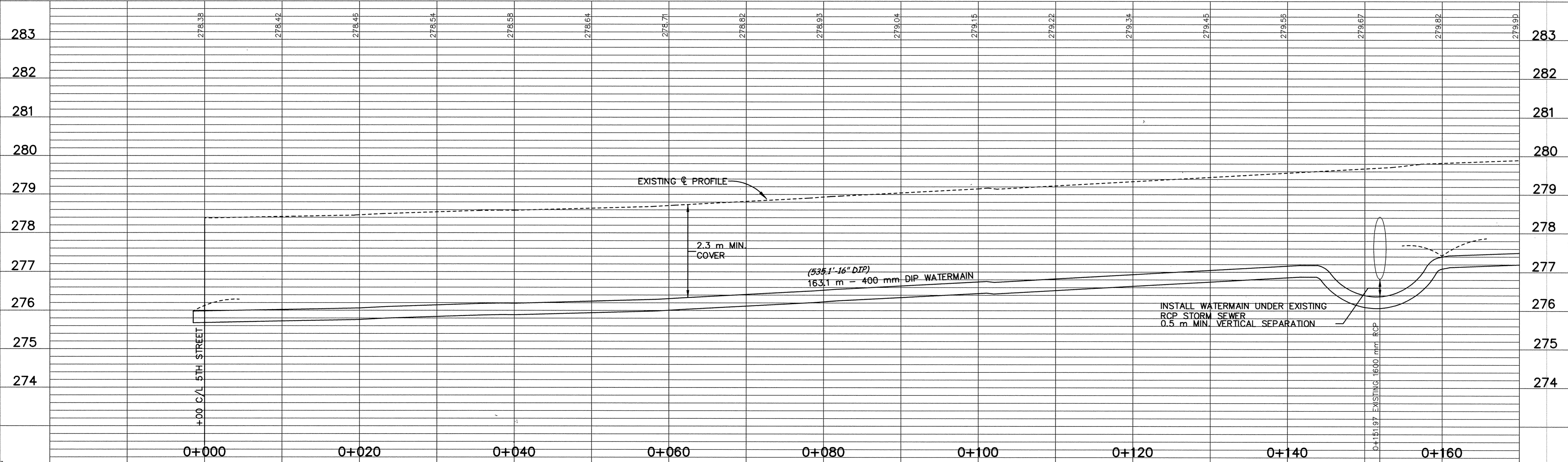

DESIGNED BY: \_\_\_\_\_ JOB DATE: MARCH 1998  
DRAWN BY: *[Signature]* JOB NUMBER: 800110J  
APPROVED: \_\_\_\_\_ CAD DATE: AUGUST 1998  
CAD FILE: February 08, 1999 1:18:36 p.m.  
800110J\Dwgs\BALDWIN\12.DWG

I HEREBY CERTIFY THAT THIS PLAN, SPECIFICATION,  
OR REPORT WAS PREPARED BY ME OR UNDER MY DIRECT  
SUPERVISION AND THAT I AM A DULY REGISTERED  
PROFESSIONAL ENGINEER UNDER THE LAWS OF THE  
STATE OF MINNESOTA.  
DATE \_\_\_\_\_ REG.NO. 15316

NO.	DATE	BY	REVISION DESCRIPTION
1	1-20-99	PH	REVISED WM SIZE C.O. NO. 1

1326 ENERGY PARK DRIVE  
ST. PAUL, MINNESOTA 55108  
(612) 644-4389

Howard R. Green Company  
CONSULTING ENGINEERS

CITY OF ELK RIVER  
EASTERN AREA  
PHASE I IMPROVEMENTS

WATERMAIN IMPROVEMENTS  
CSAH 13 BETWEEN 5TH AND TYLER  
0+000 TO 0+160

SHEET NO.  
C2-8

DRAWING NUMBER

DRAWING NUMBER

DRAWING NUMBER

DRAWING NUMBER  
EAST 1.98