

# C.S.A.H. NO.13

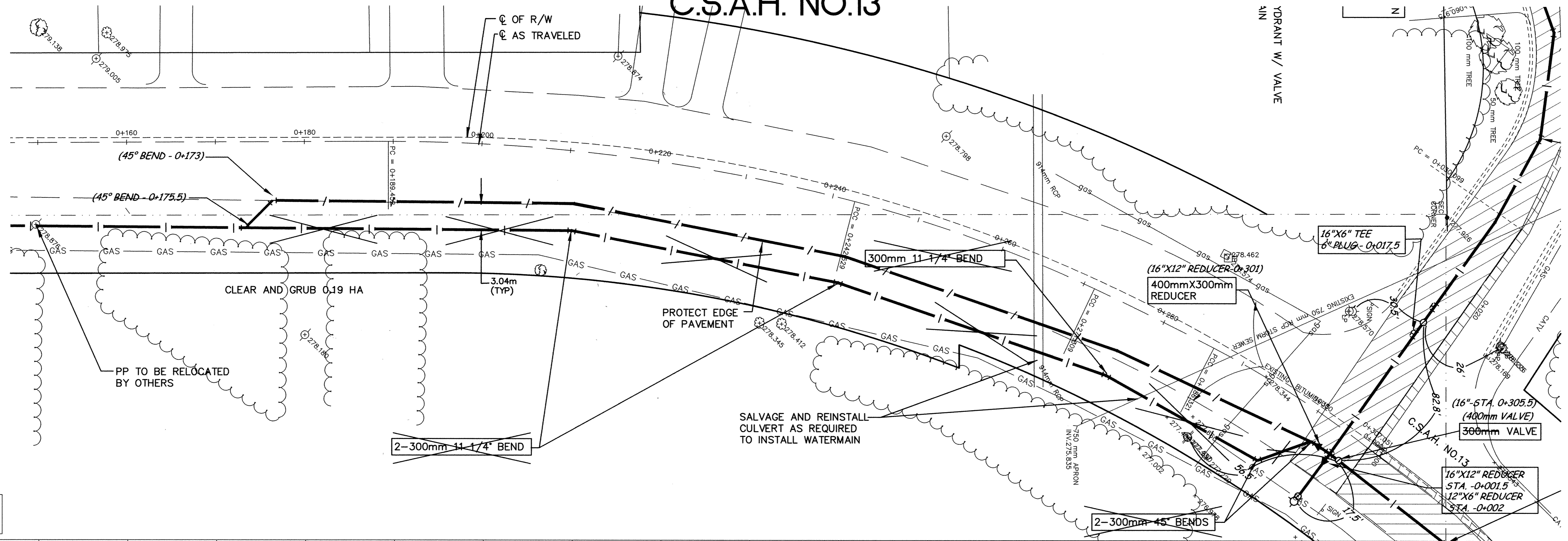

minnesota  
METRIC

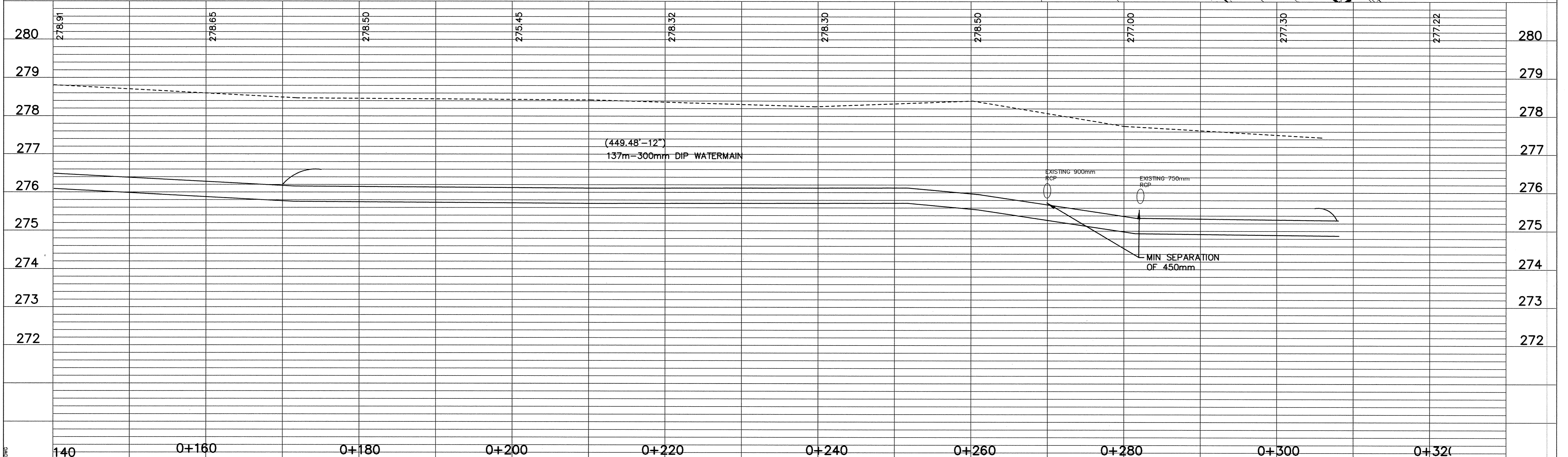

DESIGNED BY: \_\_\_\_\_ JOB DATE: MARCH 1998  
 DRAWN BY: *gjt* JOB NUMBER: 800110J  
 APPROVED: \_\_\_\_\_ CAD DATE: MARCH 1998  
 CAD FILE: March 21, 2001 1:25:48 p.m.  
 800110\AS-BUILTS\AS\_BALDWIN-5TH\_BASE\AS06B.DWG

I HEREBY CERTIFY THAT THIS PLAN, SPECIFICATION, OR REPORT WAS PREPARED BY ME OR UNDER MY DIRECT SUPERVISION AND THAT I AM A DULY REGISTERED PROFESSIONAL ENGINEER UNDER THE LAWS OF THE STATE OF MINNESOTA.  
 DATE: \_\_\_\_\_ REG. NO.: 15316

NO.	DATE	BY	REVISION DESCRIPTION
1	1-21-99	PH	ADDED WM C.O. NO. 1

**Howard R. Green Company**  
 CONSULTING ENGINEERS  
 1326 ENERGY PARK DRIVE  
 ST. PAUL, MINNESOTA 55108  
 (612) 644-4389

**CITY OF ELK RIVER**  
 EASTERN AREA  
 PHASE I IMPROVEMENTS

**STREET AND WATERMAIN IMPROVEMENTS**  
 C.S.A.H. NO.13  
 0+000 TO 0+100

SHEET NO.  
**C2-2B**

DRAWING NUMBER  
 EASTE1.98  
 85  
 SACCO PRODUCTS • NEW HOPE, MINNESOTA  
 REORDER BY PART NUMBER 8832