

# C.S.A.H. NO.13

MILL EXISTING BITUMINOUS SURFACE 25 mm DEEP X 1 m WIDE, STRAIGHT LINE CUT, TACK AND MATCH EXISTING BITUMINOUS

MILL EXISTING BITUMINOUS SURFACE 25 mm DEEP X 1 m WIDE, STRAIGHT LINE CUT, TACK AND MATCH EXISTING BITUMINOUS

SEE SHEET C2-3

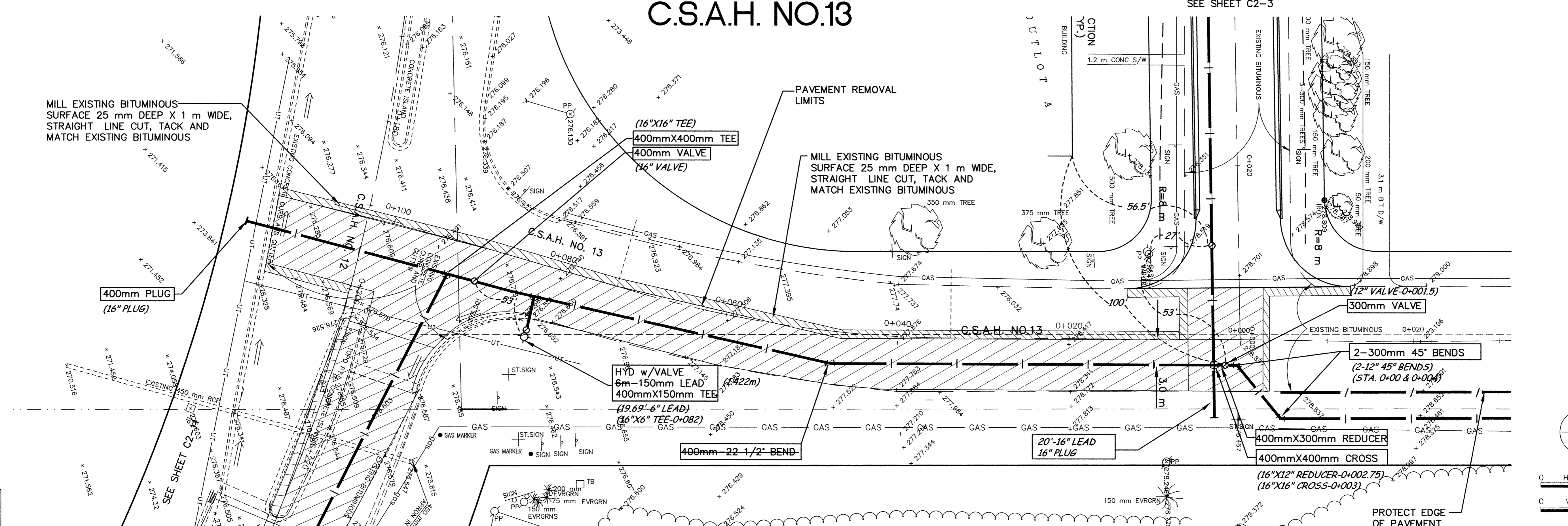

minnesota METRIC

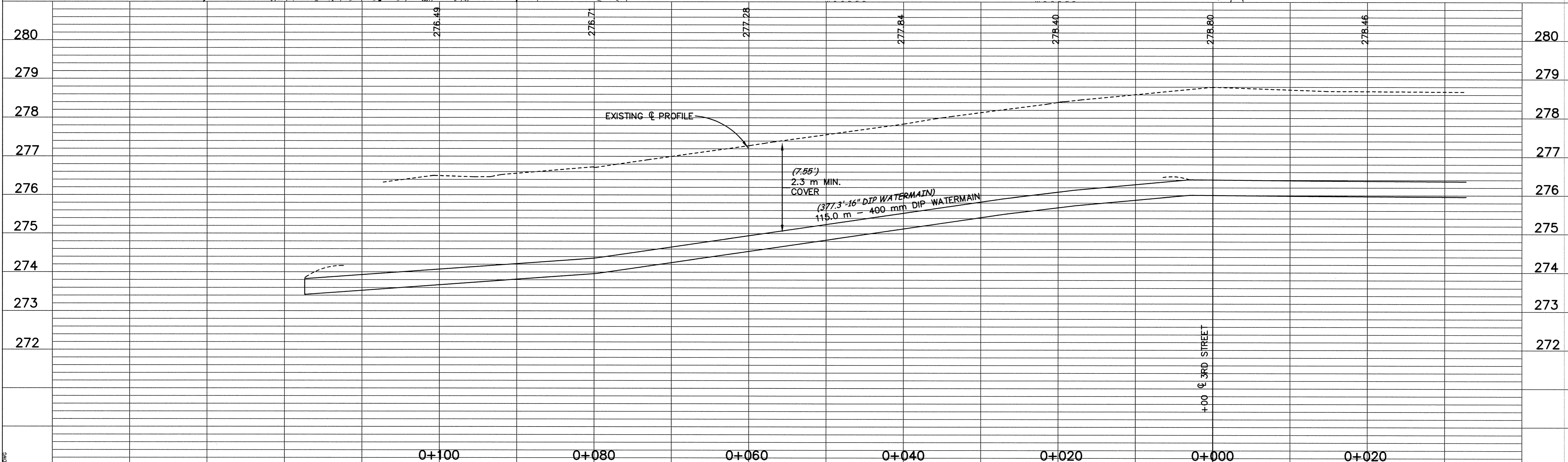

DESIGNED BY: \_\_\_\_\_ JOB DATE: MARCH 1998  
 DRAWN BY: *gjt* JOB NUMBER: 800110J  
 APPROVED: \_\_\_\_\_ CAD DATE: MARCH 1998  
 CAD FILE: March 21, 2001 11:16:38 a.m.  
 800110J\AS-BUILTS\AS\_BALDWIN-5TH\_BASE\AS06.DWG

I HEREBY CERTIFY THAT THIS PLAN, SPECIFICATION, OR REPORT WAS PREPARED BY ME OR UNDER MY DIRECT SUPERVISION AND THAT I AM A DULY REGISTERED PROFESSIONAL ENGINEER UNDER THE LAWS OF THE STATE OF MINNESOTA.  
 DATE: \_\_\_\_\_ REG. NO. 15316

NO.	DATE	BY	REVISION DESCRIPTION
1	1-20-99	PH	ADDITIONAL WM ON CSAH 13 N. OF 3RD ST

1326 ENERGY PARK DRIVE  
 ST. PAUL, MINNESOTA 55108  
 (612) 644-4389  
  
**Howard R. Green Company**  
 CONSULTING ENGINEERS

**CITY OF ELK RIVER**  
 EASTERN AREA  
 PHASE I IMPROVEMENTS

**STREET AND WATERMAIN IMPROVEMENTS**  
 C.S.A.H. NO.13  
 0+000 TO 0+100

SHEET NO.  
**C2-2**

DRAWING NUMBER EASTE198  
 DRAWING NUMBER C2-2  
 DRAWING NUMBER 83  
 S&C/D PRODUCTS • NEW HOPE, MINNESOTA  
 REVISION BY PART NUMBER 6552