

DRAWING NUMBER EAST 1.98
 DRAWING NUMBER 64
 DRAWING NUMBER C1-34X
 SARGO PRODUCTS • NEW HOPKIN, MINNESOTA
 REVISION BY PART NUMBER 6582
 SARGO PRODUCTS • NEW HOPKIN, MINNESOTA
 REVISION BY PART NUMBER 6582
 SARGO PRODUCTS • NEW HOPKIN, MINNESOTA
 REVISION BY PART NUMBER 6582
 SARGO PRODUCTS • NEW HOPKIN, MINNESOTA
 REVISION BY PART NUMBER 6582

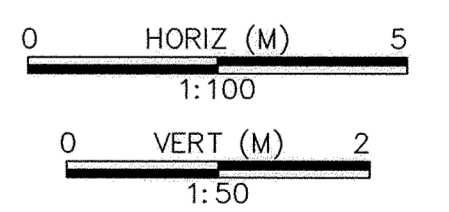
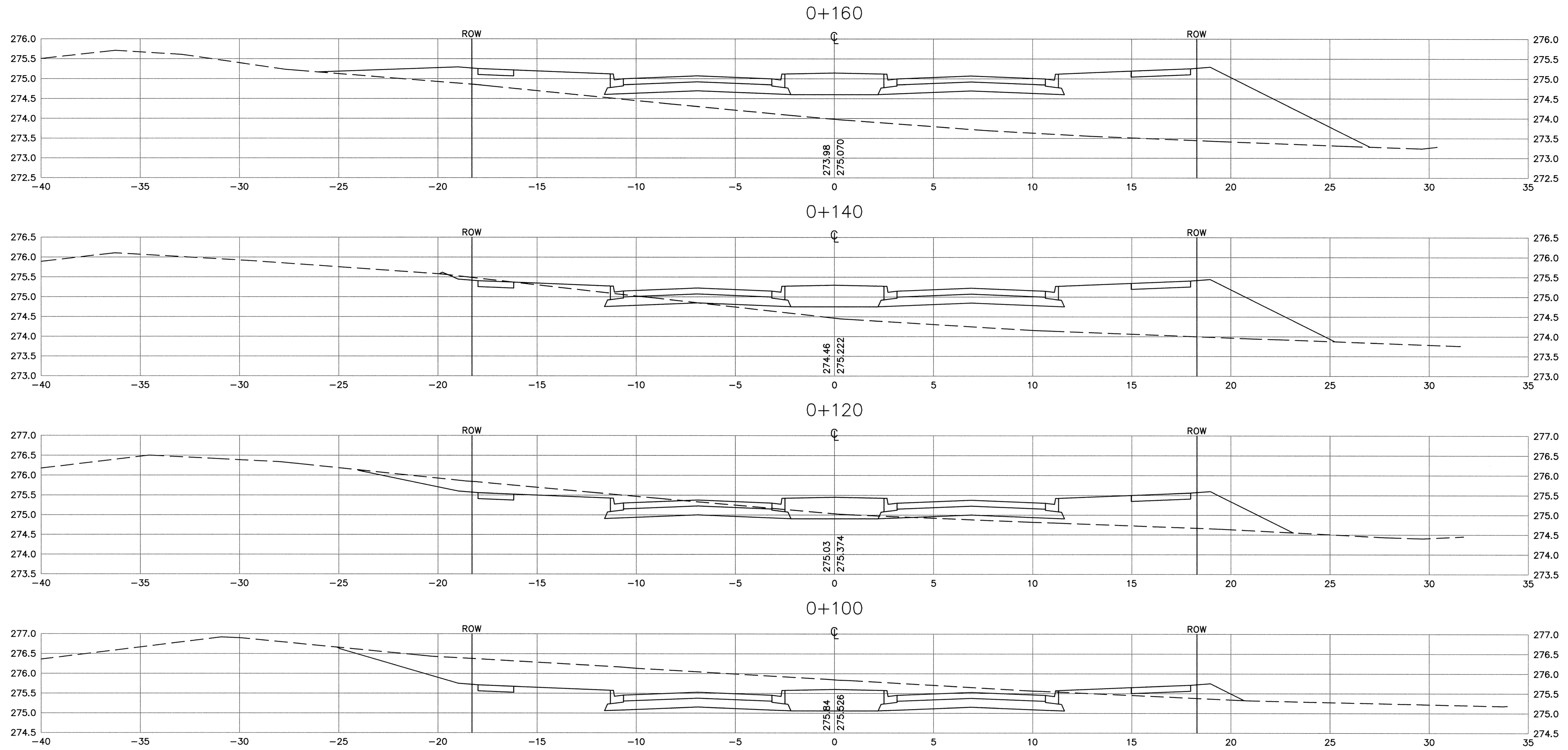

Xref: XSEC_BASE.DWG
 DESIGNED BY: AB DRAWN BY: [Signature]
 APPROVED: --- JOB NUMBER 800110J
 CAD DATE: October 09, 1998 2:33:08 p.m.
 CAD FILE: 800110J\Drawgs\NORTH_TYLER\X02.DWG

I HEREBY CERTIFY THAT THIS PLAN, SPECIFICATION,
 OR REPORT WAS PREPARED BY ME OR UNDER MY DIRECT
 SUPERVISION AND THAT I AM A DULY REGISTERED
 PROFESSIONAL ENGINEER UNDER THE LAWS OF THE
 STATE OF MINNESOTA.
 DATE 10/15/98 REG. NO. 15316

NO.	DATE	BY	REVISION DESCRIPTION

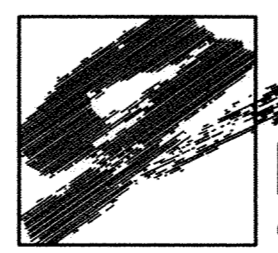
Howard R. Green Company
 CONSULTING ENGINEERS
 1326 ENERGY PARK DRIVE
 ST. PAUL, MINNESOTA 55108
 (612) 644-4389

CITY OF ELK RIVER
EASTERN AREA
PHASE I IMPROVEMENTS

STREET AND UTILITY IMPROVEMENTS
CROSS SECTIONS
TYLER STREET NORTH 0+080 TO 1+160

SHEET NO.
C1-34X