

# TRUNK HIGHWAY NO.10 AND NO.169

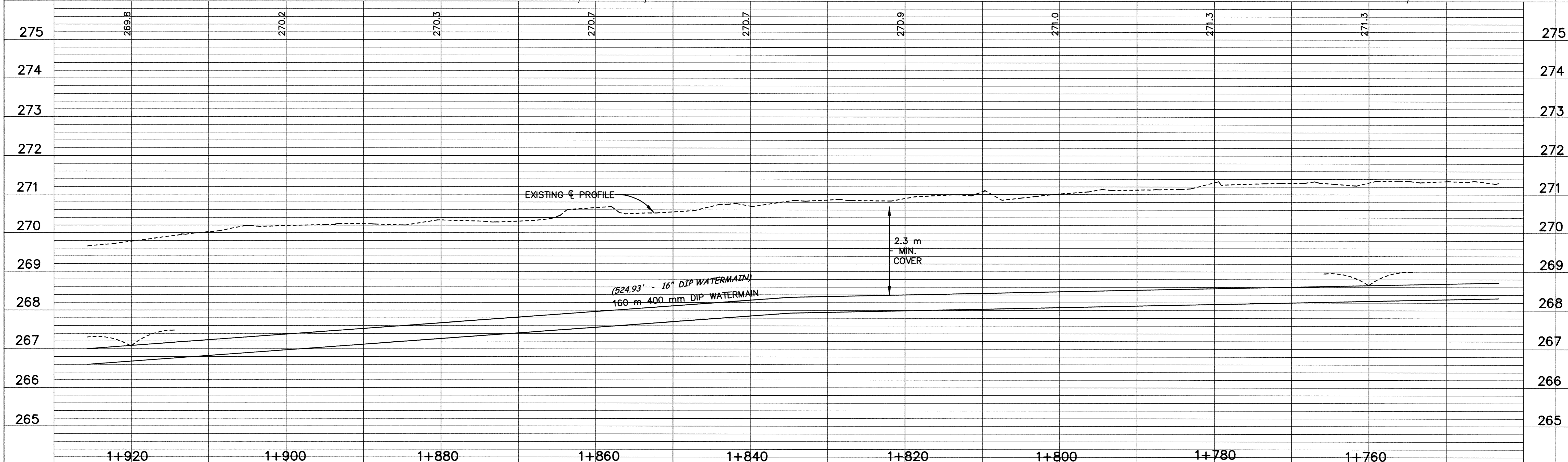
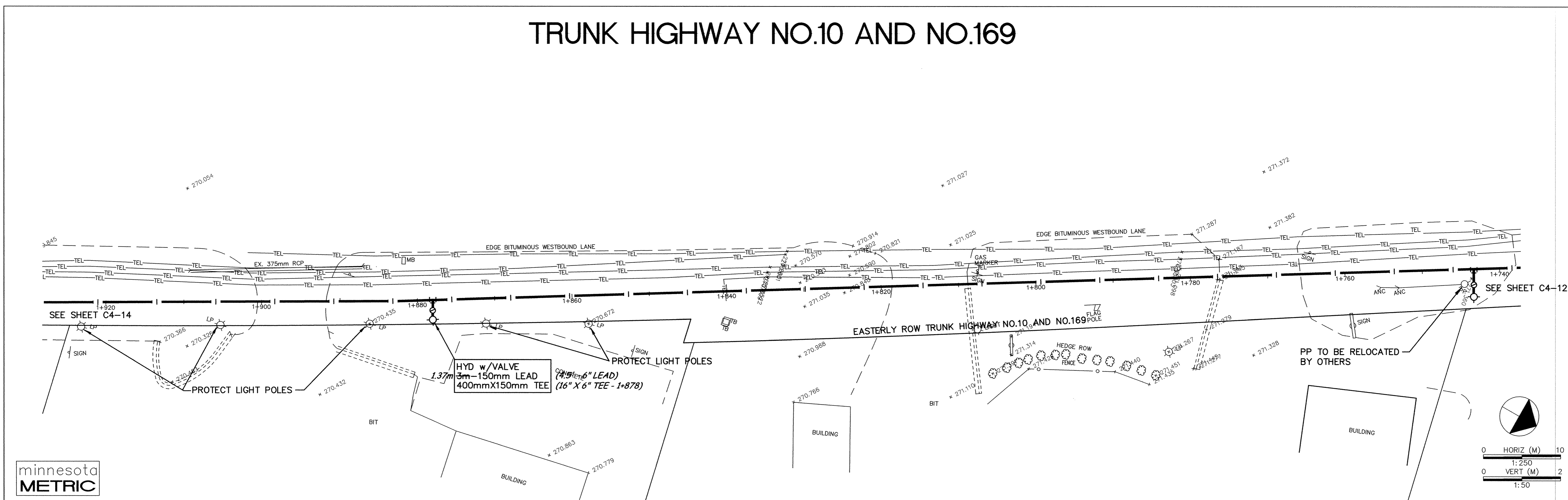

DESIGNED BY: --- DRAWN BY: EY  
 APPROVED: --- JOB NUMBER 800110J  
 CAD DATE: March 29, 2001 3:29:32 p.m.  
 CAD FILE: 800110\AS-BUILTS\AS\_HWY169\AS\_HWY\_1013.DWG

I HEREBY CERTIFY THAT THIS PLAN, SPECIFICATION, OR REPORT WAS PREPARED BY ME OR UNDER MY DIRECT SUPERVISION AND THAT I AM A DULY REGISTERED PROFESSIONAL ENGINEER UNDER THE LAWS OF THE STATE OF MINNESOTA.  
 DATE: 10/15/98 REG. NO. 15316

NO.	DATE	BY	REVISION DESCRIPTION

**Howard R. Green Company**  
 CONSULTING ENGINEERS

1326 ENERGY PARK DRIVE  
 ST. PAUL, MINNESOTA 55108  
 (612) 644-4389

CITY OF ELK RIVER  
 EASTERN AREA  
 PHASE I IMPROVEMENTS

TRUNK WATERMAIN IMPROVEMENTS  
 TRUNK HIGHWAY NO.10 AND NO.169  
 1+760 TO 1+920

SHEET NO.  
**C4-13**

DRAWING NUMBER EAST 1.98 134

DRAWING NUMBER 134

DRAWING NUMBER EAST 1.98 134

DRAWING NUMBER 134

DRAWING NUMBER EAST 1.98 134

DRAWING NUMBER 134

DRAWING NUMBER EAST 1.98 134

DRAWING NUMBER 134