

TRUNK HIGHWAY NO.169 ROW

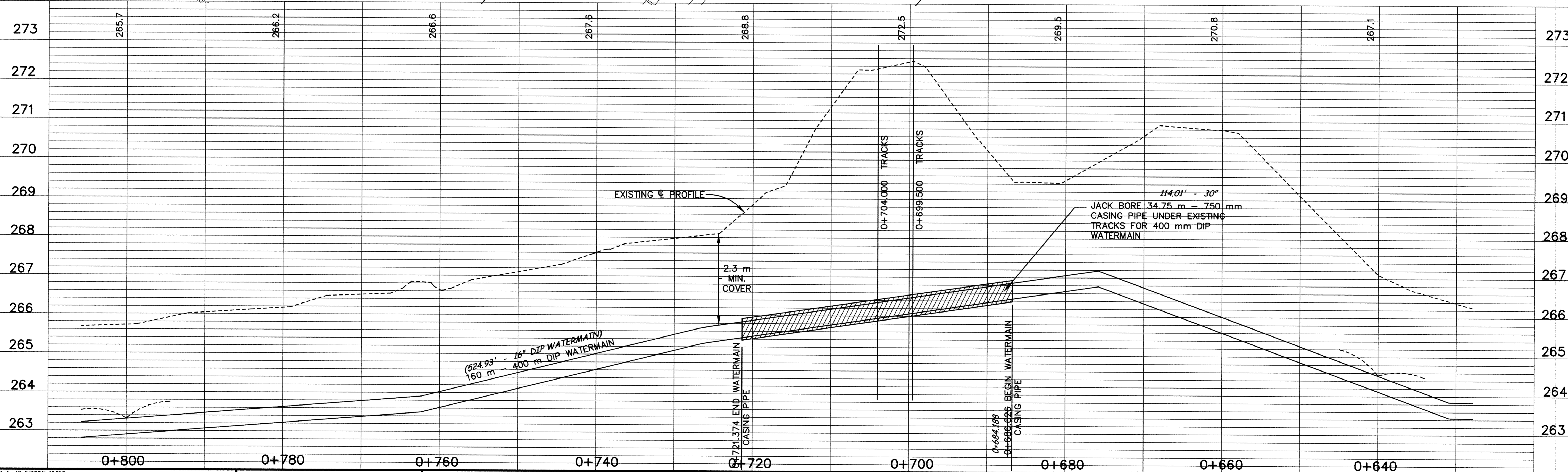
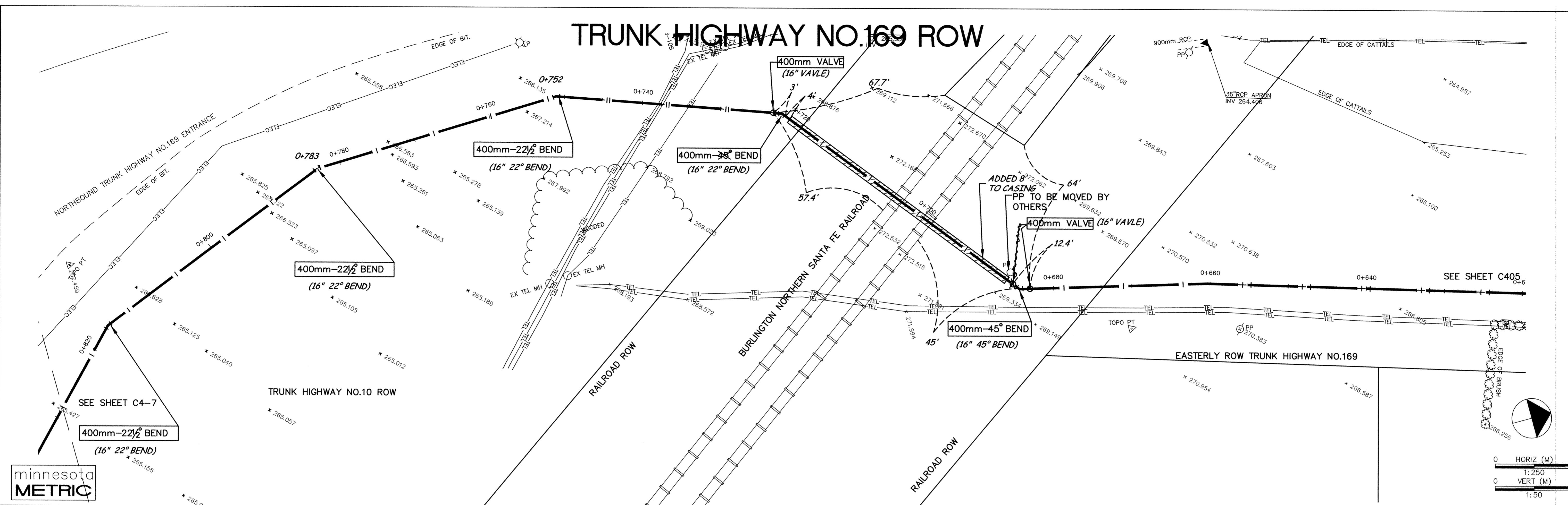

DESIGNED BY: --- DRAWN BY: EY
 APPROVED: --- JOB NUMBER: 800110J
 CAD DATE: March 30, 2001 8:53:20 a.m.
 CAD FILE: 800110J\AS-BUILTS\AS_HWY169\AS_HWY_106.DWG

I HEREBY CERTIFY THAT THIS PLAN, SPECIFICATION, OR REPORT WAS PREPARED BY ME OR UNDER MY DIRECT SUPERVISION AND THAT I AM A DULY REGISTERED PROFESSIONAL ENGINEER UNDER THE LAWS OF THE STATE OF MINNESOTA.
 DATE: 10/15/98 REG. NO.: 15316

| NO. | DATE | BY | REVISION DESCRIPTION |
|-----|------|----|----------------------|
| | | | |
| | | | |

1326 ENERGY PARK DRIVE
 ST. PAUL, MINNESOTA 55108
 (612) 644-4389
Howard R. Green Company
 CONSULTING ENGINEERS

CITY OF ELK RIVER
 EASTERN AREA
 PHASE I IMPROVEMENTS

TRUNK WATERMAIN IMPROVEMENTS
 TRUNK HIGHWAY NO.169 ROW
 0+640 TO 0+800

SHEET NO.
C4-6

SARGO PRODUCTS • NEW HOPE, MINNESOTA
 REPRODUCED BY PART NUMBER 8552
 DRAWING NUMBER
 EAST 1 98
 126