

TRUNK HIGHWAY NO. 10 AND NO.169 WATERMAIN

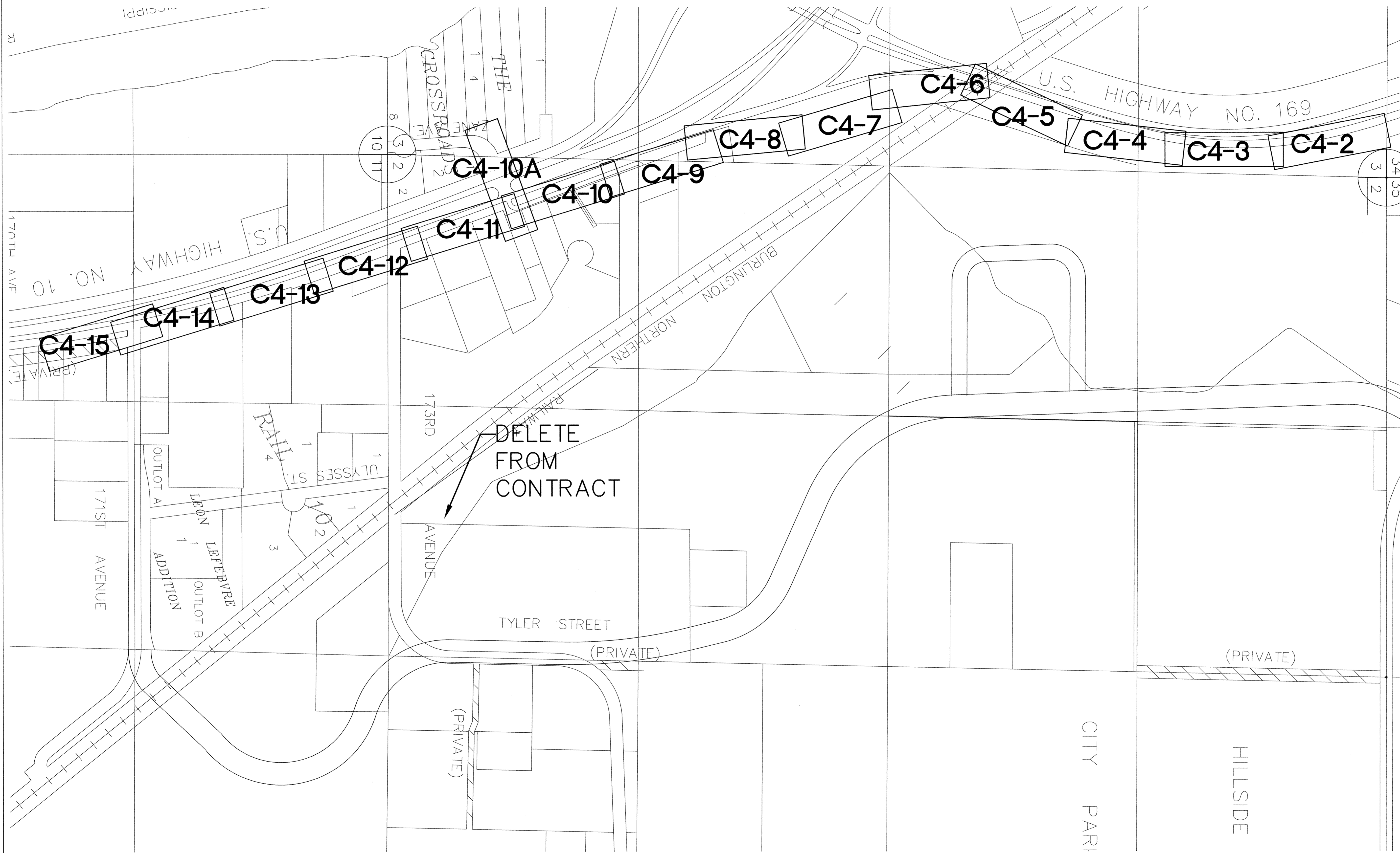

minnesota
METRIC

0 100
1:3000

DESIGNED BY: AB JOB DATE: MARCH 1998
 DRAWN BY: *agf* JOB NUMBER: 800110J
 APPROVED: _____ CAD DATE: _____
 CAD FILE: October 14, 1998 10:59:01 a.m.
 800110j\Drawgs\MISC\L04.DWG

I HEREBY CERTIFY THAT THIS PLAN, SPECIFICATION,
 OR REPORT WAS PREPARED BY ME OR UNDER MY DIRECT
 SUPERVISION AND THAT I AM A DULY REGISTERED
 PROFESSIONAL ENGINEER UNDER THE LAWS OF THE
 STATE OF MINNESOTA.

DATE: 10/15/98 REG. NO.: 15316

NO.	DATE	BY	REVISION DESCRIPTION

Howard R. Green Company
 CONSULTING ENGINEERS

1326 ENERGY PARK DRIVE
 ST. PAUL, MINNESOTA 55108
 (612) 644-4389

CITY OF ELK RIVER
 EASTERN AREA
 PHASE I IMPROVEMENTS

STREET AND UTILITY IMPROVEMENTS
 LOCATION MAP
 TRUNK HIGHWAY NO. 10 AND NO. 169

SHEET NO.
C4-1

EASTE 198
 SACO PRODUCTS • NEW HOPKINS, MINNESOTA
 REORDER BY PART NUMBER 6582
 12/1