

Call 48 Hours before digging:
GOPHER STATE ONE CALL
 Twin City Area 651-454-0002
 Mn. Toll Free 1-800-252-1166

GENERAL NOTES:

- RADIUS TO BE TYPE B618 CURB AND GUTTER WITH 5 FOOT TRANSITION FROM SURMOUNTABLE CURB PER CITY OF ELK RIVER STANDARDS.
- TYPE B618 CURB & GUTTER SHALL BE CONSTRUCTED AT ALL INTERSECTIONS AND CATCH BASINS.
- 48.09 = 848.09
- RADIUS TO BE B618 C. & G. AS PER ELK RIVER DETAIL 2000 (TYP.)
- ALL RADI TO BE 20' BOC UNLESS OTHERWISE NOTED
- STEEL ADJUSTING RINGS SHOULD BE USED FOR MANHOLE ADJUSTMENTS PRIOR TO WEAR COURSE PLACEMENT AND SHOULD BE TYPE R-1979.
- ★ DENOTES GUTTER LINE ELEVATION AT INTERSECTIONS

CASTING NOTE:

ALL CATCH BASIN CASTINGS IN CURB SHALL BE SUMPED 0.10 FEET AND MANHOLE CASTINGS IN PAVED AREAS SHALL BE SUMPED 0.05 FEET. RIM ELEVATIONS ON PLAN PROFILES REFLECT THE SUMPED ELEVATIONS.

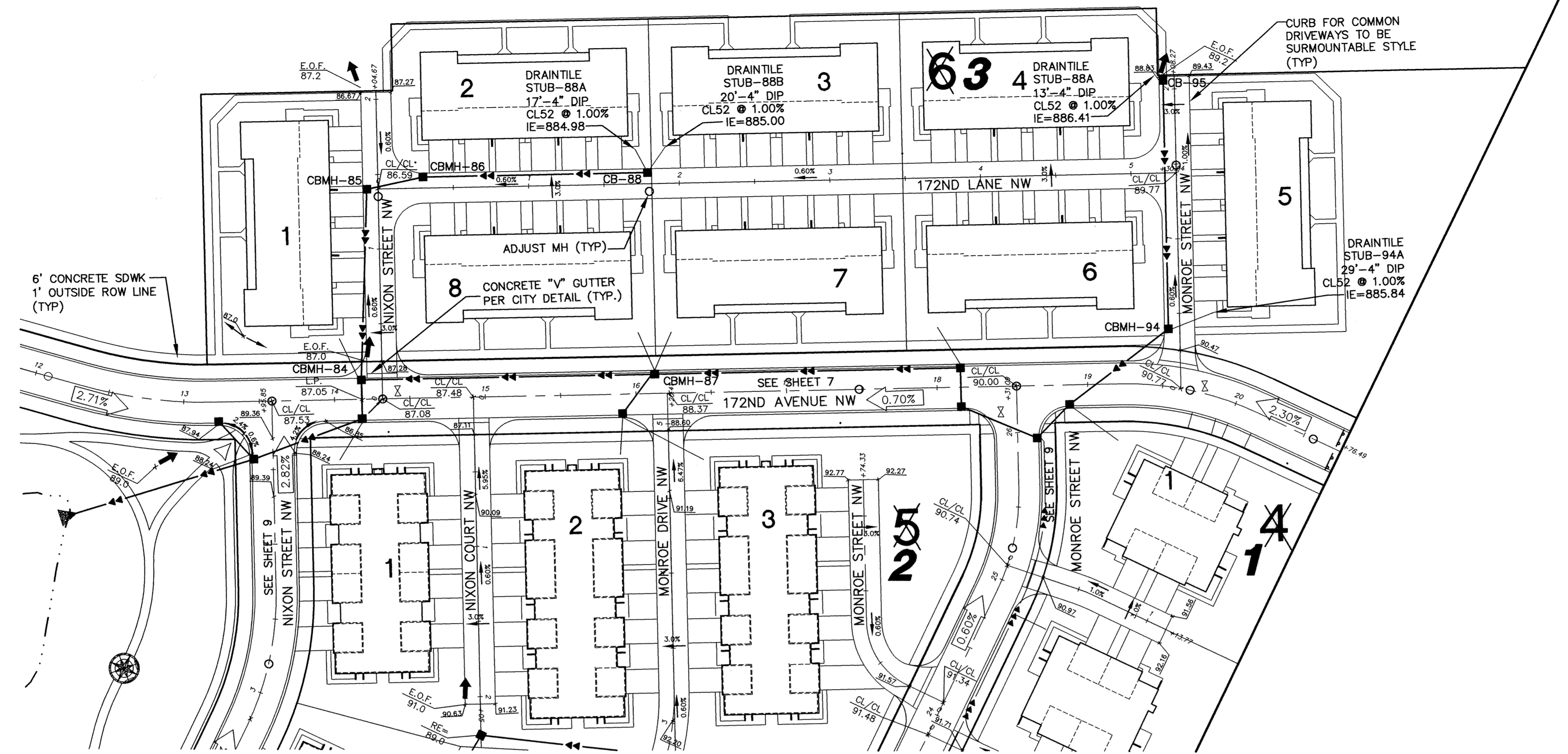

Nixon Street NW

172nd Lane NW

Monroe Street NW

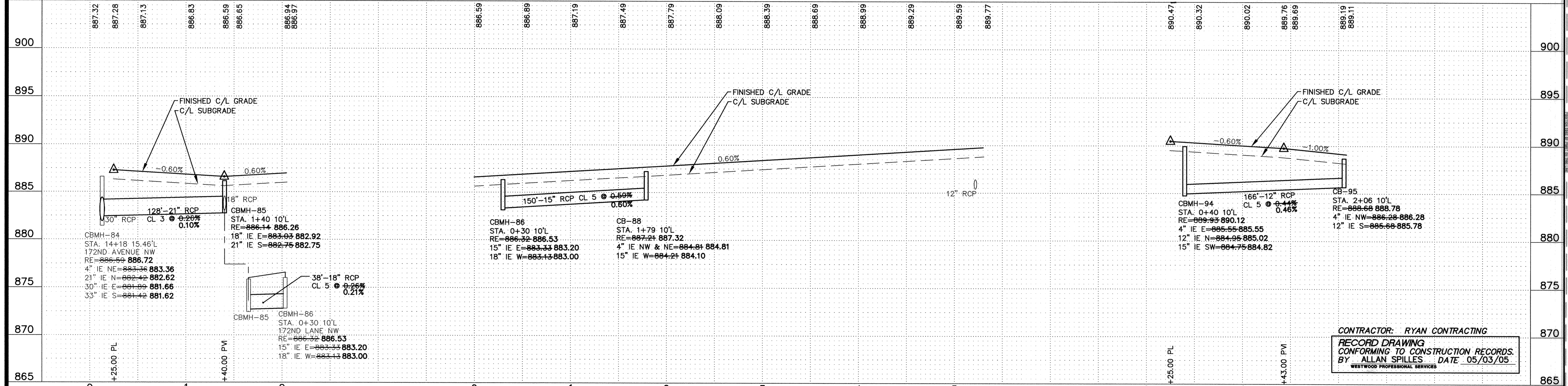

LATEST REVISION DATE: 05/03/05
 Date: 12/01/03 Sheet: 8 OF 14

CONTRACTOR: RYAN CONTRACTING
 RECORD DRAWING CONFORMING TO CONSTRUCTION RECORDS.
 BY ALLAN SPILLES DATE 05/03/05
 WESTWOOD PROFESSIONAL SERVICES

Prepared for: