

- GENERAL NOTES:**
- RADIUS TO BE TYPE B618 CURB AND GUTTER WITH 5 FOOT TRANSITION FROM SURMOUNTABLE CURB PER CITY OF ELK RIVER STANDARDS.
 - TYPE B618 CURB & GUTTER SHALL BE CONSTRUCTED AT ALL INTERSECTIONS AND CATCH BASINS.
 - 48.09 = 848.09
 - RADIUS TO BE B618 C. & G. AS PER ELK RIVER DETAIL 2000 (TYP.)
 - ALL RADII TO BE 20' BOC UNLESS OTHERWISE NOTED
 - STEEL ADJUSTING RINGS SHOULD BE USED FOR MANHOLE ADJUSTMENTS PRIOR TO WEAR COURSE PLACEMENT AND SHOULD BE TYPE R-1979.
 - 11.90 * DENOTES GUTTER LINE ELEVATION AT INTERSECTIONS

CASTING NOTE:
 ALL CATCH BASIN CASTINGS IN CURB SHALL BE SUMPED 0.10 FEET AND MANHOLE CASTINGS IN PAVED AREAS SHALL BE SUMPED 0.05 FEET. RIM ELEVATIONS ON PLAN PROFILES REFLECT THE SUMPED ELEVATIONS.

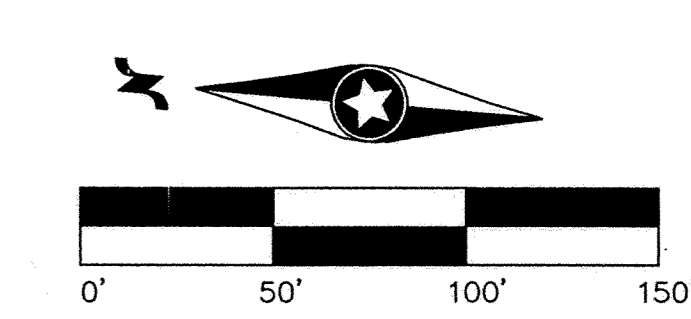

Olson Drive NW

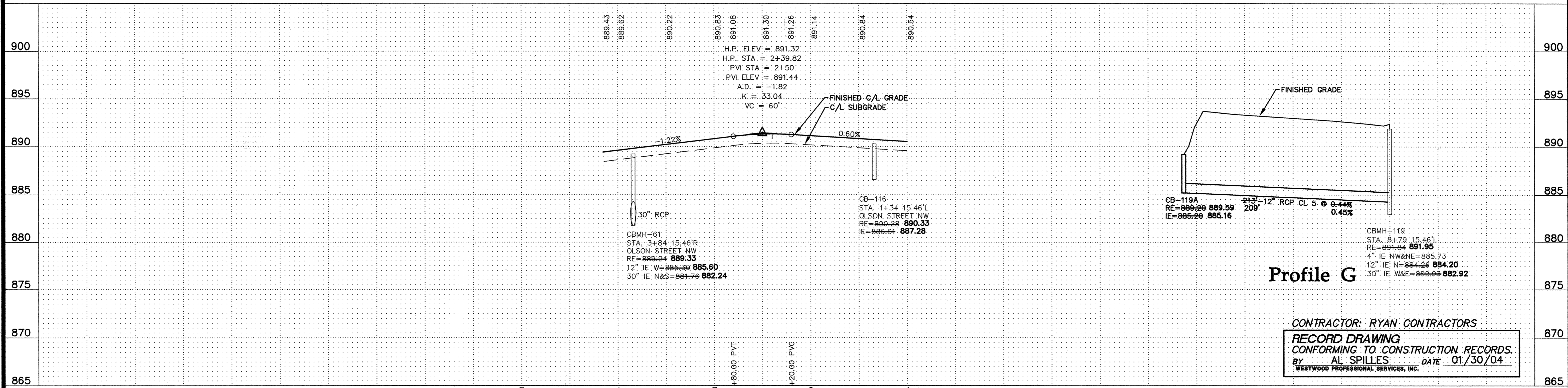

P:\20021058.dwg ASBULLT_20021058ST03.dwg 12/03/2004 10:36:15 AM CST

Westwood Professional Services, Inc.
 7599 Anagram Drive
 Eden Prairie, MN 55344
 Phone: 952/937-5150 Fax: 952/937-5822

I hereby certify that this plan was prepared by me or under my direct supervision and that I am a duly licensed PROFESSIONAL ENGINEER under the laws of the State of Minnesota.

Jason M. McCarty
 Date: 01/30/04 License No. 41955

Revisions:

04/02/03 General Comments - CLJ	
05/05/03 City Review - CLJ	
05/21/03 City Review - CLJ	
06/09/03 Docket/Title Stab - CLJ	

01/30/04 RECORD DRAWING (AS)

Designed: JMM
Checked: JMM
Drawn: WH
 Record Drawing by/date: AS 01/30/04

Prepared for:

CENTEX HOMES
 12400 Whitewater Drive, Suite #120
 Minnetonka, Minnesota 55343

Elk River Station Phase I
 Elk River, Minnesota

Storm Sewer and Street Construction Plans
 Olson Drive NW

LATEST REVISION DATE: 06/09/03
 E-8 20021058ST03.DWG
 Date: 03/21/03 Sheet: 9 OF 16