

SAFCO PRODUCTS • NEW JERSEY, MINNESOTA
REPRODUCED BY PART NUMBER 6532
SAFCO PRODUCTS • NEW JERSEY, MINNESOTA
REPRODUCED BY PART NUMBER 6532
SAFCO PRODUCTS • NEW JERSEY, MINNESOTA
REPRODUCED BY PART NUMBER 6532
SAFCO PRODUCTS • NEW JERSEY, MINNESOTA
REPRODUCED BY PART NUMBER 6532

CARSON STREET

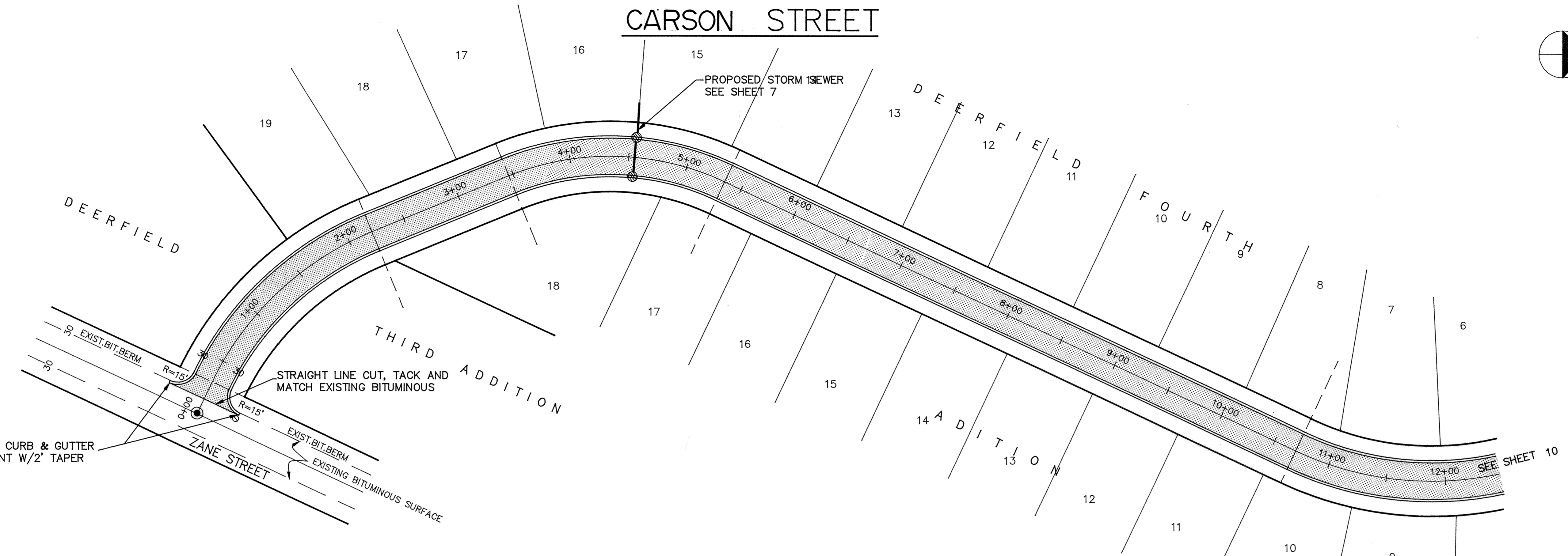

END CONCRETE CURB & GUTTER
AT RADIUS POINT W/2" TAPER
SECTION

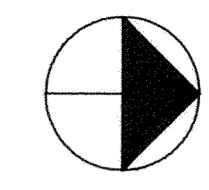
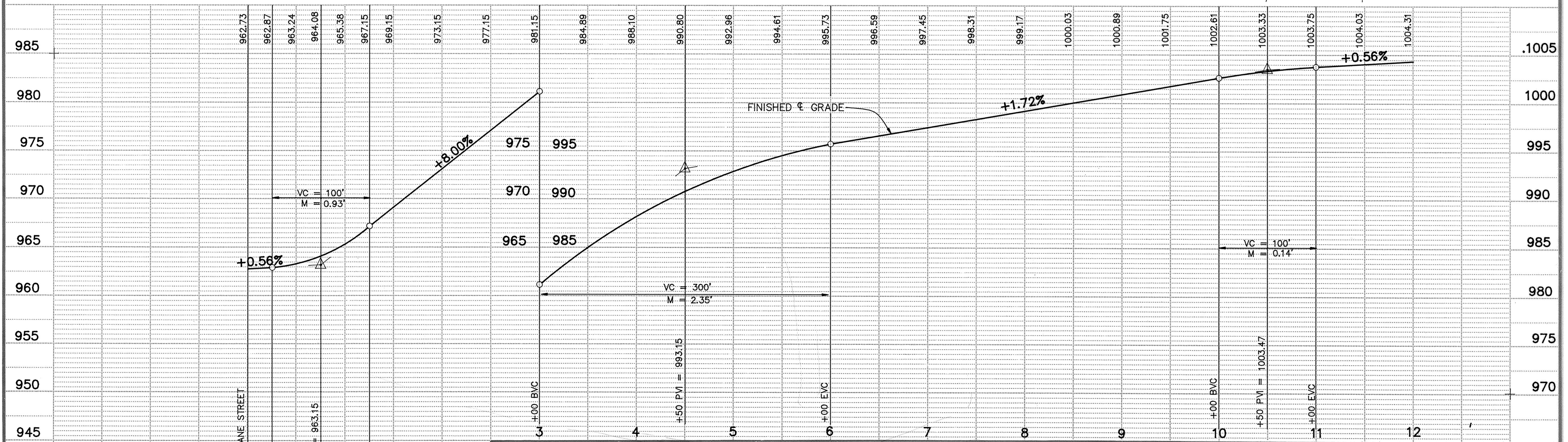

I HEREBY CERTIFY THAT THIS PLAN, SPECIFICATION, OR REPORT WAS PREPARED BY ME OR UNDER MY DIRECT SUPERVISION AND THAT I AM A DULY REGISTERED PROFESSIONAL ENGINEER UNDER THE LAWS OF THE STATE OF MINNESOTA.

Serry J. Maier
DATE: 8/21/89 REG. NO. 15316

MSA CONSULTING ENGINEERS
Maier Stewart & Associates Inc.
1959 SLOAN PLACE (612) 774-6021 ST. PAUL, MINNESOTA 55117

REVISIONS	DATE	DESCRIPTION

DESIGNED _____
CHECKED _____
DRAWN *gjb*
GRAPHIC SCALE
0 HORIZ. 50
0 VERT. 5
DATE JULY, 1989 SHEET 9 OF 16 SHEETS PROJECT NO. 230-073