

DODGE STREET

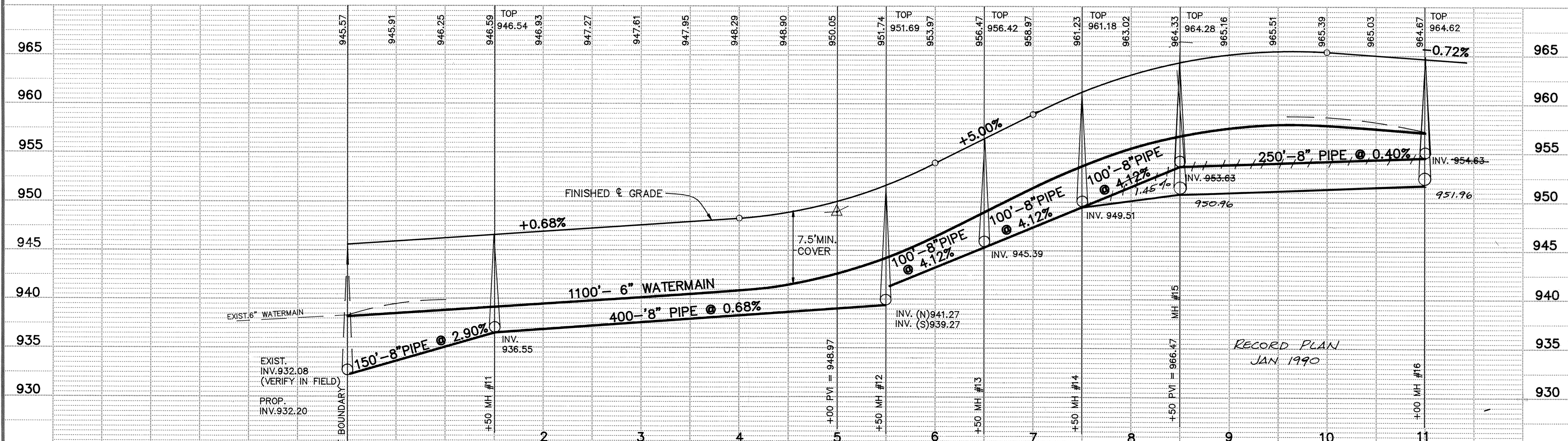
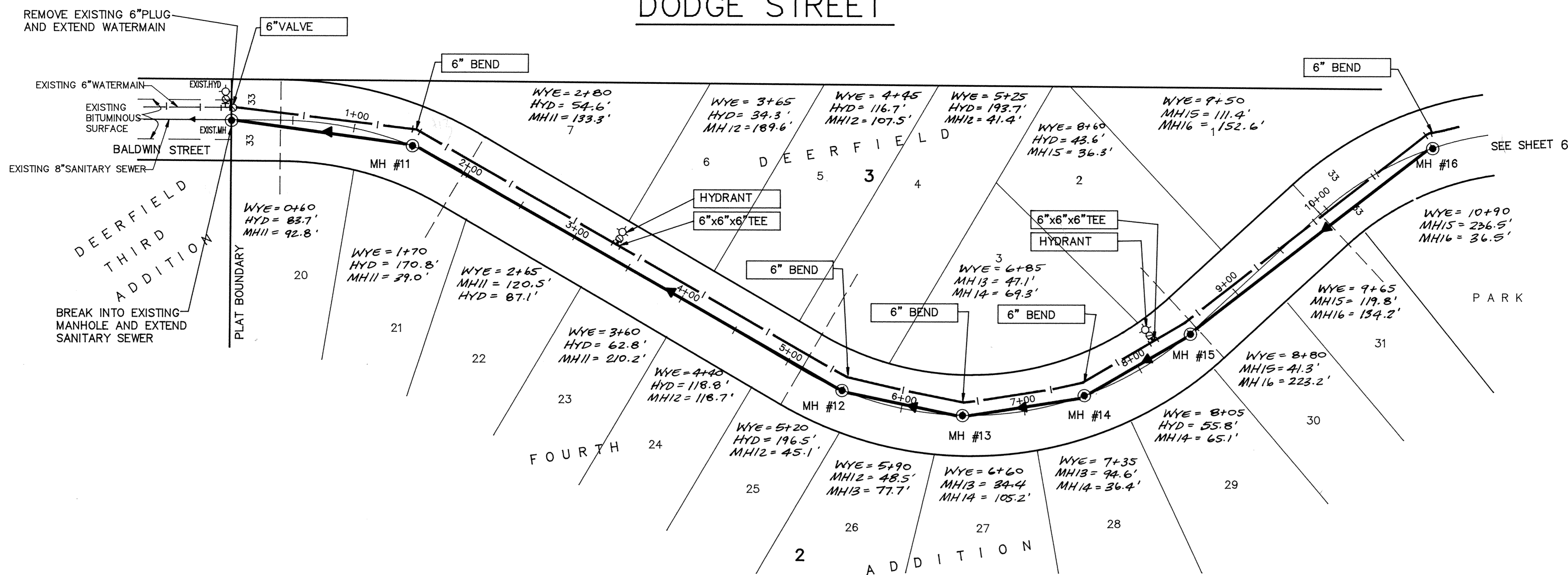
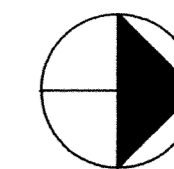

I HEREBY CERTIFY THAT THIS PLAN, SPECIFICATION, OR REPORT WAS PREPARED BY ME OR UNDER MY DIRECT SUPERVISION AND THAT I AM A DULY REGISTERED PROFESSIONAL ENGINEER UNDER THE LAWS OF THE STATE OF MINNESOTA.

Terry Maurer
 DATE 8/21/87 REG. NO. 15316

Maier Stewart & Associates Inc.
 CONSULTING ENGINEERS
 1959 SLOAN PLACE (612)774-6021 ST. PAUL, MINNESOTA 55117

DATE	DESCRIPTION	DESIGNED	CHECKED

CITY OF ELK RIVER
 SANITARY SEWER AND WATERMAIN
 DODGE STREET

DATE JULY, 1988 SHEET 5 OF 16 SHEETS PROJECT NO. 230-073

ER073-7

DRAWING NUMBER
 DEERFIELD

DRAWING NUMBER
 DEERFIELD

DRAWING NUMBER
 DEERFIELD

DRAWING NUMBER
 DEERFIELD