

# CSAH 13

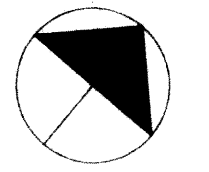

□ DENOTES NEW BITUMINOUS.

SEE SHEET 4

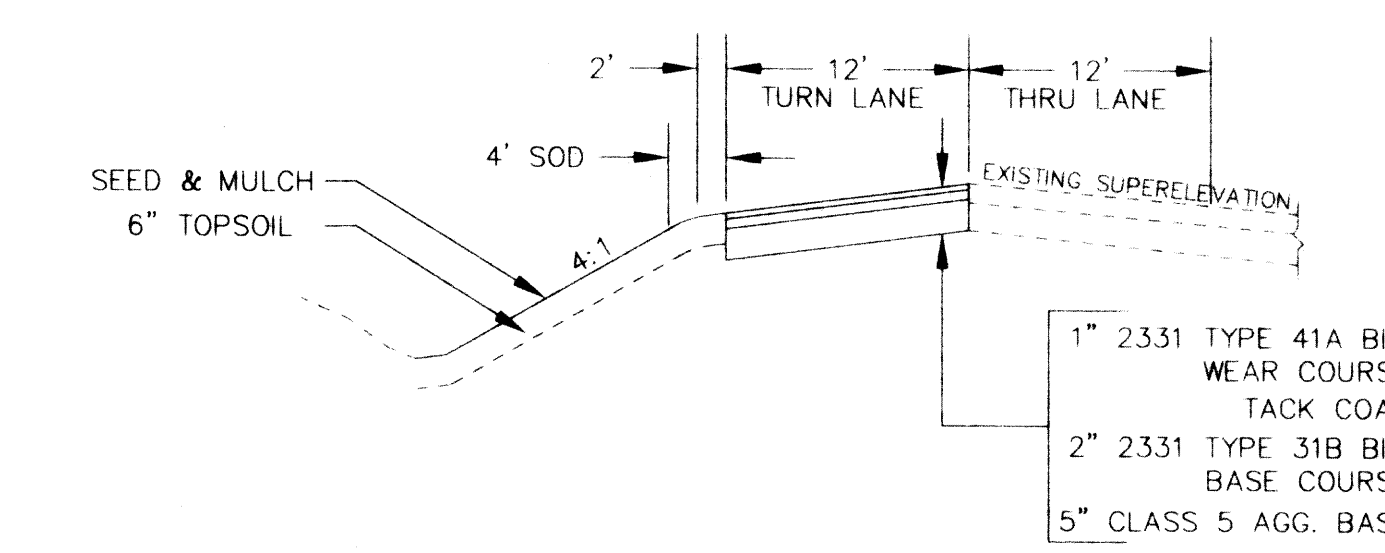
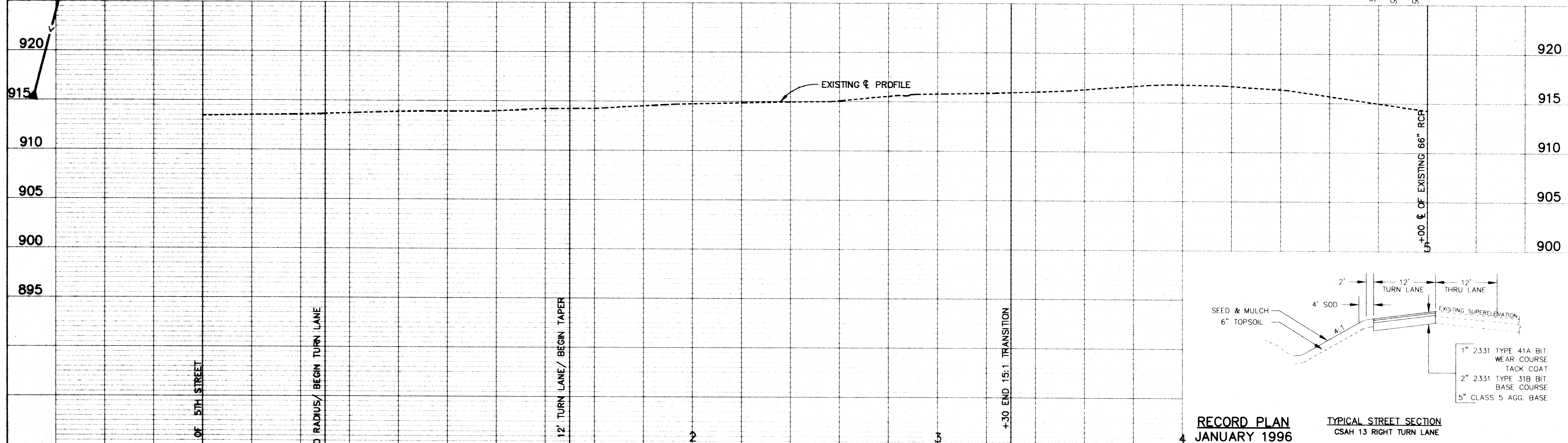
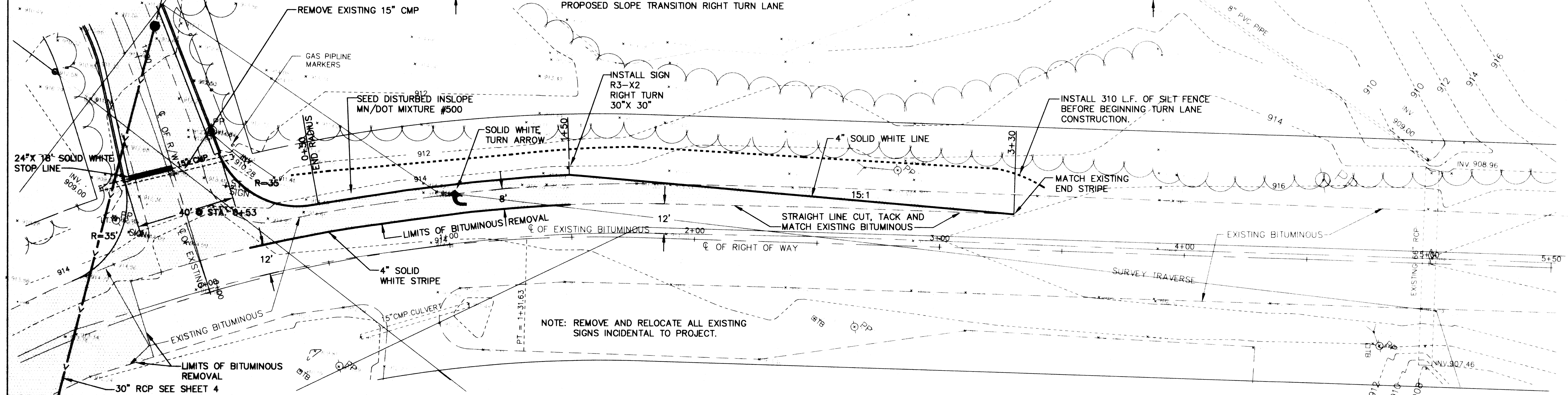
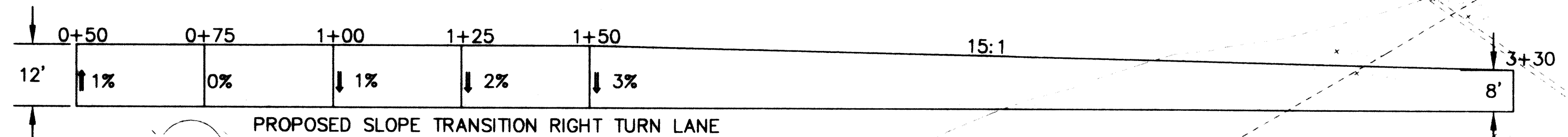

**RECORD PLAN**  
JANUARY 1996

**TYPICAL STREET SECTION**  
CSAH 13 RIGHT TURN LANE

**CITY OF ELK RIVER**  
RIGHT TURN LANE  
CSAH 13

I HEREBY CERTIFY THAT THIS PLAN, SPECIFICATION, OR REPORT WAS PREPARED BY ME OR UNDER MY DIRECT SUPERVISION AND THAT I AM A DULY REGISTERED PROFESSIONAL ENGINEER UNDER THE LAWS OF THE STATE OF MINNESOTA.  
*Greg J. Manner*  
DATE 5/12/94 REG. NO. 15316



1326 ENERGY PARK DRIVE  
ST. PAUL, MINNESOTA 55108  
(612) 644-4389  
  
9800 SHELARD PARKWAY  
MINNEAPOLIS, MINNESOTA 55441  
(612) 546-0432

REVISIONS	DATE	DESCRIPTION

DESIGNED	DEN
CHECKED	
DRAWN	IPC
GRAPHIC SCALE	
	HORIZ 20
	VERT 5

DATE	APR. 1994	SHEET	3 OF 11 SHEETS	PROJECT NO.	230-211
------	-----------	-------	----------------	-------------	---------