

SHERBURNE COUNTY CITY OF ELK RIVER C.S.A.H. NO. 1 IMPROVEMENTS

M.S.A.S. S.A.P. 71-601-13
M.S.A.P. 204-020-01 (SIDEWALK)

BETWEEN 6TH STREET AND CO. ROAD 77

GROSS LENGTH	4684 FEET	0.89 MILES
BRIDGES LENGTH	0 FEET	0 MILES
EXCEPTION LENGTH	0 FEET	0 MILES
NET LENGTH	4684 FEET	0.89 MILES

PLAN 1" = 20'

SCALES: PROFILE HOR. 1" = 20'
VERT. 1" = 5'

CROSS SECTIONS HOR. 1" = 10'
VERT. 1" = 5'

PLAN SYMBOLS

SECTION LINE	---
QUARTER LINE	- - - -
SIXTEENTH LINE	- . - . - .
RIGHT OF WAY LINE	=====
PROPERTY LINE	-----
CENTER LINE	- - - - -
FENCE LINE	- x - x -
RIVER OR CREEK	~~~~~
LAKE OR POND	~~~~~
CULVERT	- - - - -
BRIDGE	=====
RETAINING WALL	=====

TREES	
BRUSH OR SHRUBS	
HEDGE	
CONIFERS	
SWAMP	
MAILBOX	
SIGN	

UTILITIES SYMBOLS

SANITARY SEWER	
STORM SEWER	
WATERMAIN	
GAS LINE	
POWER LINE	
MANHOLE	
CATCH BASIN	
VALVE	

HYDRANT	
POWER, TELEPHONE, OR LIGHT POLE	
ANCHOR	
SOIL BORING LOCATION	

PRESENT ADT (YEAR) 6,700 (1990)

PROJECT ADT (YEAR) 13,300 (2010)

SHOULDER WIDTH 2' (URBAN) 6' (RURAL)

DESIGN 9 TON

SOIL FACTOR 50 PROJ. HCA DT (YEAR) 350 (2010)

R-VALUE NA N OR FACTOR NA
18

DESIGN SPEED 30 MPH
DESIGN SPEED NOT ACHIEVED AT:
STA. _____ TO STA. _____ MPH

STOPPING SITE DISTANCE BASED ON:
3.5' HEIGHT OF EYE
0.5' HEIGHT OF OBJECT

FUNCTIONAL CLASSIFICATION HIGH DENSITY ARTERIAL
4 TRAFFIC LANES - NO PARKING LANES

THE 1988 EDITION OF THE MINNESOTA DEPARTMENT
OF TRANSPORTATION "STANDARD SPECIFICATIONS
FOR CONSTRUCTION" SHALL GOVERN.

PROCTOR AVENUE
SANITARY SEWER, WATERMAIN, STREET,
STORM SEWER & SIDEWALK CONSTRUCTION

SECTIONS 28 & 33, T33N, R26W

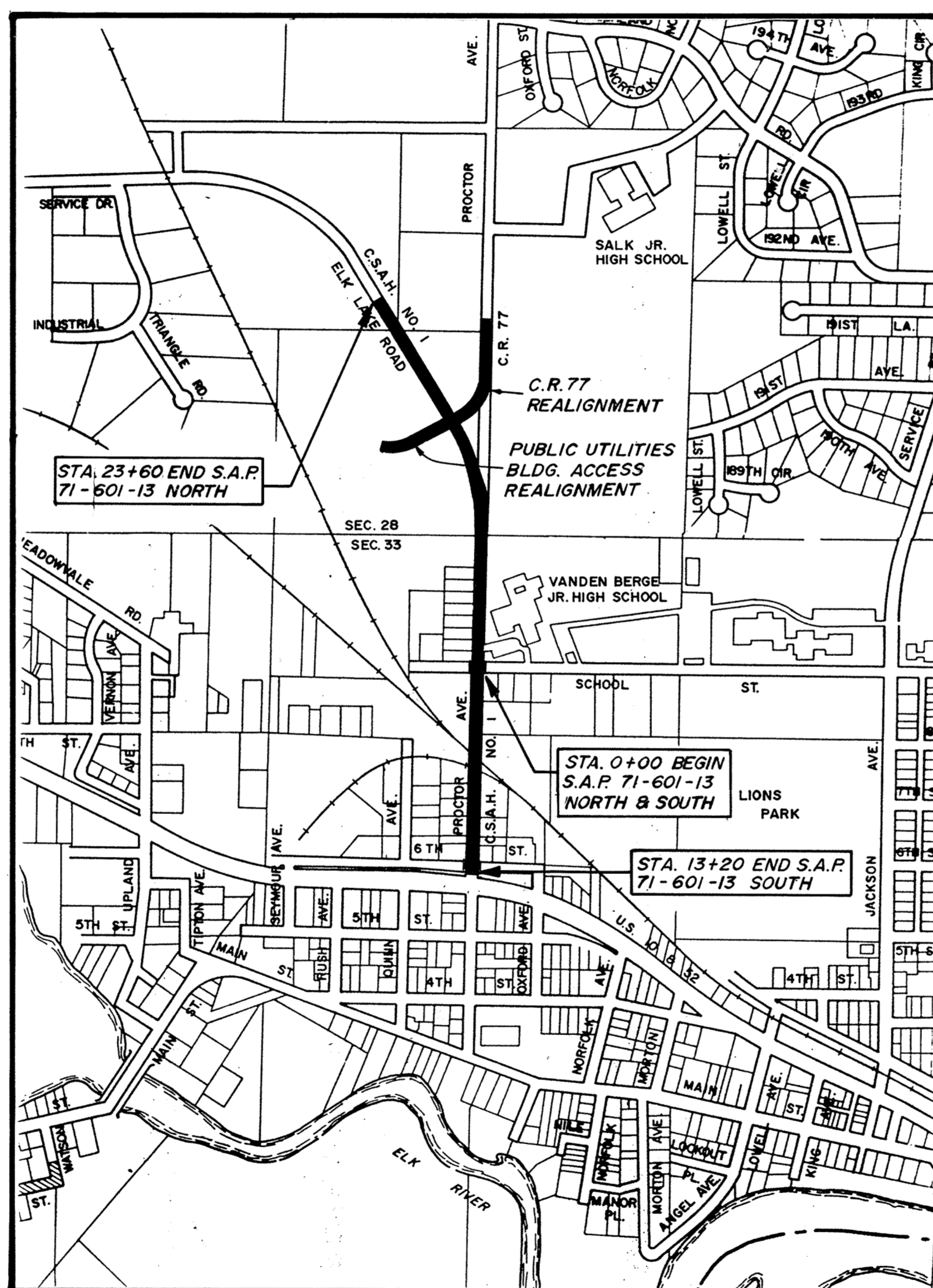

INDEX OF SHEETS

- 1 TITLE SHEET & LAYOUT MAP
- 2 EST. QUANTITY, STREET SECTIONS & NOTES
- 3-7 SANITARY SEWER & WATERMAIN PLAN & PROFILE
- 8 LIONS PARK TO PROCTOR AVE. STORM SEWER
- 9-18 STREET & STORM SEWER PLAN & PROFILE
- 19 SALK JR. HIGH SCHOOL SIDEWALK PLAN & PROFILE
- 20-23 CROSS SECTIONS
- 24 DETOUR PLAN
- 25-28 DETAILS

I HEREBY CERTIFY THAT THIS PLAN, SPECIFICATION, OR
REPORT WAS PREPARED BY ME OR UNDER MY DIRECT
SUPERVISION AND THAT I AM A DULY REGISTERED
PROFESSIONAL ENGINEER UNDER THE LAWS OF THE
STATE OF MINNESOTA.

Terry Maurer
DATE 3/15/91 REG. NO. 1534

RECOMMENDED FOR APPROVAL *[Signature]* March 19, 1991
COUNTY ENGINEER DATE

RECOMMENDED FOR APPROVAL *[Signature]* 4-4-91
DISTRICT STATE AID ENGINEER DATE

RECOMMENDED FOR APPROVAL *[Signature]* 4/23/91
STATE PLANS & SPEC. ENGINEER DATE

APPROVED *[Signature]* 4-23-91
STATE AID DIRECTOR DATE

RECORD PLAN NOV. 1991

PREPARED BY:

MSA CONSULTING ENGINEERS
Maier Stewart & Associates Inc.

SHEET 1 OF 28

SAP 71-601-13

DRAWING NUMBER

DRAWING NUMBER

DRAWING NUMBER

DRAWING NUMBER
1CSAH 91