

- NOTES:
1. ALL DRIVEWAY DISTURBANCES DUE TO THE STORM SEWER INSTALLATION SHALL BE KEPT TO A MINIMUM. THE DRIVEWAYS SHALL BE RECONSTRUCTED TO THEIR EXISTING CONDITIONS OR TO A MINIMUM OF 6-INCHES OF CLASS 5.
 2. CONTRACTOR SHALL BE RESPONSIBLE FOR CONTACTING GOPHER STATE ONE CALL. CONTRACTOR SHALL COORDINATE WITH UTILITY REPRESENTATIVES TO ENSURE THAT THE INTEGRITY OF THE UTILITIES ARE MAINTAINED AND PAY FOR ANY FEES ASSOCIATED WITH THE INSTALLATION WORK.
 3. ANY BITUMINOUS DAMAGED ON TWIN LAKES ROAD, WHICH IS NOT MARKED FOR REMOVAL, SHALL BE REPLACED BY THE CONTRACTOR TO THE SATISFACTION OF THE ENGINEER IN THE FIELD AT NO ADDITIONAL COST TO THE OWNER.
 4. THE TYPICAL SECTION FOR TWIN LAKES ROAD IS 2" WEAR COURSE, 2" BASE COURSE, AND 6" CLASS 5.
 5. CONTRACTOR SHALL FIELD VERIFY STORM SEWER INVERTS ALONG TWIN LAKES ROAD BEFORE ANY WORK IS STARTED.
 6. TEMPORARY PORTABLE PRECAST CONCRETE BARRIER, TYPE F (MNDOT STANDARD PLATE 8337B) SHALL BE INSTALLED AT EACH OPEN EXCAVATION PIT ALONG TWIN LAKES ROAD. PAYMENT FOR ALL BARRIERS SHALL BE INCLUDED IN THE TRAFFIC CONTROL BID ITEM.

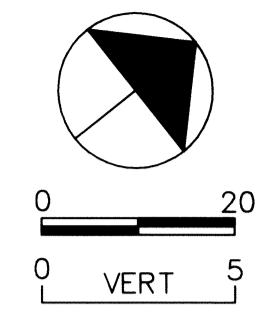

NO.	DATE	BY	DESCRIPTION
1	11/25/10	JA	RECORD DRAWING

I HEREBY CERTIFY THAT THIS PLAN, SPECIFICATION, OR REPORT WAS PREPARED BY ME OR UNDER MY DIRECT SUPERVISION AND THAT I AM A DULY LICENSED PROFESSIONAL ENGINEER UNDER THE LAWS OF THE STATE OF MINNESOTA.
 Print Name: JOHN M. ANDERSON
 Signature: *[Signature]*
 Date: 07-31-08 License # 25889

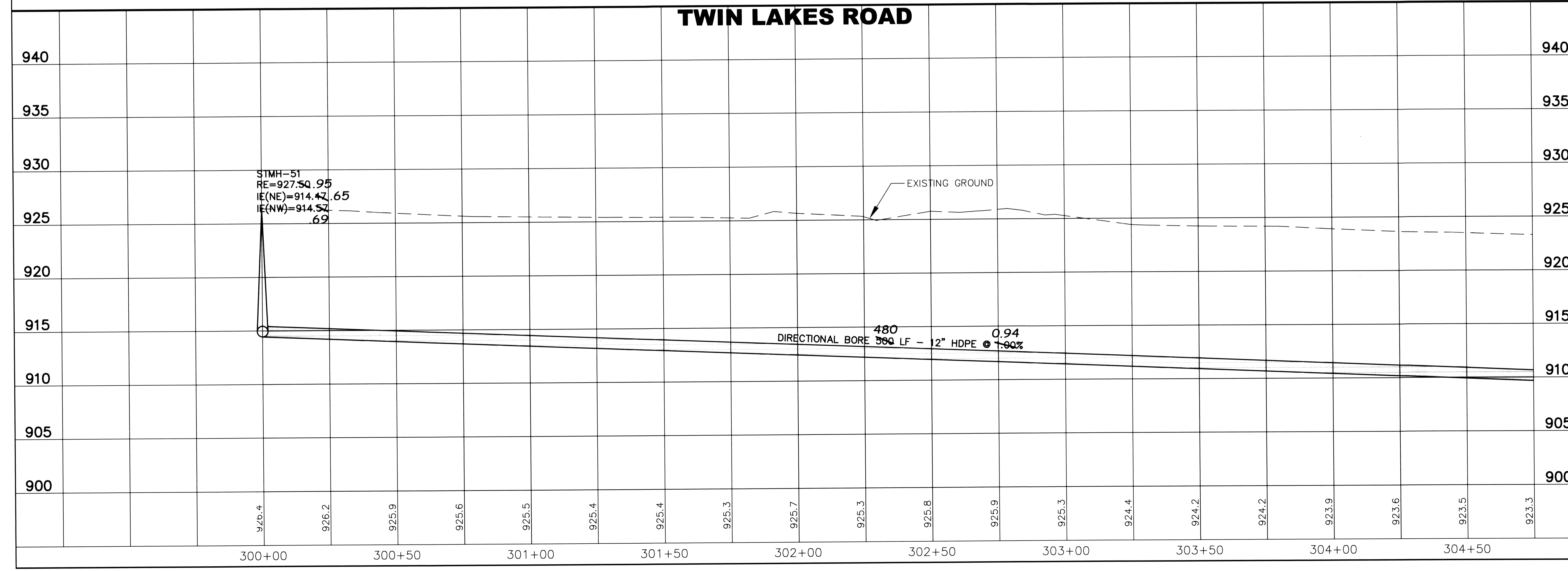

SP 204-104-07
CITY OF ELK RIVER
193RD AVENUE STREET CONSTRUCTION
STREET AND STORM SEWER
TWIN LAKES ROAD
RECORD PLAN
 300+00 TO 304+50

BDM
 CONSULTING ENGINEERS, PLC
 Engineers and Surveyors
 11040 183rd Circle NW
 Elk River, MN 55330
 Phone: (763) 441-0877
 Fax: (763) 441-7724
 bdmce.com

DRAWN BY: NAB
 CHECKED BY: KJE
 DESIGNED BY: KJE
 JOB NO. 226069D

SHEET **54** SHEETS **146**