

ABBREVIATIONS

FOR PLANS AND UTILITIES SYMBOLS SEE TECHNICAL MANUAL

3-2 (e-g)	SIGNAL PHASE "3" - NO. "2"	GRTA	GREEN RIGHT TURN ARROW	R	RED
BL	BLUE	GTHA	GREEN THRU ARROW	R & S	REMOVE AND SALVAGE
BL/BLK	BLUE WITH BLACK TRACER	HH	HANDHOLE	R/BLK	RED WITH BLACK TRACER
BLK	BLACK	HPS	HIGH PRESSURE SODIUM	RLTA	RED LEDT TURN ARROW
BR.GR.CH.SW.	BLACK WITH WHITE TRACER	IMC	INTERMEDIATE METAL CONDUIT	RSC	RIGID STEEL CONDUIT
CLR	CLEAR	JB	JUNCTION BOX	SOP	SOURCE OF POWER
D2-1 (e-g)	DETECTOR PHASE "2" - NO. "1"	LUM	LUMINAIRE	SPR	SPARE
DWK	DON'T WALK	NEU	NEUTRAL	ST LHT	STREET LIGHT
EQ.G	EQUIPMENT GROUND	NMC	NONMETALIC CONDUIT	STA	STATION
EVP	EMERGENCY VEHICLE PRE-EMPTION	O	ORANGE	SW	SWITCH
F & I	FURNISH AND INSTALL	O/BLK	ORANGE WITH BLACK TRACER	SWD	SWITCHED
FL	FLASH/FLASHING	PI-1 (e-g)	PEDESTRIAN INDICATIONS PHASE "1" - NO. "1"	TDW	TELEPHONE DROP WIRE
G	GREEN	PB	PUSH BUTTON	WH	WHITE
G/BLK	GREEN WITH BLACK TRACER	PB2-1(e-g)	PUSH BUTTON PHASE "2" - NO. "1"	WH/BLK	WHITE WITH BLACK TRACER
GLTA	GREEN LEFT TURN ARROW	PEC	PHOTOELECTRIC CELL	WLK	WALK
GRN	GREEN	PED	PEDESTRIAN	YEL	YELLOW
GR. R.	GROUND ROD			YLTA	YELLOW LEFT TURN ARROW
				YRTA	YELLOW RIGHT TURN ARROW

STANDARD PLATES - SIGNAL SYSTEMS

THE FOLLOWING STANDARD PLATES, APPROVED BY THE FEDERAL HIGHWAY ADMINISTRATION, SHALL APPLY ON THIS PROJECT

PLATE NO.	DESCRIPTION
* 7036 D	PEDESTRIAN CURB RAMP
* 8110 C	TRAFFIC SIGNAL BRACKETING
* 8111 B	TRAFFIC SIGNAL BRACKETING
* 8112 C	PEDESTAL FOUNDATION
8113 C	MAGNETIC VEHICLE DETECTOR INSTALLATION
* 8115 C	PEDESTRIAN PUSH BUTTON INSTALLATION
8117 F	PRECAST CONCRETE HANDHOLE OR PULLBOX
8118 C	SERVICE EQUIPMENT AND POLE
* 8119 C	GROUND MOUNTED CABINET FOUNDATION
8120 K	PA-85 POLE FOUNDATION
* 8121 D	TRANSFORMER BASE AND POLE BASE PLATE
* 8122 C	PEDESTAL AND PEDESTAL BASE
* 8123 D	POLE AND MAST ARM
* 8124 D	MAST ARM SIGNAL HEAD MOUNTS
* 8126 F	POLE FOUNDATION (PA-90 AND PA-100)
8127 B	LIGHT BASE - DESIGN E
8128 B	LIGHT BASE - DESIGN H
* 8130 D	SAWCUT LOOP DETECTORS
8140 A	ROADWAY LIGHTING SERVICE CABINET (PAD MOUNTED)

* STANDARD PLATES APPLICABLE TO THIS PROJECT

SYMBOLS

	EQ.G CONNECTION
	EVP DETECTOR DIRECTION
	LUMINAIRE NO.
	SIGNAL BASE NO.
	SIGNAL/FLASHER FACE NO.
	SPLICE

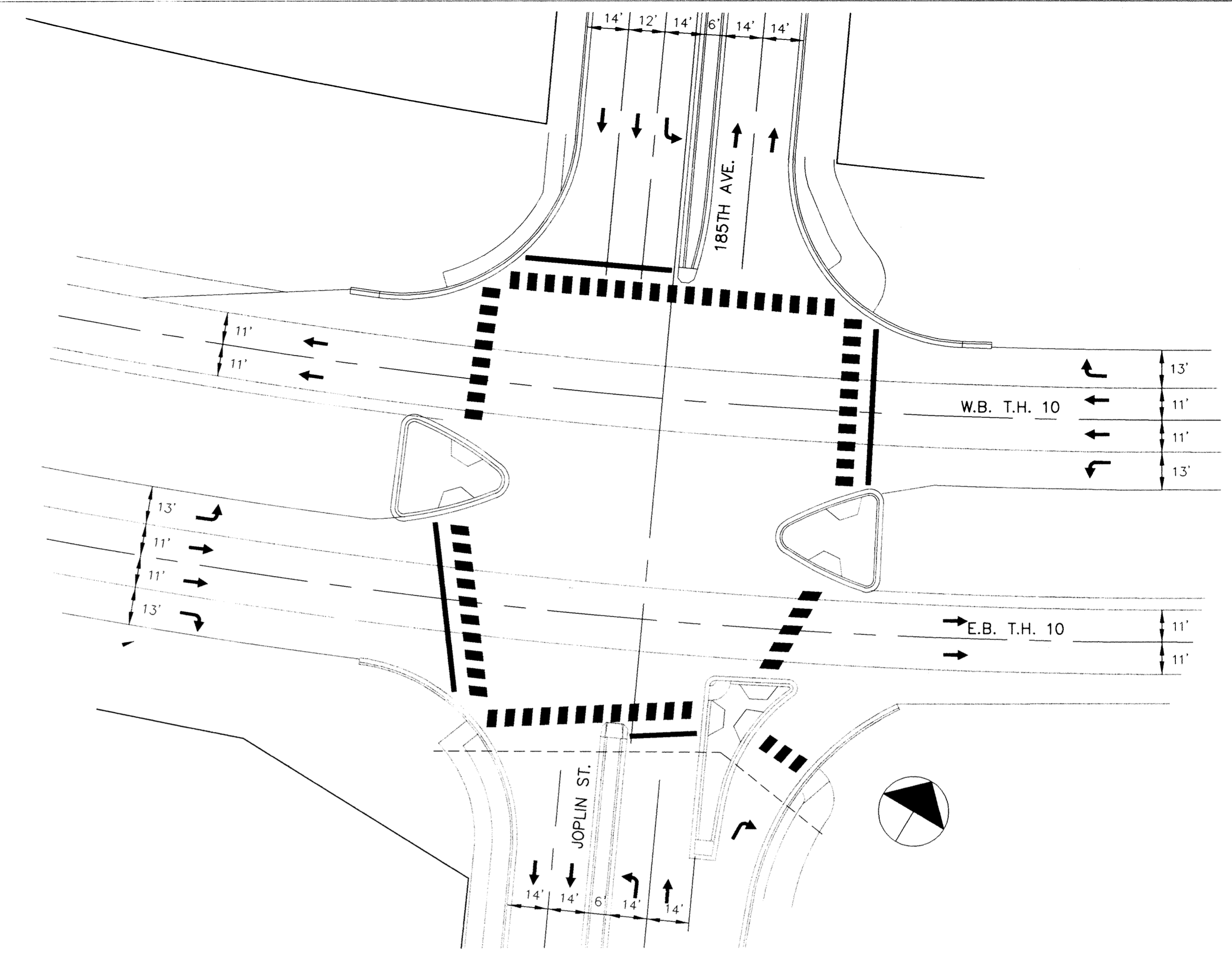

CROSSWALK MARKINGS LAYOUT

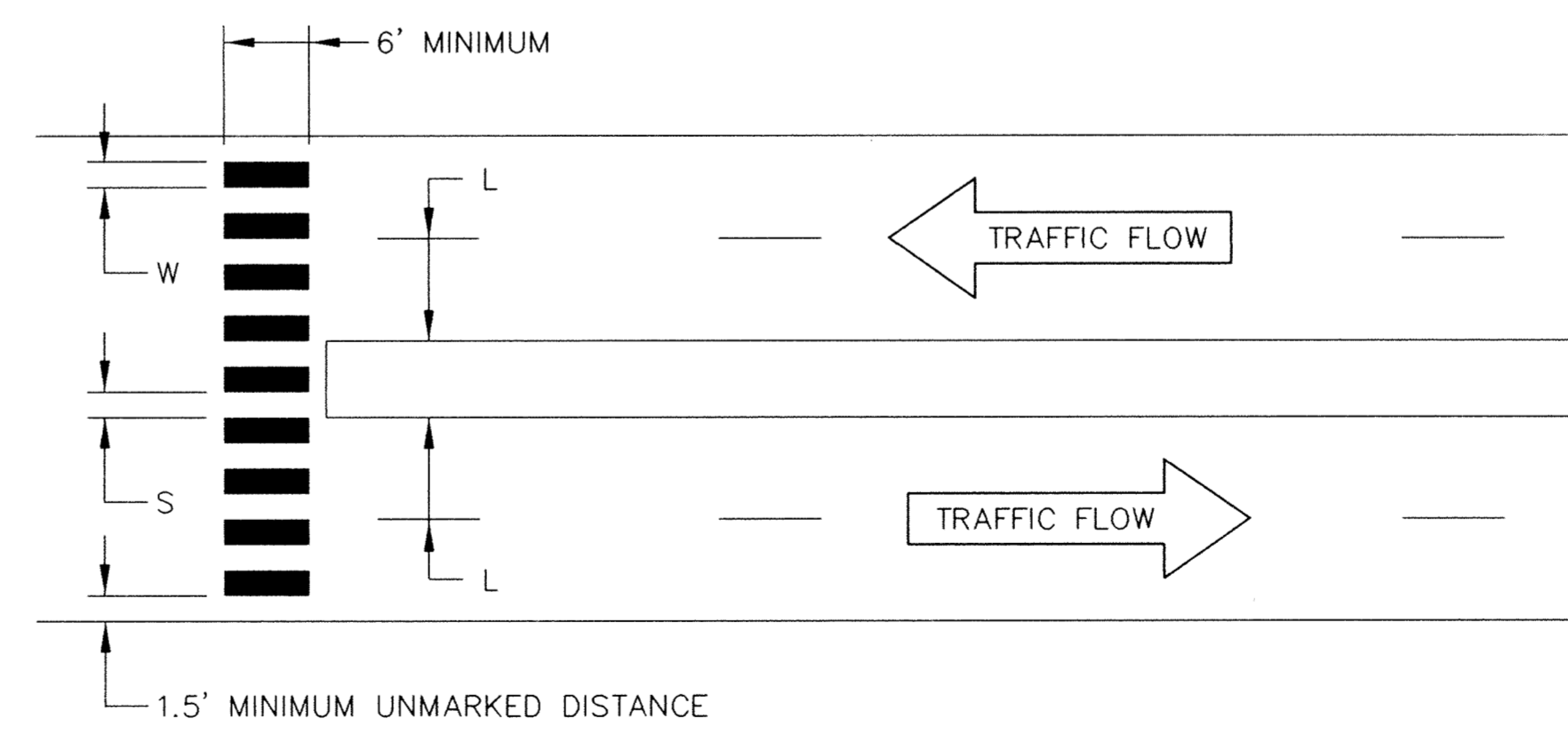

WIDTH OF INSIDE LANE (L)	WIDTH OF TAPED AREA (W)	WIDTH OF SPACE (S)
9'	2.0'	2.5'
10'	2.5'	2.5'
11'	2.5'	3.0'
12'	3.0'	3.0'
13'	3.0'	3.5'

- NOTES:
1. TAPED AREAS TO BE CENTERED AND ALIGNED ON CENTER LINE AND LANE LINES. MAKE ADJUSTMENTS IN MEDIAN AREA.
 2. ZEBRA CROSSWALKS REQUIRE REFLECTORIZED WHITE POLYMER PREFORMED TAPE.
 3. A MINIMUM OF 1.5 FT. CLEAR DISTANCE MUST BE LEFT ADJACENT TO CURB. IF LAST TAPED AREA FALLS INTO THIS DISTANCE, IT MUST BE OMITTED.
 4. FURNISHING AND INSTALLING PEDESTRIAN MARKINGS SHALL BE INCIDENTAL TO THE SIGNAL SYSTEM.
 5. REMOVE ALL CONFLICTING PAVEMENT MARKINGS AS DIRECTED BY THE ENGINEER.

CROSSWALK DETAIL

<p>I HEREBY CERTIFY THAT THIS PLAN, SPECIFICATION, OR REPORT WAS PREPARED BY ME OR UNDER MY DIRECT SUPERVISION AND THAT I AM A DULY REGISTERED PROFESSIONAL ENGINEER UNDER THE LAWS OF THE STATE OF MINNESOTA.</p> <p><i>George M. Attempky</i></p> <p>DATE 12/15/95 REG NO. 21849</p>	<p>MSA CONSULTING ENGINEERS</p> <p>1326 ENERGY PARK DRIVE ST. PAUL, MINNESOTA 55108 (612) 644-4389</p> <p>5075 WAYZATA BLVD. SUITE #225 MINNEAPOLIS, MINNESOTA 55416 (612) 546-0432</p>	<p>DESIGNED GMS</p> <p>CHECKED</p> <p>DRAWN JL</p>	<p>CITY OF ELK RIVER TRAFFIC CONTROL SIGNAL SYSTEM CROSSWALK DETAILS T.H. 10 AT JOPLIN AVE./185TH AVE.</p>
		<p>GRAPHIC SCALE</p> <p>0 N/A</p> <p>0 VERT N/A</p>	