

SDCO PRODUCTS • NEW HOPKINS, MINNESOTA  
REORDER BY PART NUMBER 8582  
MINNESOTA BOARD OF PROFESSIONAL ENGINEERS

SEE SHEET FOR STREET CONSTRUCTION

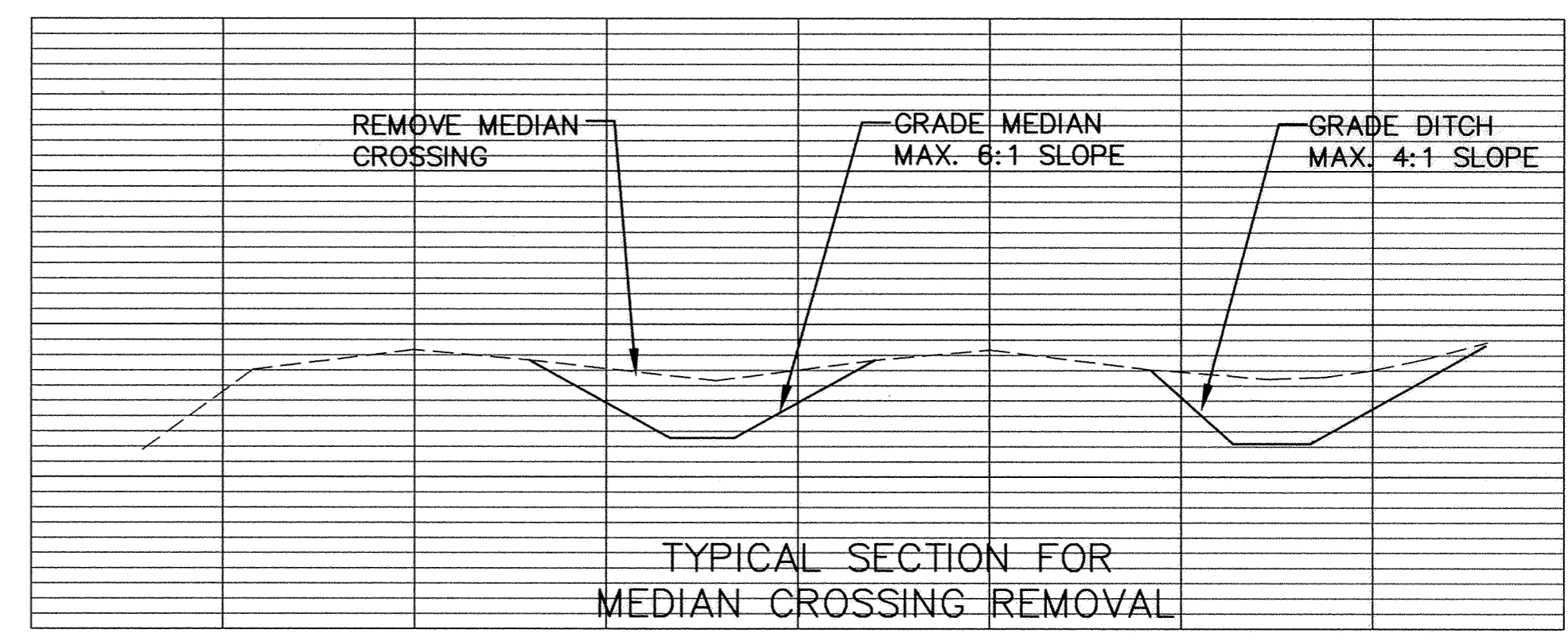
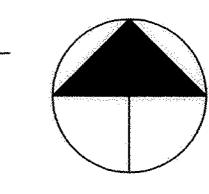
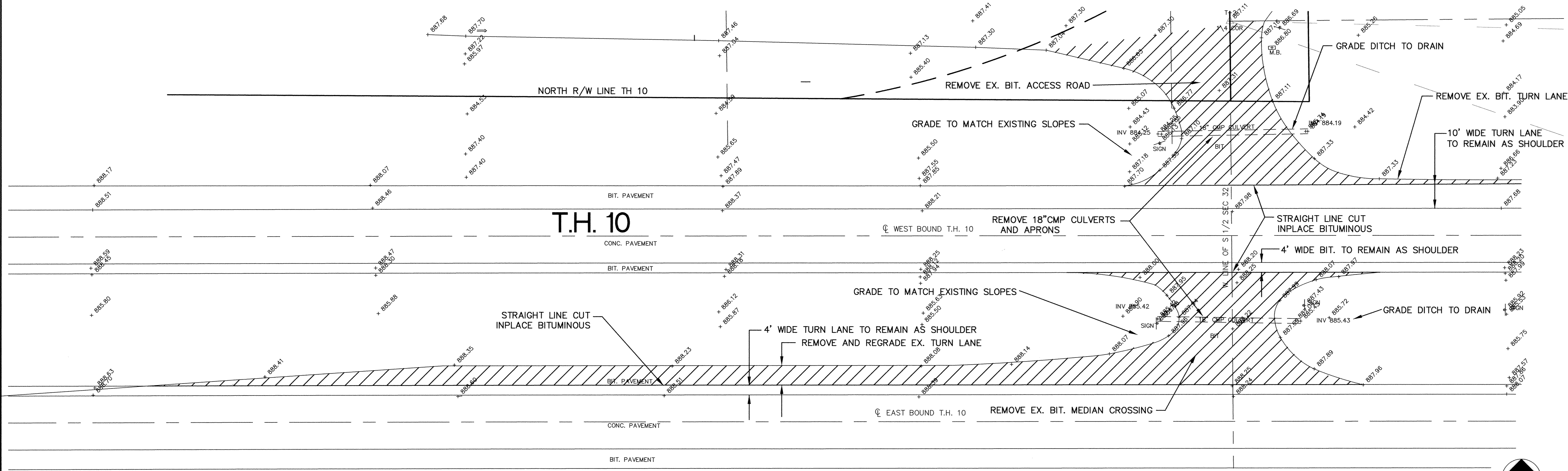

RECORD DRAWING  
OCTOBER 1997

I HEREBY CERTIFY THAT THIS PLAN, SPECIFICATION, OR REPORT WAS PREPARED BY ME OR UNDER MY DIRECT SUPERVISION AND THAT I AM A DULY REGISTERED PROFESSIONAL ENGINEER UNDER THE LAWS OF THE STATE OF MINNESOTA.  
*Gregory J. Maurer*  
DATE 3/29/96 REG. NO. 15316



1326 ENERGY PARK DRIVE  
ST. PAUL, MINNESOTA 55108  
(612) 644-4389  
5075 WAYZATA BLVD. SUITE #225  
MINNEAPOLIS, MINNESOTA 55416  
(612) 546-0432

DATE	DESCRIPTION	DESIGNED	CHECKED

GRAPHIC SCALE  
0 20  
0 VERT. 5

CITY OF ELK RIVER  
185TH AVENUE  
STREET CONSTRUCTION  
CLOSING OF FRONTAGE ROAD ACCESS AT NAPLES ST.  
S.P. 7102-87 (TH 10)  
DATE JAN 1996 SHEET 25 OF 41 SHEETS PROJECT NO. 230-277