

SDCO PRODUCTS • NEW HARB, MINNESOTA
MEMBER BY PART NUMBER 0502
SDCO PRODUCTS • NEW HARB, MINNESOTA
MEMBER BY PART NUMBER 0502
SDCO PRODUCTS • NEW HARB, MINNESOTA
MEMBER BY PART NUMBER 0502
SDCO PRODUCTS • NEW HARB, MINNESOTA
MEMBER BY PART NUMBER 0502

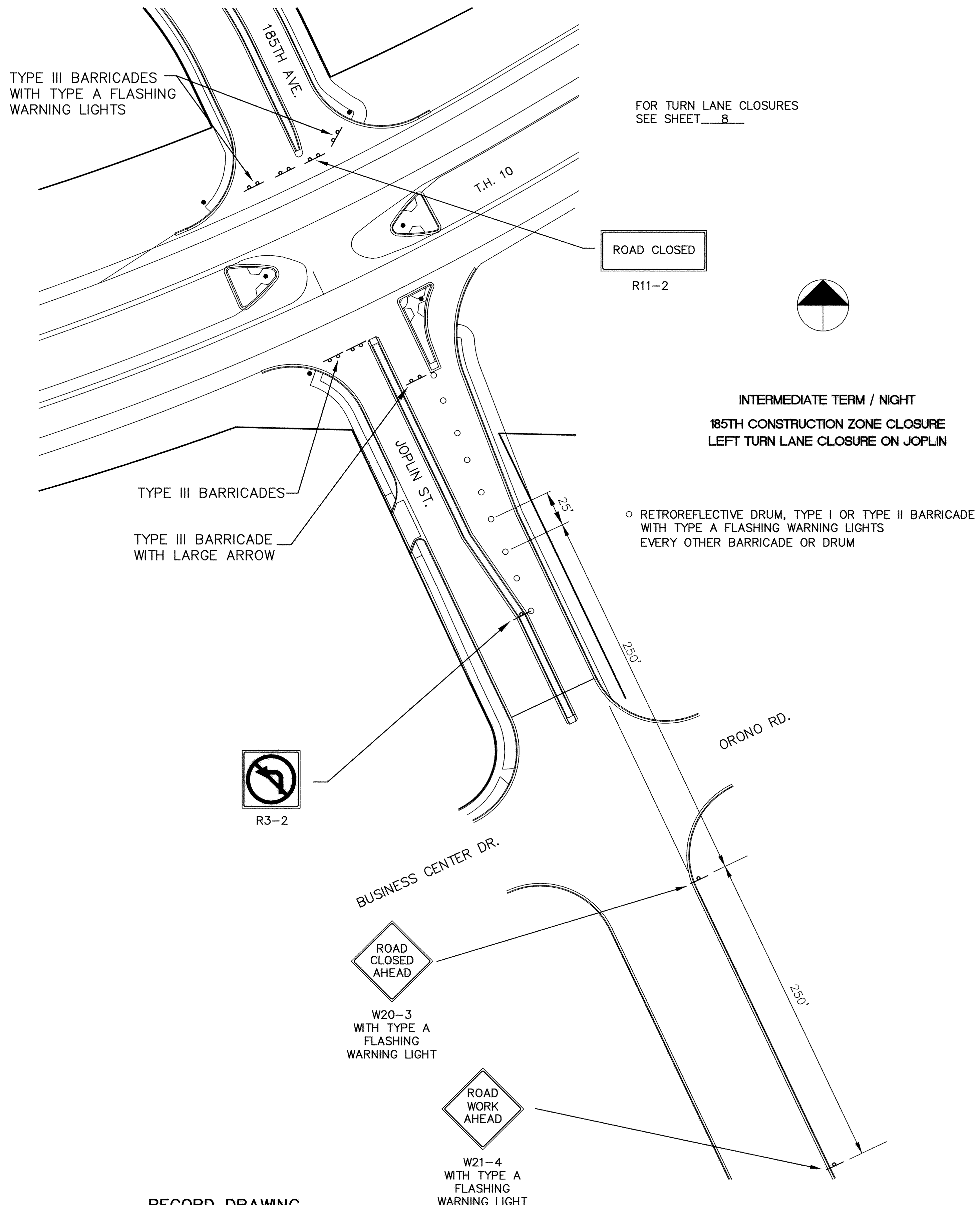

RECORD DRAWING
OCTOBER 1997

I HEREBY CERTIFY THAT THIS PLAN, SPECIFICATION, OR REPORT WAS PREPARED BY ME OR UNDER MY DIRECT SUPERVISION AND THAT I AM A DULY REGISTERED PROFESSIONAL ENGINEER UNDER THE LAWS OF THE STATE OF MINNESOTA.

Leroy M. Mauer

DATE 3/29/96 REG. NO. 15316

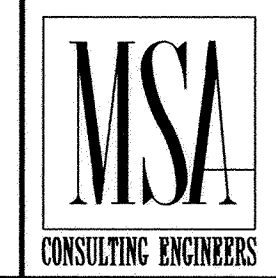

1326 ENERGY PARK DRIVE
ST. PAUL, MINNESOTA 55108
(612) 644-4389

5075 WAYZATA BLVD. SUITE #225
MINNEAPOLIS, MINNESOTA 55416
(612) 546-0432

REVISIONS	DATE	DESCRIPTION	DESIGNED - SF
	3/22/96	PER MNDOT REVIEW	CHECKED _____ DRAWN _____
			GRAPHIC SCALE 0 50 0 VERT. N/A

CITY OF ELK RIVER
TRUNK HIGHWAY 10
LANE CLOSURE SIGNING

S.P. 7102-87(TH 10)

DATE JAN 1996 SHEET 9 OF 41 SHEETS PROJECT NO. 230-277