

CITY OF ELK RIVER

SECTIONS 31 & 32 T33N R26W

GRADING, AGGREGATE BASE, BITUMINOUS, CONCRETE CURB & GUTTER, STORM SEWER, AND SIGNAL SYSTEM

185TH AVENUE

S.P. 7102-87 (TH 10)

BETWEEN T.H. 10 AND NAPLES ST.

GROSS LENGTH	1550	FEET	0.294	MILES
BRIDGE LENGTH	0	FEET	0	MILES
EXCEPTION LENGTH	0	FEET	0	MILES
NET LENGTH	1550	FEET	0.294	MILES

SCALES:

PLAN	PROFILE	CROSS SECTIONS
HORIZONTAL 1" = 20'	HORIZONTAL 1" = 20'	HORIZONTAL 1" = 10'
	VERTICAL 1" = 5'	VERTICAL 1" = 5'

INDEX OF SHEETS

- 1 TITLE SHEET WITH VICINITY MAP
- 2-3 ESTIMATED QUANTITIES AND SCHEDULES
- 4-5 TYPICAL STREET SECTIONS
- 6 SHEET INDEX MAP
- 7-10 DETOURS AND TEMPORARY LANE CLOSURES
- 11-12 ALIGNMENT PLANS
- 13-16 185TH AVENUE PLAN AND PROFILE SHEETS
- 17-19 STORM SEWER PLANS AND PROFILES
- 20-24 185TH AVENUE CROSS SECTIONS
- 25-29 ACCESS CLOSURE AND TURN LANE CONSTRUCTION ON T.H. 10
- 30-31 PERMANENT SIGNING AND STRIPING PLAN
- 32-37 TRAFFIC CONTROL SIGNAL SYSTEM
- 38-41 CONSTRUCTION DETAIL SHEETS

TOTAL NUMBER OF PLAN SHEETS - 41

RECORD DRAWING NOVEMBER 1997

I HEREBY CERTIFY THAT PLAN, SPECIFICATION, OR REPORT WAS PREPARED BY ME OR UNDER MY DIRECT SUPERVISION AND THAT I AM DULY REGISTERED PROFESSIONAL ENGINEER UNDER THE LAWS OF THE STATE OF MINNESOTA.

DATE 3/29/96 REG. NO. 15316

RECOMMENDED FOR APPROVAL Donald Rasmussen 4/23 19 96
TRANSPORTATION DISTRICT ENGINEER

RECOMMENDED FOR APPROVAL John J. Knutson 4/23 19 96
DISTRICT MATERIALS ENGINEER

RECOMMENDED FOR APPROVAL Tom Vandekerkhof 4-23 19 96
DISTRICT HYDRAULICS ENGINEER

RECOMMENDED FOR APPROVAL Ray D. Dufrenoy 4-23 19 96
DISTRICT TRAFFIC ENGINEER

RECOMMENDED FOR APPROVAL Allen P. Nyquist 7-9- 19 96
STATE PRE-LETTING ENGINEER

RIGHT OF WAY APPROVAL Ray Rasmussen 9-9 19 96
STATE RIGHT OF WAY ENGINEER

APPROVED Donald J. Rasmussen 9-10 19 96
STATE DESIGN ENGINEER

I HEREBY CERTIFY THAT THE FINAL FIELD REVISIONS, IF ANY, OF THIS PLAN WERE MADE BY ME OR UNDER MY DIRECT SUPERVISION AND THAT I AM A DULY REGISTERED PROFESSIONAL ENGINEER UNDER THE LAWS OF THE STATE OF MINNESOTA.

DATE 3/29/96 REG. NO. 15316

SHEET 1 OF 41

S.P. 7102-87 (TH 10)

PLAN SYMBOLS

SECTION LINE	---	TREES	
QUARTER LINE	- - - -	BRUSH OR SHRUBS	
SIXTEENTH LINE	- · - · - ·	HEDGE	
RIGHT OF WAY	=====	CONIFERS	
CENTER LINE	-----	SWAMP	
FENCE LINE	- x - x -	MAILBOX	
RIVER OR CREEK		SIGN	
LAKE OR POND			
CULVERT			
BRIDGE			
RETAINING WALL			

UTILITIES SYMBOLS

SANITARY SEWER		HYDRANT	
STORM SEWER		POWER OR TELEPHONE POLE	
WATERMAIN		LIGHT POLE	
GAS LINE		ANCHOR	
POWER LINE		SOIL BORING	
MANHOLE			
CATCH BASIN			
VALVE			

PRESENT ADT (1995) _____ PROJ. ADT (2015) 8,400

FUNCTIONAL CLASSIFICATION HIGH DENSITY COLLECTOR

0+00 TO 12+00

NO. OF TRAFFIC LANES 4 NO. OF PARKING LANES 0

SHOULDER WIDTH: N/A

12+00 TO 15+50

NO. OF TRAFFIC LANES 2 NO. OF PARKING LANES 0

SHOULDER WIDTH: N/A

PAVEMENT DESIGN: 9 TON

SOIL FACTOR 50 PROJ. HCDT (2015) 554

OR

R-VALUE N/A N18 FACTOR N/A

DESIGN SPEED 30 MPH

DESIGN SPEED NOT ACHIEVED AT:

STA. _____ TO STA. _____ (MPH _____)

STOPPING SITE DISTANCE BASED ON:

3.5' HEIGHT OF EYE

0.5' HEIGHT OF OBJECT

GOVERNING SPECIFICATIONS

THE 1988 EDITION OF THE MINNESOTA DEPARTMENT OF TRANSPORTATION "STANDARD SPECIFICATION FOR CONSTRUCTION" TOGETHER WITH "SUPPLEMENTAL SPECIFICATIONS" DATED MAY 2, 1994, SHALL GOVERN.

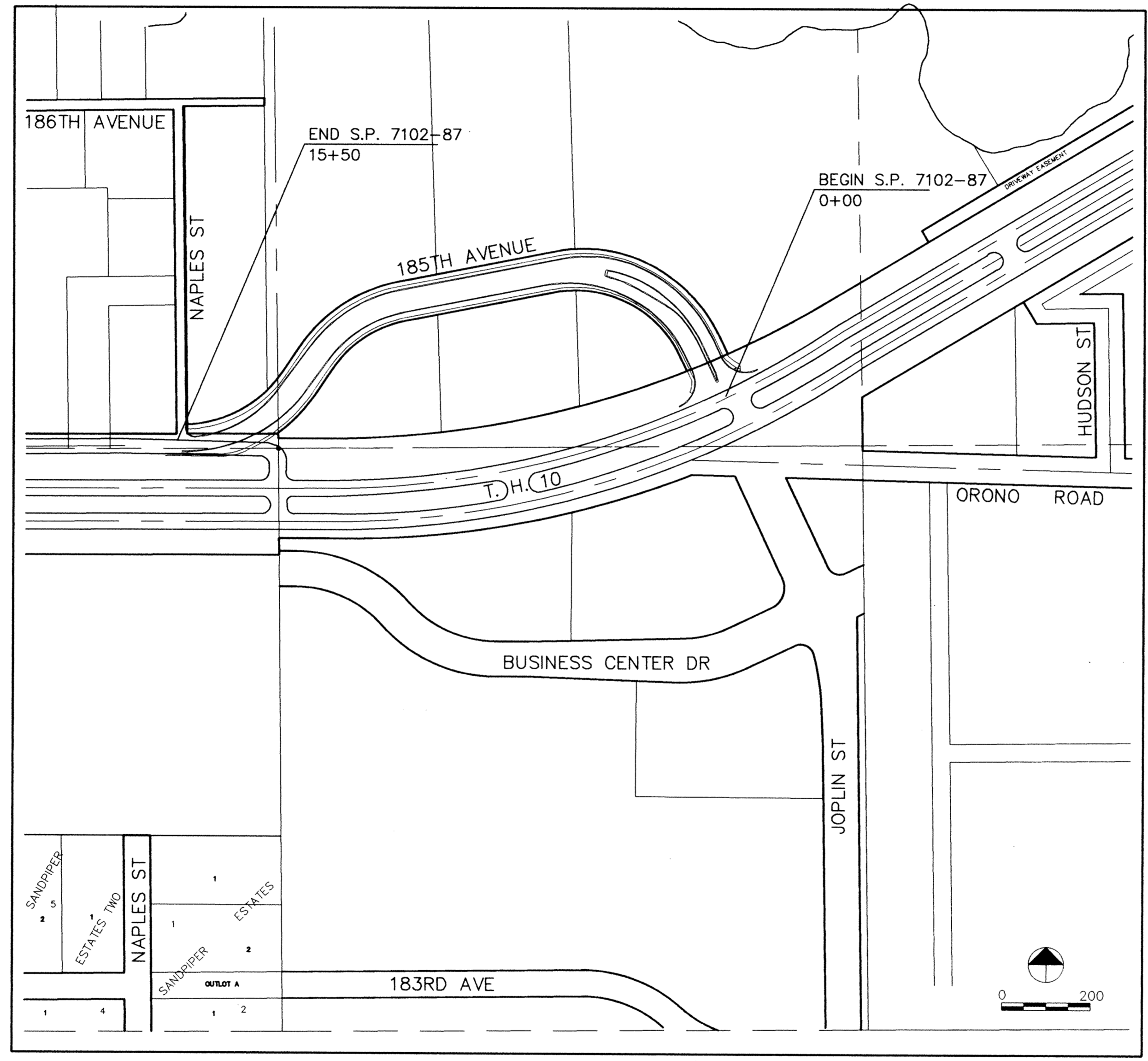

1326 ENERGY PARK DRIVE
ST. PAUL, MINNESOTA 55108
(612) 644-4389

5075 WAYZATA BLVD. SUITE #225
MINNEAPOLIS, MINNESOTA 55416
(612) 546-0432

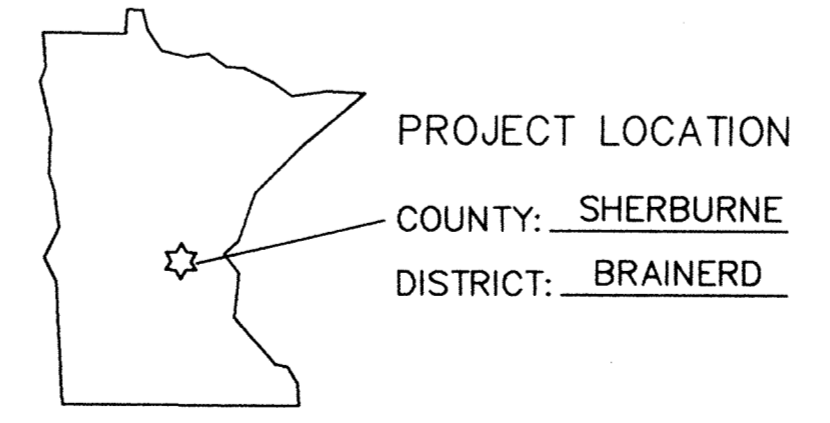

AGREEMENT NO. 74958
CITY OF ELK RIVER
S.P. 7102-87 (TH 10-3)
STATE FUND
BRAINERD DISTRICT 3

REVISED PER MNDOT REVIEW 3/22/96

1246