

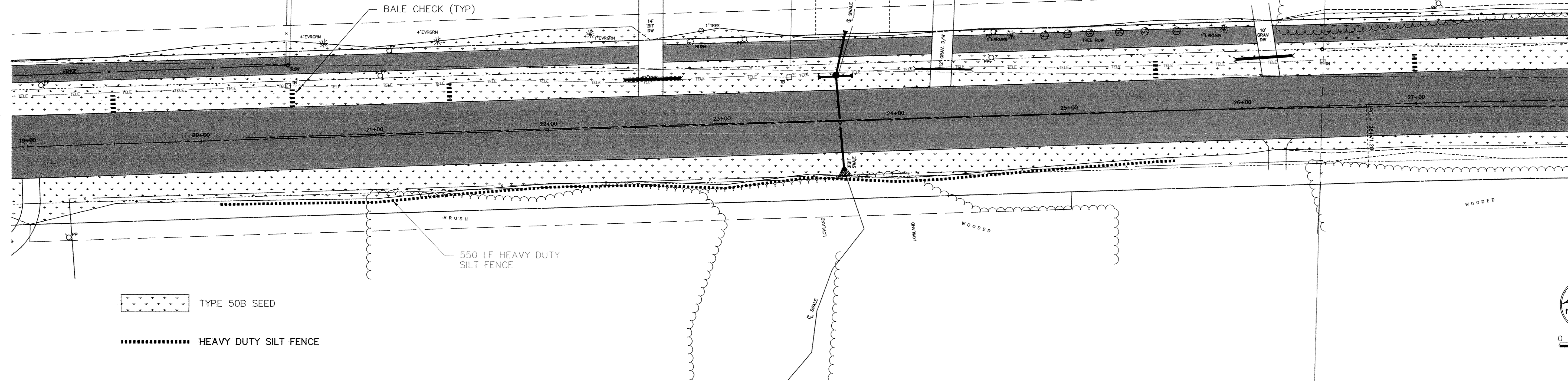

# 175TH AVENUE



-  TYPE 50B SEED
-  HEAVY DUTY SILT FENCE

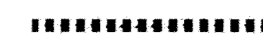
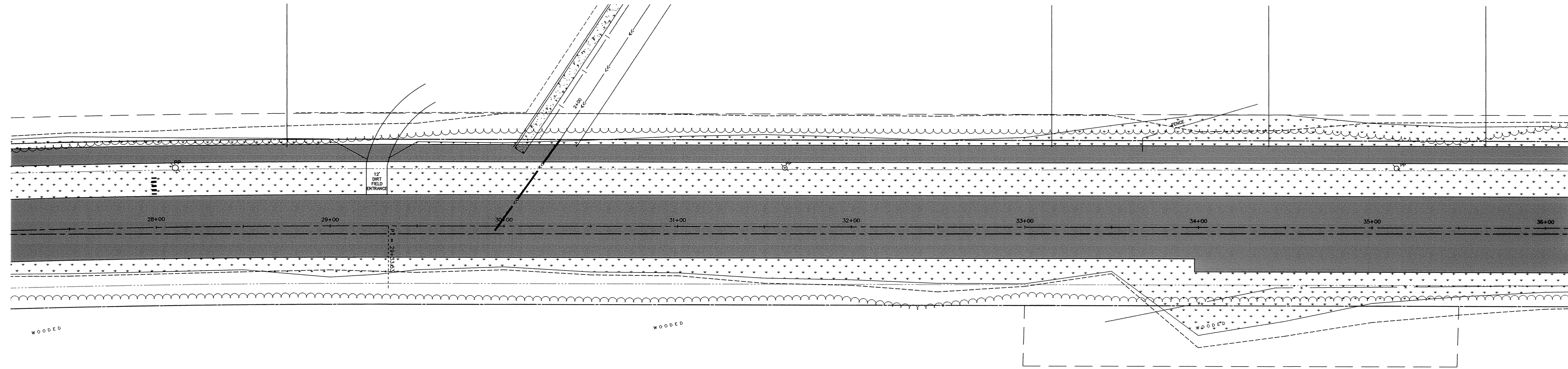
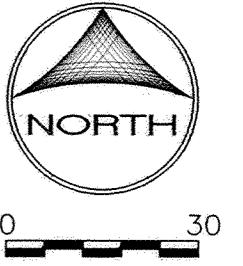

Xref: BASE.DWG  
 DESIGNED BY: KJT DRAWN BY: RKM  
 APPROVED: TJM JOB NUMBER 806550J  
 CAD DATE: August 23, 2001 11:56:18 a.m.  
 CAD FILE: 806550J\MISC\806550-EC2.DWG

I HEREBY CERTIFY THAT THIS PLAN, SPECIFICATION, OR REPORT WAS PREPARED BY ME OR UNDER MY DIRECT SUPERVISION AND THAT I AM A DULY LICENSED PROFESSIONAL ENGINEER UNDER THE LAWS OF THE STATE OF MINNESOTA.  
 DATE \_\_\_\_\_  
 TERRY J. MAURER LIC. 15316

NO.	DATE	BY	REVISION DESCRIPTION



Howard R. Green Company  
 CONSULTING ENGINEERS  
 1326 ENERGY PARK DRIVE  
 ST. PAUL, MINNESOTA 55108  
 (651) 644-4389

175TH AVENUE  
 CITY OF ELK RIVER  
 175TH AVENUE

S.P. 204-111-04  
 EROSION CONTROL AND TURF ESTABLISHMENT  
 19+00 TO 36+00

SHEET NO.  
**34**