

SDQC PRODUCTS • NEA/HORNE, MINNESOTA  
 REVISION BY PART NUMBER 806550J  
 DRAWING DATE OF PRINT ON THIS LINE

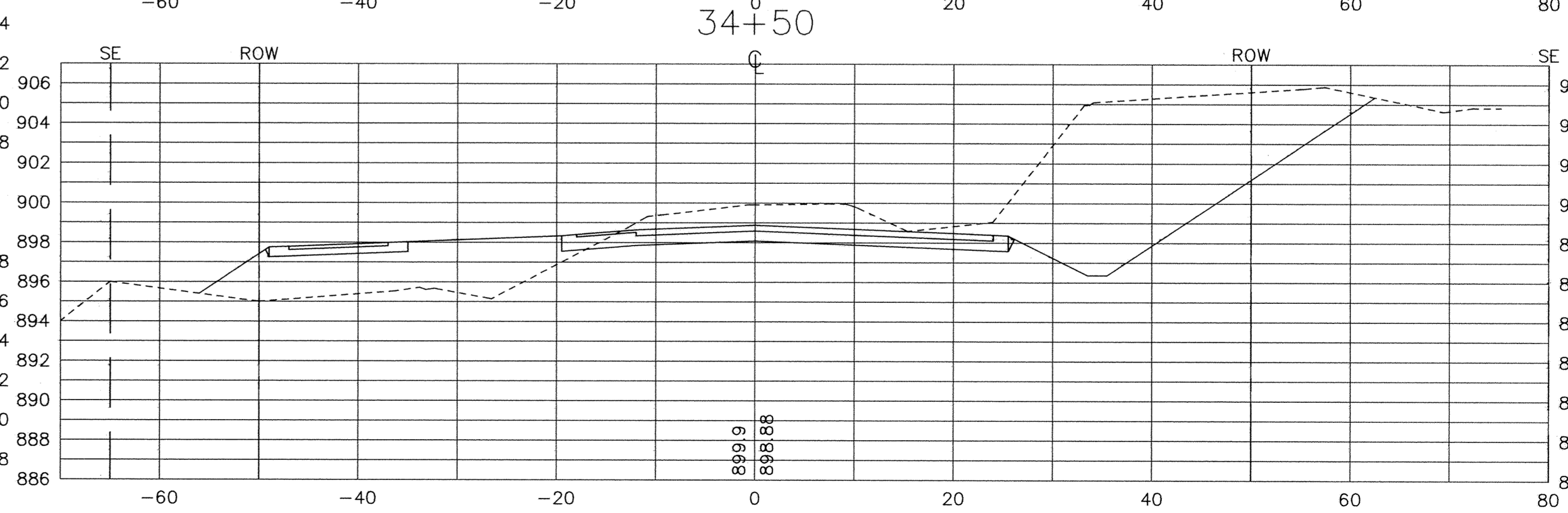
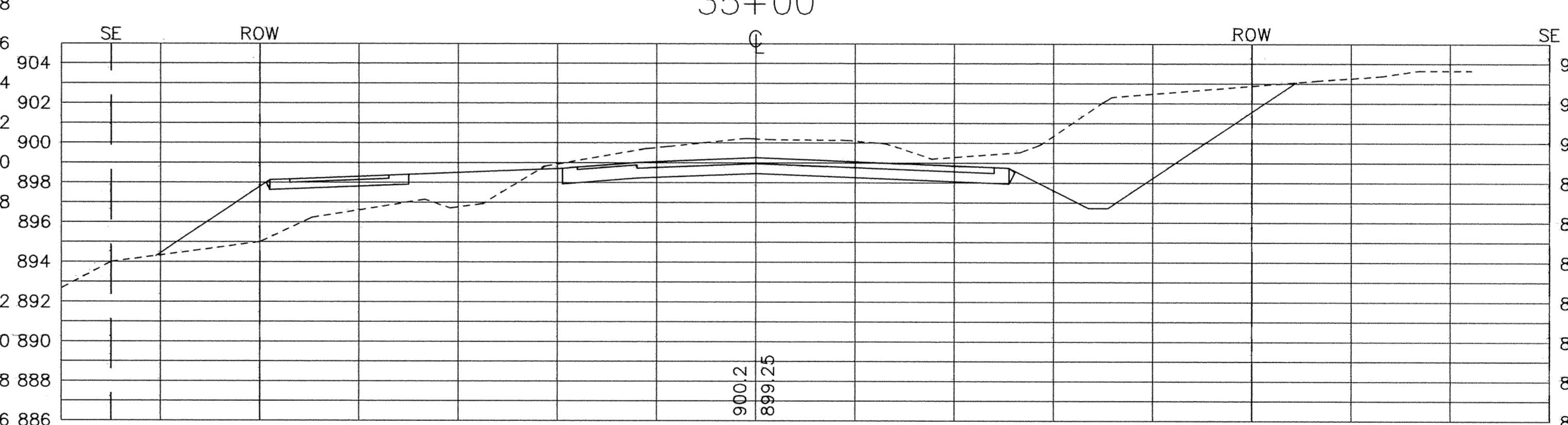
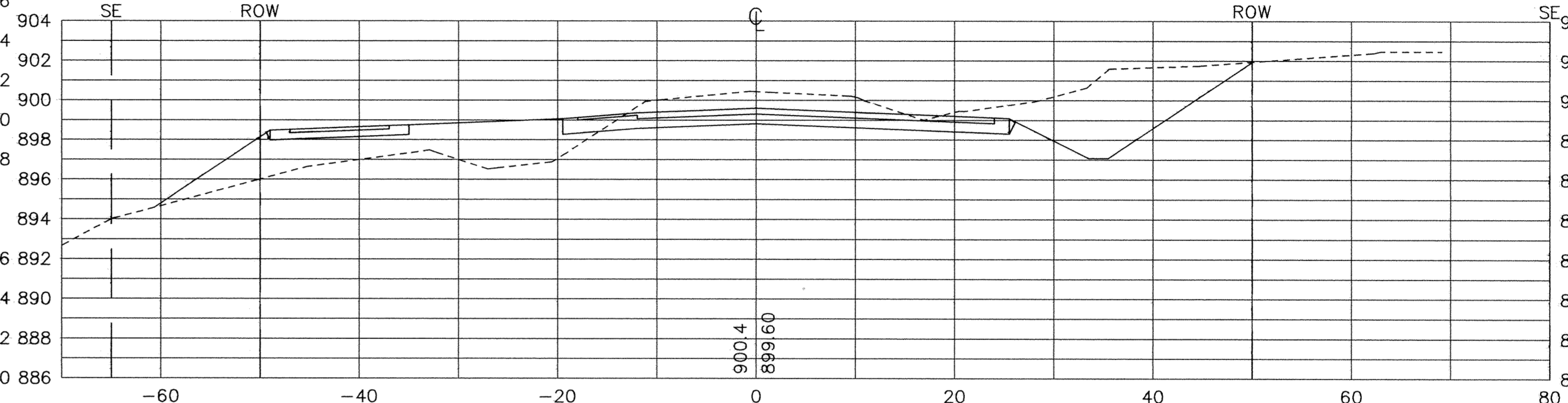
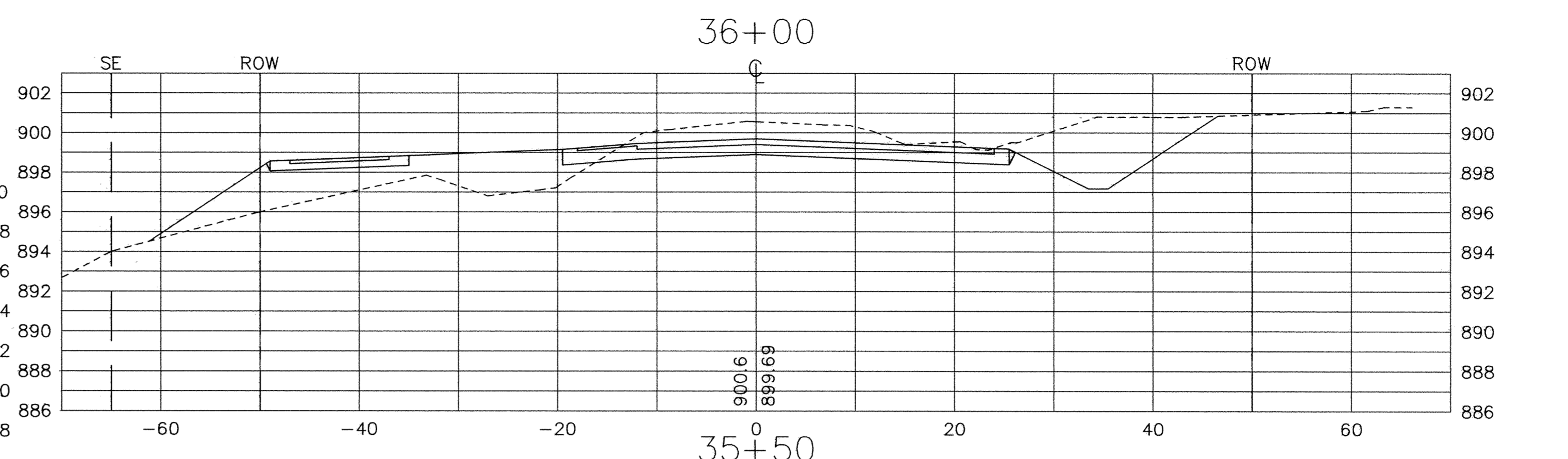
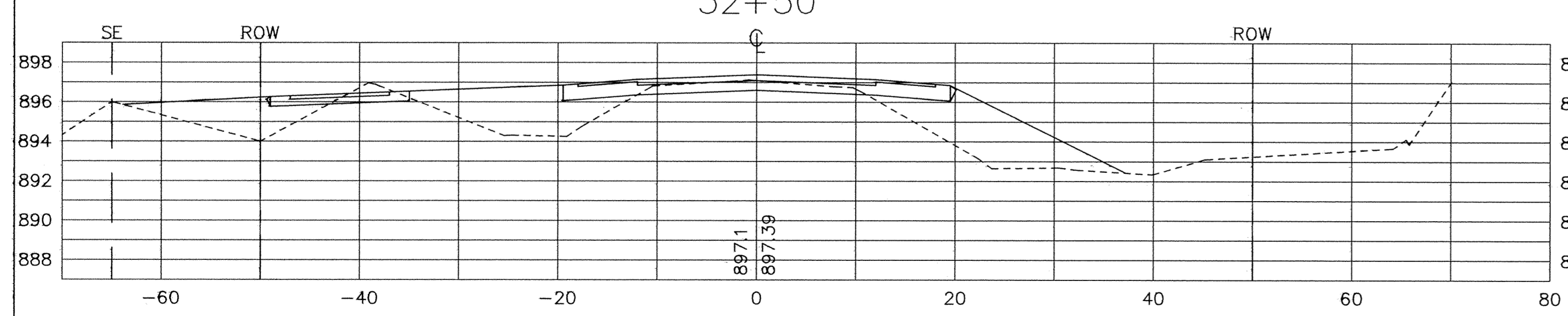
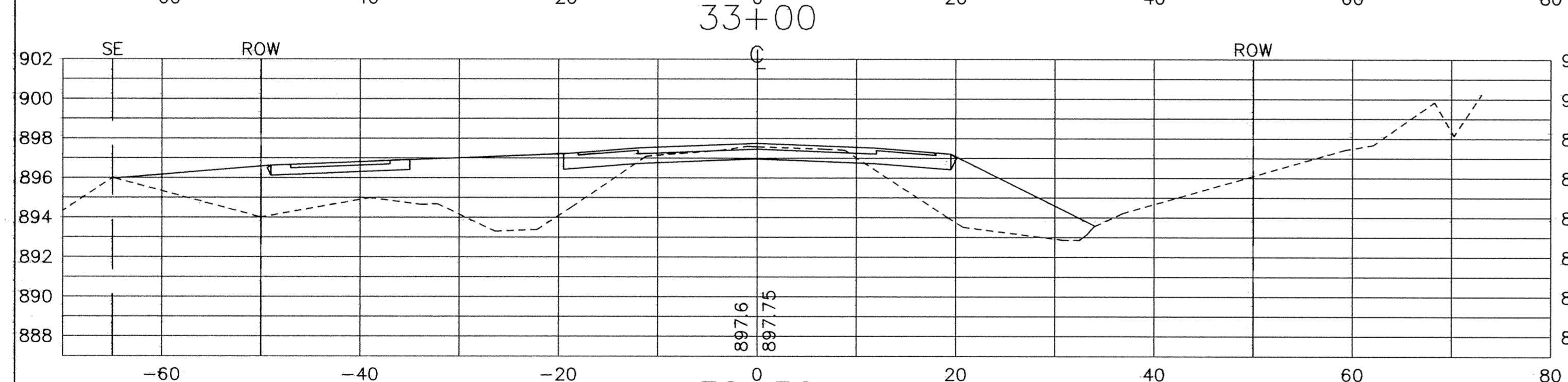
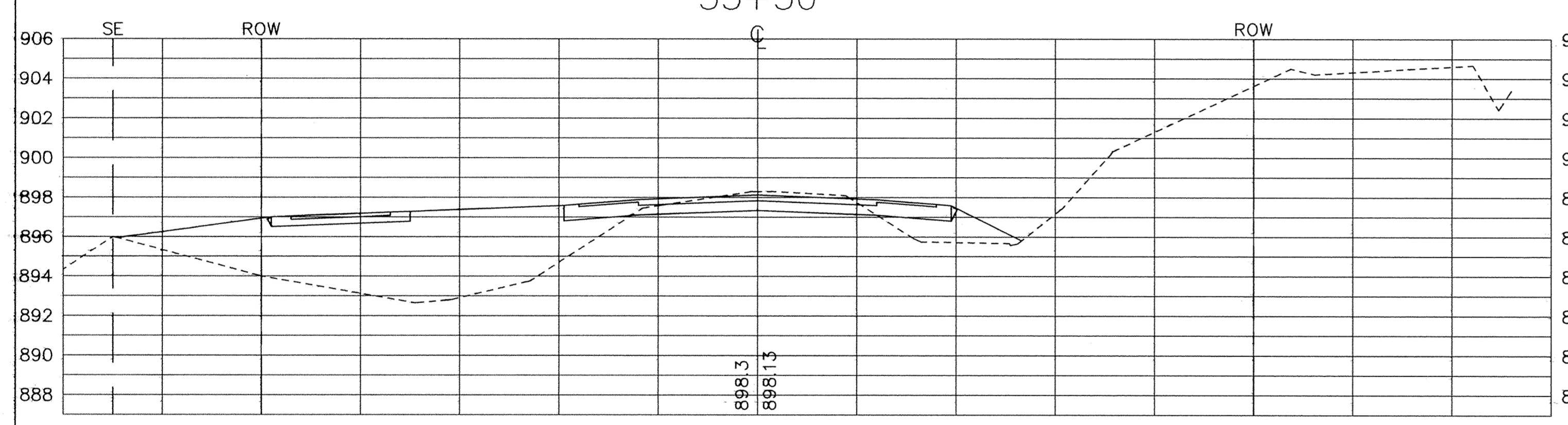
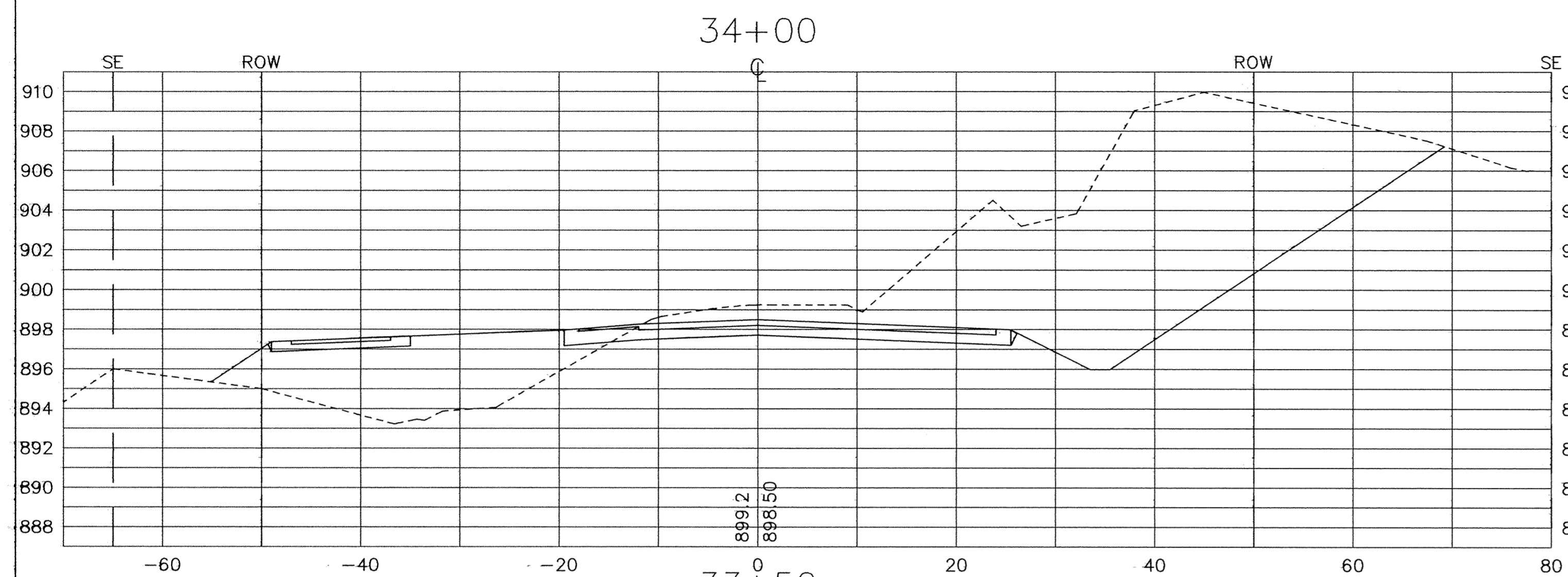
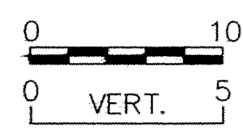

DESIGNED BY: KJT    DRAWN BY: RKM  
 APPROVED: TJM    JOB NUMBER: 806550J  
 CAD DATE: April 18, 2002 5:00:28 p.m.  
 CAD FILE: 806550J\X08.DWG

I HEREBY CERTIFY THAT THIS PLAN, SPECIFICATION,  
 OR REPORT WAS PREPARED BY ME OR UNDER MY DIRECT  
 SUPERVISION AND THAT I AM A DULY LICENSED  
 PROFESSIONAL ENGINEER UNDER THE LAWS OF THE  
 STATE OF MINNESOTA.  
 DATE: \_\_\_\_\_  
 TERRY J. MAURER    LIC. 15316

NO.	DATE	BY	REVISION DESCRIPTION
1	7/9/02	EY	SECTION REVISIONS

1326 ENERGY PARK DRIVE  
 ST. PAUL, MINNESOTA 55108  
 (651) 644-4389  
**Howard R. Green Company**  
 CONSULTING ENGINEERS

175TH AVENUE  
 CITY OF ELK RIVER  
 175TH AVENUE

CROSS SECTIONS  
 SP. 204-111-04  
 32+50 TO 36+00

SHEET NO.  
**26**