

171ST AVENUE

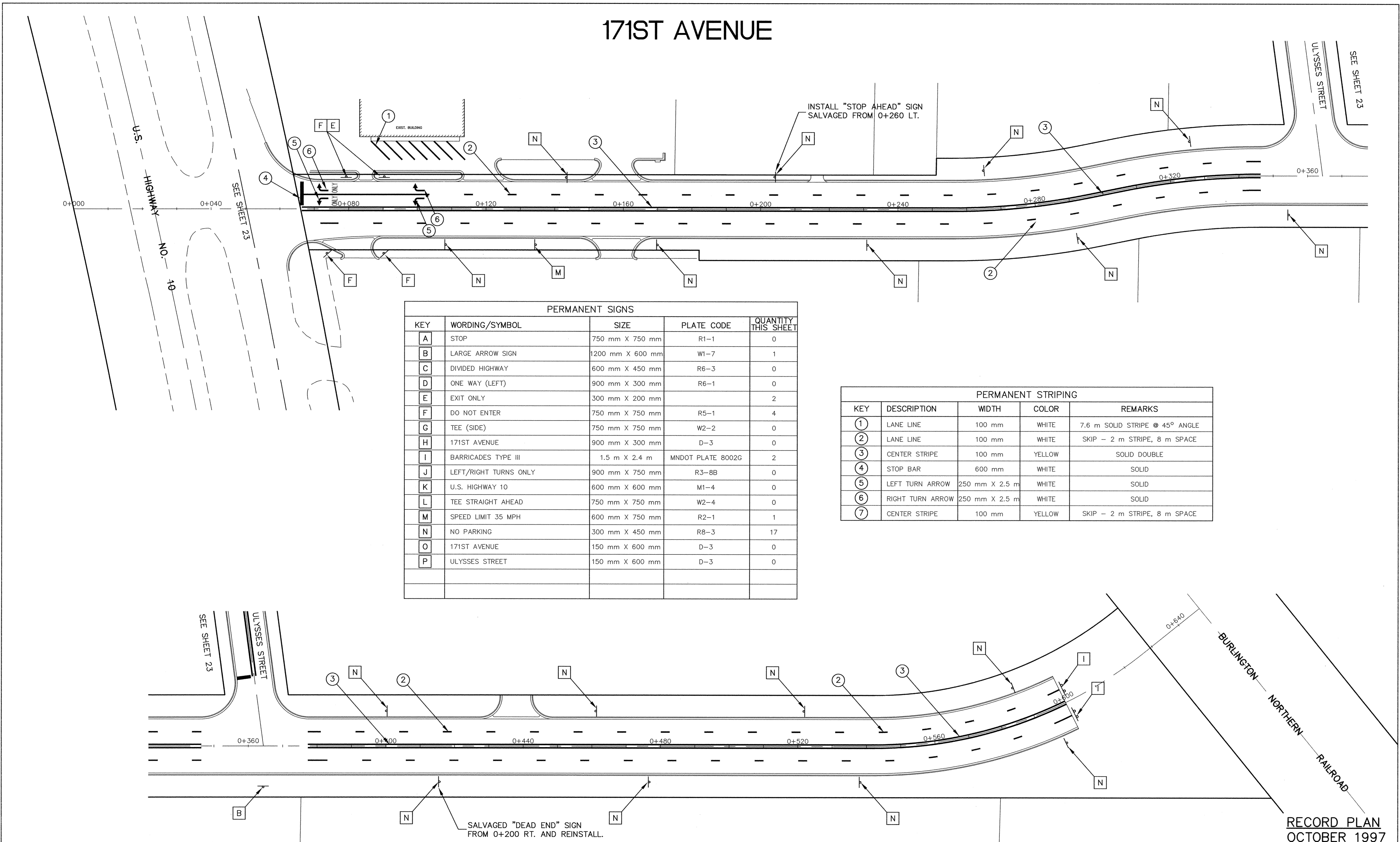

| PERMANENT SIGNS | | | | |
|-----------------|-----------------------|------------------|-------------------|---------------------|
| KEY | WORDING/SYMBOL | SIZE | PLATE CODE | QUANTITY THIS SHEET |
| A | STOP | 750 mm X 750 mm | R1-1 | 0 |
| B | LARGE ARROW SIGN | 1200 mm X 600 mm | W1-7 | 1 |
| C | DIVIDED HIGHWAY | 600 mm X 450 mm | R6-3 | 0 |
| D | ONE WAY (LEFT) | 900 mm X 300 mm | R6-1 | 0 |
| E | EXIT ONLY | 300 mm X 200 mm | | 2 |
| F | DO NOT ENTER | 750 mm X 750 mm | R5-1 | 4 |
| G | TEE (SIDE) | 750 mm X 750 mm | W2-2 | 0 |
| H | 171ST AVENUE | 900 mm X 300 mm | D-3 | 0 |
| I | BARRICADES TYPE III | 1.5 m X 2.4 m | MNDOT PLATE 8002G | 2 |
| J | LEFT/RIGHT TURNS ONLY | 900 mm X 750 mm | R3-8B | 0 |
| K | U.S. HIGHWAY 10 | 600 mm X 600 mm | M1-4 | 0 |
| L | TEE STRAIGHT AHEAD | 750 mm X 750 mm | W2-4 | 0 |
| M | SPEED LIMIT 35 MPH | 600 mm X 750 mm | R2-1 | 1 |
| N | NO PARKING | 300 mm X 450 mm | R8-3 | 17 |
| O | 171ST AVENUE | 150 mm X 600 mm | D-3 | 0 |
| P | ULYSSES STREET | 150 mm X 600 mm | D-3 | 0 |

| PERMANENT STRIPING | | | | |
|--------------------|------------------|----------------|--------|--------------------------------|
| KEY | DESCRIPTION | WIDTH | COLOR | REMARKS |
| ① | LANE LINE | 100 mm | WHITE | 7.6 m SOLID STRIPE @ 45° ANGLE |
| ② | LANE LINE | 100 mm | WHITE | SKIP - 2 m STRIPE, 8 m SPACE |
| ③ | CENTER STRIPE | 100 mm | YELLOW | SOLID DOUBLE |
| ④ | STOP BAR | 600 mm | WHITE | SOLID |
| ⑤ | LEFT TURN ARROW | 250 mm X 2.5 m | WHITE | SOLID |
| ⑥ | RIGHT TURN ARROW | 250 mm X 2.5 m | WHITE | SOLID |
| ⑦ | CENTER STRIPE | 100 mm | YELLOW | SKIP - 2 m STRIPE, 8 m SPACE |

SALVAGED "DEAD END" SIGN FROM 0+200 RT. AND REINSTALL.

RECORD PLAN
OCTOBER 1997

I HEREBY CERTIFY THAT THIS PLAN, SPECIFICATION, OR REPORT WAS PREPARED BY ME OR UNDER MY DIRECT SUPERVISION AND THAT I AM A DULY REGISTERED PROFESSIONAL ENGINEER UNDER THE LAWS OF THE STATE OF MINNESOTA.

Lynn M. Munn
DATE 7/23/96 REG. NO. 15316



1326 ENERGY PARK DRIVE
ST. PAUL, MINNESOTA 55108
(612) 644-4389

| REVISIONS | DATE | DESCRIPTION | DESIGN | DRAWN |
|-----------|------|-------------|--------|-------|
| | | | | |

| GRAPHIC SCALES | |
|----------------|--------------|
| 0 | HORIZ (M) 20 |
| 0 | VERT (M) 2 |
| 0 | 1:50 |

CITY OF ELK RIVER
171ST AVENUE
SIGNING AND STRIPING PLAN
171ST AVENUE / T.H. 10 / ULYSSES STREET
S.A.P. 204-132-01(171ST AVE.) S.A.P. 204-010-04(TH 10)

DATE JULY 1996 SHEET 22 OF 25 SHEETS PROJECT NO. 230-313-20