

# SCHOOL STREET

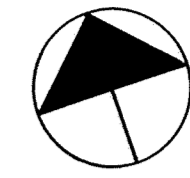

REMOVE PLUG AND CONNECT TO EXISTING WATERMAIN

EXISTING SANITARY SEWER  
EXISTING 6" WATERMAIN

6" VALVE

20' PERMANENT EASEMENT

EXISTING CONCRETE CURB & GUTTER

SEE SHEET 2

S.B.  
E. T. H. 169

NOTE 1. CONTRACTOR SHALL CONTACT UTILITY COMPANIES FOR LOCATION OF UNDERGROUND UTILITIES PRIOR TO CONSTRUCTION.

2. EXISTING WATERMAIN LOCATION IS APPROXIMATE. CONTRACTOR TO EXCAVATE AND VERIFY LOCATION PRIOR TO BEGINNING CONSTRUCTION. THIS WORK SHALL BE INCIDENTAL TO THE PROJECT.

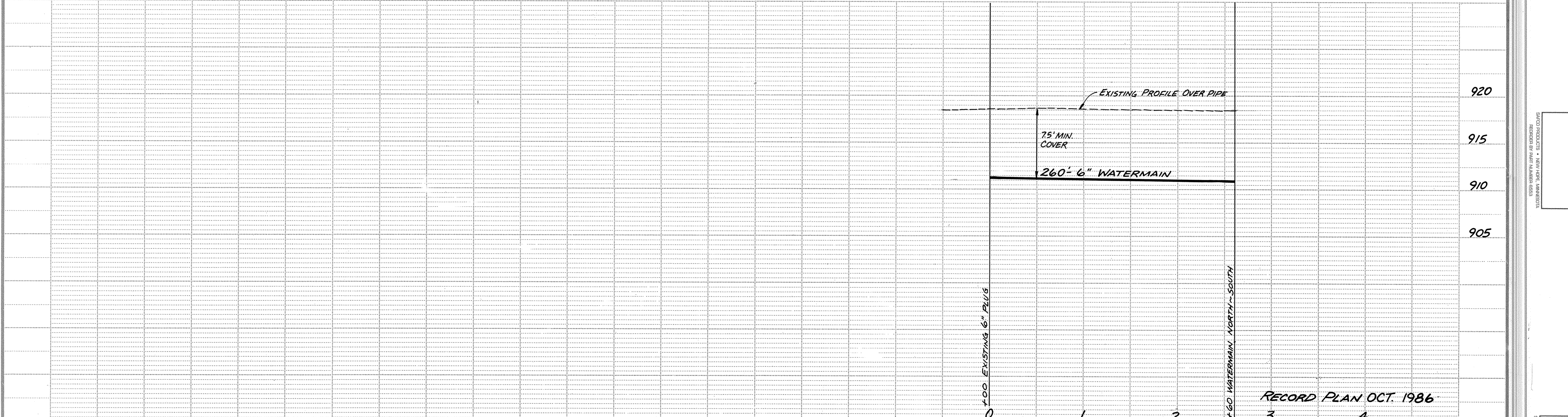

**MSA** CONSULTING ENGINEERS  
**Maier Stewart & Associates Inc.**  
 480 CEDAR STREET (612)227-9475 ST. PAUL, MINNESOTA 55101

REVISIONS	DATE	DESCRIPTION	DESIGNED <u>TJM</u>
			CHECKED <u> </u>
			DRAWN <u>MRJ</u>
			GRAPHIC SCALE
			0 HORIZ. 50
			0 VERT. 5

**CITY OF ELK RIVER**  
**WATERMAIN EXTENSION**  
**SCHOOL STREET**  
 DATE FEB 1986 SHEET 3 OF 7 SHEETS PROJECT NO. 230-001

DRAWING NUMBER

DRAWING NUMBER

DRAWING NUMBER

DRAWING NUMBER  
 169THWY 86  
 3