

# STATE HIGHWAY NO. 169

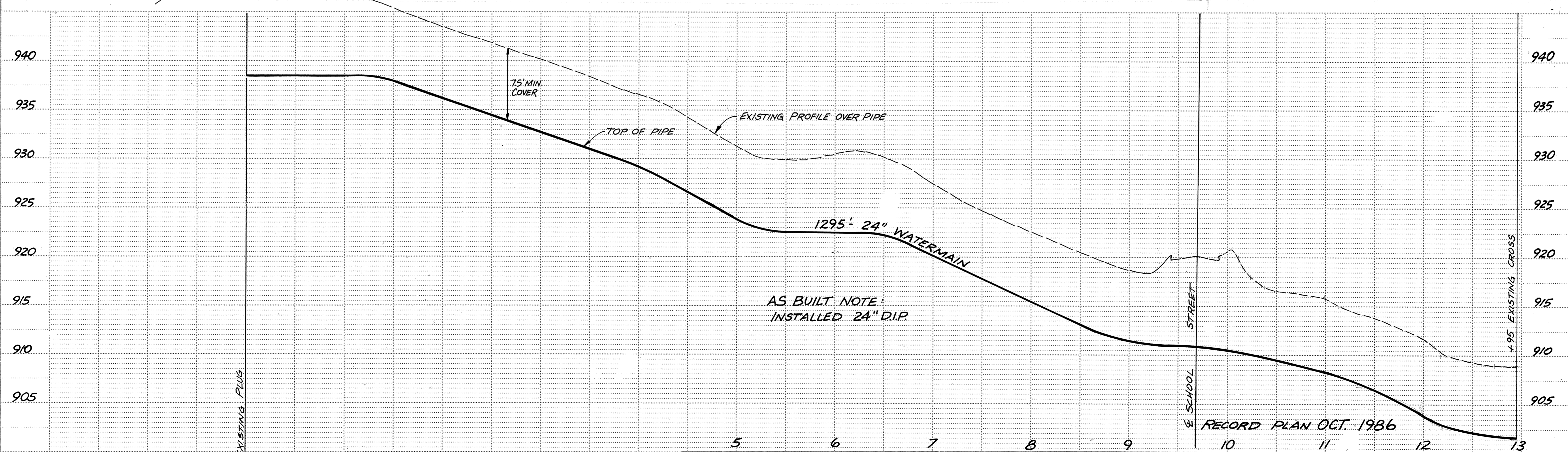

E. T. H. 169 S. B.

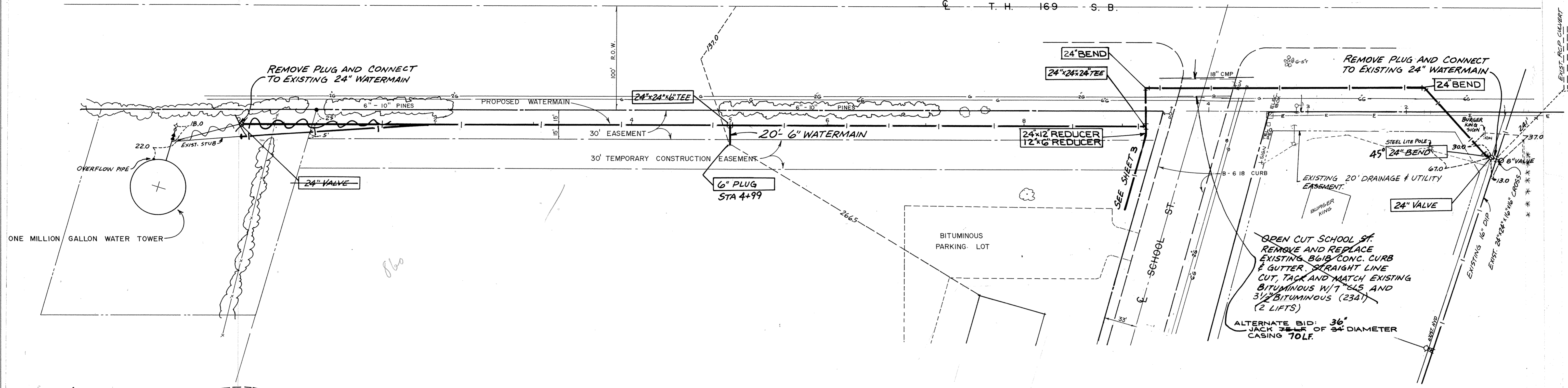

**W&A** CONSULTING ENGINEERS  
**Maier Stewart & Associates Inc.**  
 480 CEDAR STREET (612)227-9475 ST. PAUL, MINNESOTA 55101

DATE	DESCRIPTION

DESIGNED *JJM*  
 CHECKED  
 DRAWN *ARJ*  
 GRAPHIC SCALE  
 0 HORIZ. 50  
 0 VERT. 5

**CITY OF ELK RIVER**  
**WATERMAIN EXTENSION**  
**STATE HIGHWAY No. 169**  
 DATE FEB 1986 SHEET 2 OF 7 SHEETS PROJECT NO. 230-001

STATE PROJECTS - NEW YORK, MINNESOTA  
 REPRODUCED BY PRINT NUMBER 6533  
 STATE PROJECTS - NEW YORK, MINNESOTA  
 REPRODUCED BY PRINT NUMBER 6533  
 STATE PROJECTS - NEW YORK, MINNESOTA  
 REPRODUCED BY PRINT NUMBER 6533  
 STATE PROJECTS - NEW YORK, MINNESOTA  
 REPRODUCED BY PRINT NUMBER 6533