

CVD LIFE: 8188801/AR-P/11/C/C2/C2-E01 DMC (ELECTRICITY)
 CVD DATE: February 11, 2004 11:43:04 AM
 APPROVED BY: APPROVED BY JOB NUMBER: 8188801
 DESIGNED BY: DESIGNED BY DRAWN BY: BKM

PRINTED NAME: KRISTINA L THOMPSON PLSNO: 45320
 SIGNATURE: [Signature] DATE: 1/17/04
 THE STATE OF THE STATE OF MINNESOTA
 THAT I AM A duly licensed PROFESSIONAL ENGINEER UNDER
 AND SUPERVISED BY ME OR UNDER MY DIRECT SUPERVISION AND
 I HEREBY CERTIFY THAT THIS PLAN IS A REPRESENTATION OF MY BEST

NO	DATE	BY	REVISION DESCRIPTION

HOWARD B GREEN COMPANY
 (612) 844-4388
 21 PAUL MINNESOTA 55108
 1358 EMERSON PARK DRIVE

CITY OF EFK RIVER
 5003 STREET IMPROVEMENTS

01111 AVENUE
 EXISTING TOPOGRAPHY AND REMOVALS
 0+00 TO 4+00

8
 SHEET NO.

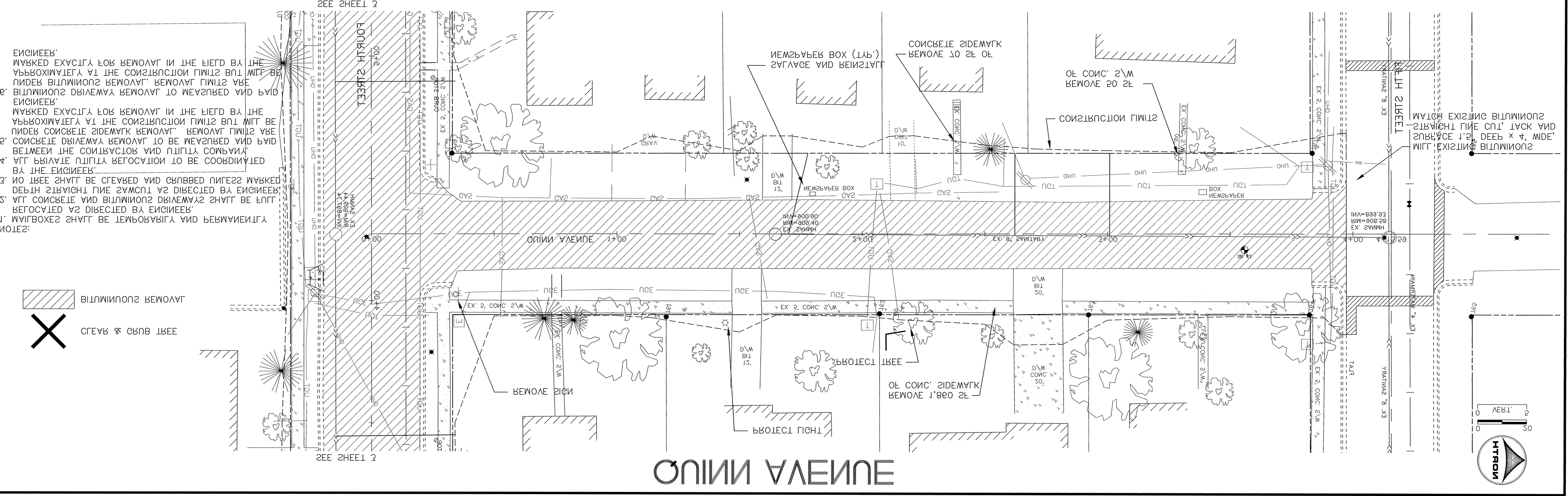
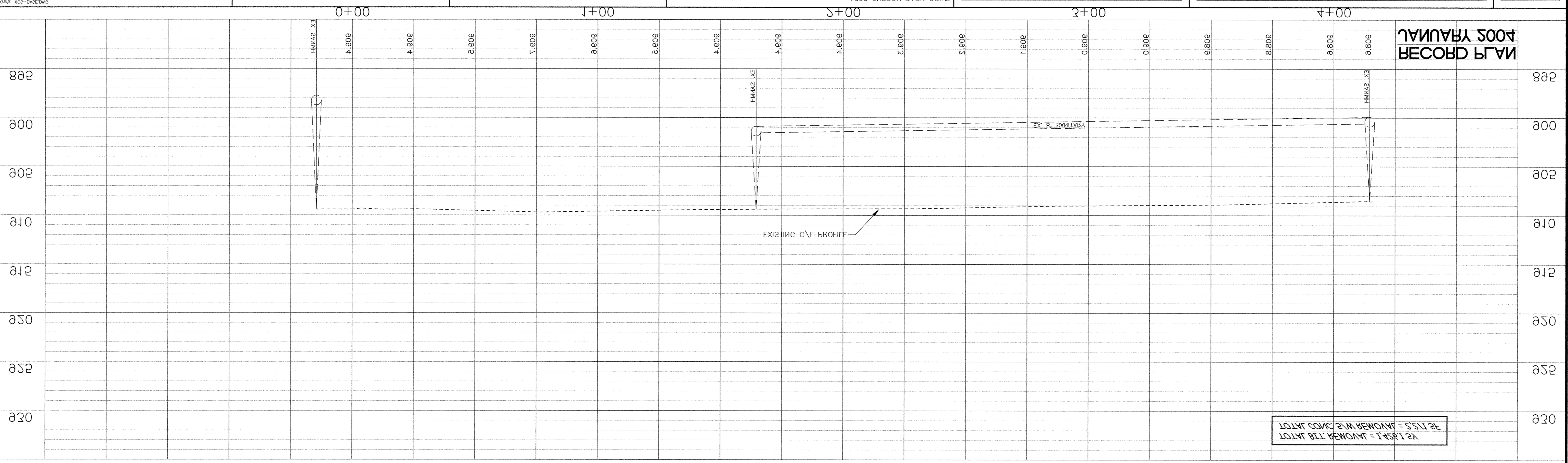

- ENGINEER'S MARKED EXACTLY FOR REMOVAL IN THE FIELD BY THE APPROXIMATELY AT THE CONSTRUCTION LIMITS BUT WILL BE UNDER BITUMINOUS REMOVAL. REMOVAL LIMITS ARE BITUMINOUS DRIVEWAY REMOVAL TO MEASURED AND PAID ENGINEER'S MARKED EXACTLY FOR REMOVAL IN THE FIELD BY THE APPROXIMATELY AT THE CONSTRUCTION LIMITS BUT WILL BE UNDER CONCRETE SIDEWALK REMOVAL. REMOVAL LIMITS ARE CONCRETE DRIVEWAY REMOVAL TO BE MEASURED AND PAID BETWEEN THE CONTRACTOR AND UTILTY COMPANY. ALL PRIVATE UTILITY RELOCATION TO BE COORDINATED BY THE ENGINEER'S. NO TREE SHALL BE CROWNED AND CROWNED HEIGHTS MARKED DEPTH STRAIGHT LINE SURFACE AS DIRECTED BY ENGINEER'S. ALL CONCRETE AND BITUMINOUS DRIVEWAYS SHALL BE FULLY RELOCATED AS DIRECTED BY ENGINEER'S. MAINTENANCE SHALL BE TEMPORARILY AND PERMANENTLY NOTES:

BITUMINOUS REMOVAL
 CROWN & CROWN TREE

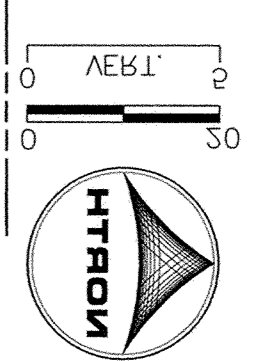

DRAWING NUMBER: 8188801/AR-P/11/C/C2/C2-E01 DMC
 PROJECT: 5003 STREET IMPROVEMENTS
 SHEET NO.: 8
 CITY OF EFK RIVER
 HOWARD B GREEN COMPANY
 (612) 844-4388
 21 PAUL MINNESOTA 55108
 1358 EMERSON PARK DRIVE